

Drilling of Sand
 Base Subgrade, Item 115
 U.S. 2391+00 - 2400+00
 S.B. 2391+00 - 2400+00
 N.B. 2391+00 - 2400+00

Triple Cable Guard Rail w/
 Side Posts, Item 622
 U.S. 2391+00 - 2392+00

Bituminous Concrete Curb
 Item 605
 U.S. 2391+00 - 2392+00

Demolition and Dispose of
 Old Roadway, Item 601
 U.S. 2391+00 - 2400+00
 S.B. 2391+00 - 2400+00

Standard Steel Beam Guard
 Rail w/ Steel Posts, Item 602
 U.S. 2400+00 - 2401+00
 S.B. 2400+00 - 2401+00

Property Line Fence
 w/ Steel Posts, Item 603
 U.S. 2391+00 - 2400+00
 S.B. 2391+00 - 2400+00

Sub Base of Sand, Item 115
 S.B. 2401+00 - 2402+00
 U.S. 2401+00 - 2402+00

* STAGE 2 CONSTRUCTION

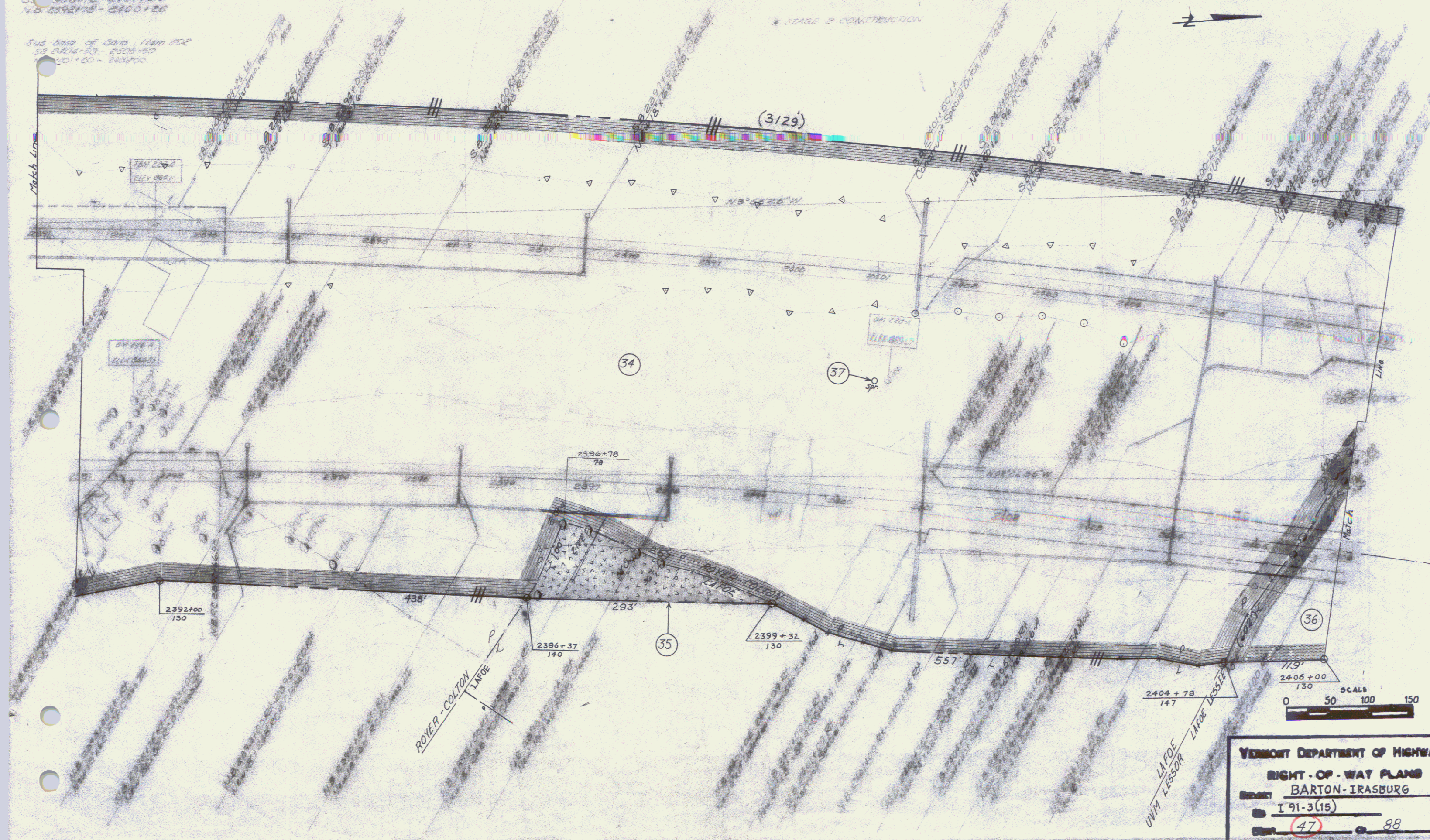

VERMONT DEPARTMENT OF HIGHWAY
RIGHT-OF-WAY PLANS
BARTON-IRASBURG
 I 91-3(15)
 47 88