

Work Excavation Item 17
S.B. 2362+05 - 2367+25
S.B. 2368+05 - 2370+00

* Three Cable Guard Rail w/
Steel Posts Item 582
S.B. 2360+00 - 2367+00 RT
" 2360+50 - 2369+00 LT
N.B. 2367+76 - 2368+00 RT
" 2367+80 - 2368+00 LT
" 2367+84 - 2368+00 RT

* STAGE 2 CONSTRUCTION

S.B. 2361+00 - 2366+00 RT
S.B. 2361+00 - 2366+00 LT

N.B. 2367+00 - 2367+25 RT
N.B. 2367+00 - 2367+00 LT
S.B. 2367+00 - 2367+00 LT

End Relinquishment No. II
Begin Maint. Areas Area No. 4
TH 29 30+27E (678')

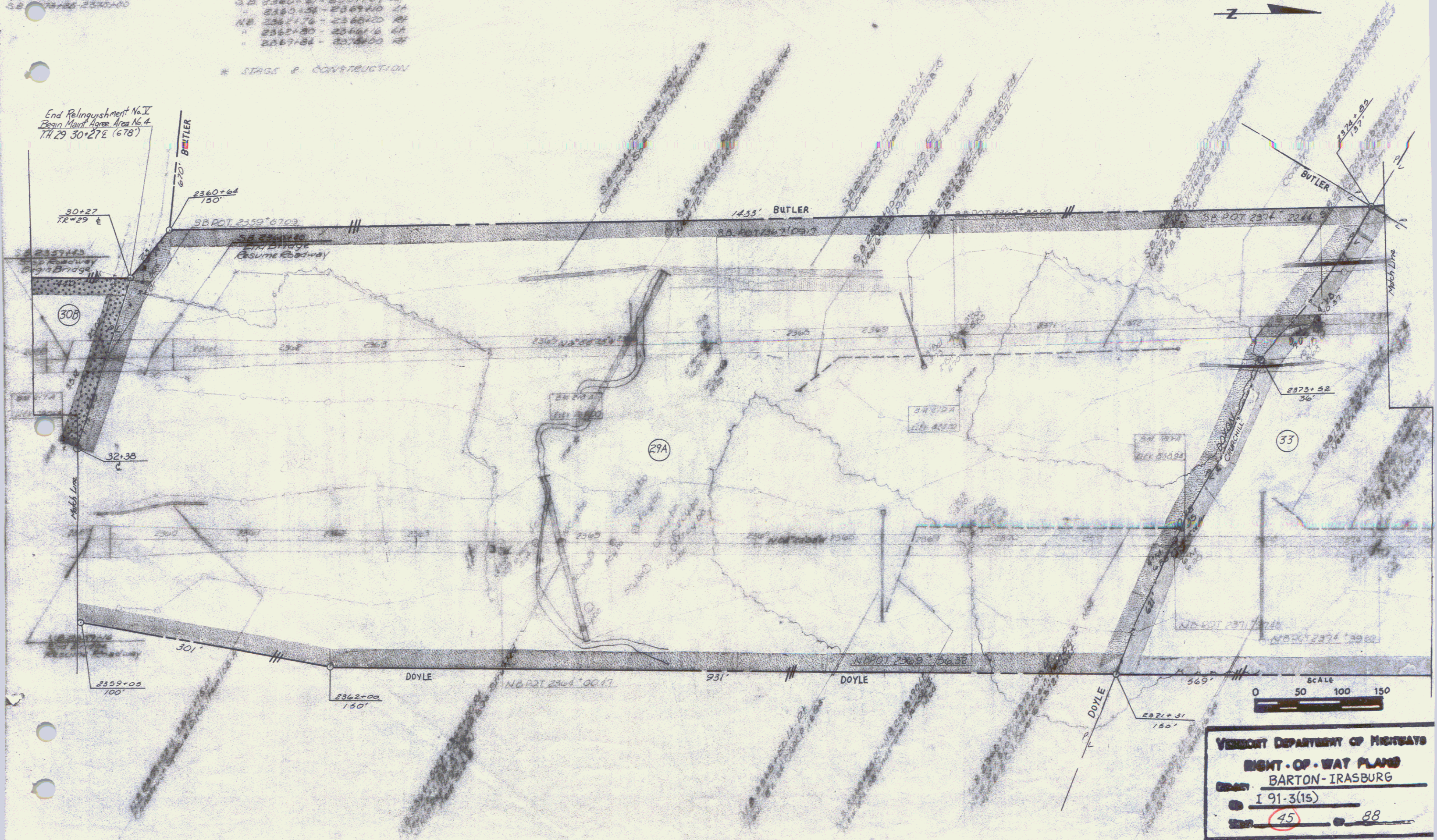

VERMONT DEPARTMENT OF HIGHWAYS
RIGHT-OF-WAY PLANS
COUNTY I 91-3(15)
SHEET 45 OF 88