

* Single Cable Ground Rod
 1. 233400-233410 CA
 2. 233410-233420 CA
 3. 233420-233430 CA
 4. 233430-233440 CA
 5. 233440-233450 CA
 6. 233450-233460 CA
 7. 233460-233470 CA
 8. 233470-233480 CA
 9. 233480-233490 CA
 10. 233490-233500 CA

* Reinforcing Concrete Curb
 Item 5.55
 1. 233400-233410 RY
 2. 233410-233420 RY
 3. 233420-233430 RY
 4. 233430-233440 RY
 5. 233440-233450 RY
 6. 233450-233460 RY
 7. 233460-233470 RY
 8. 233470-233480 RY
 9. 233480-233490 RY
 10. 233490-233500 RY

* Property Line
 1. 233400-233410 LT
 2. 233410-233420 LT
 3. 233420-233430 LT
 4. 233430-233440 LT
 5. 233440-233450 LT
 6. 233450-233460 LT
 7. 233460-233470 LT
 8. 233470-233480 LT
 9. 233480-233490 LT
 10. 233490-233500 LT

* STAGE 2 CONSTRUCTION

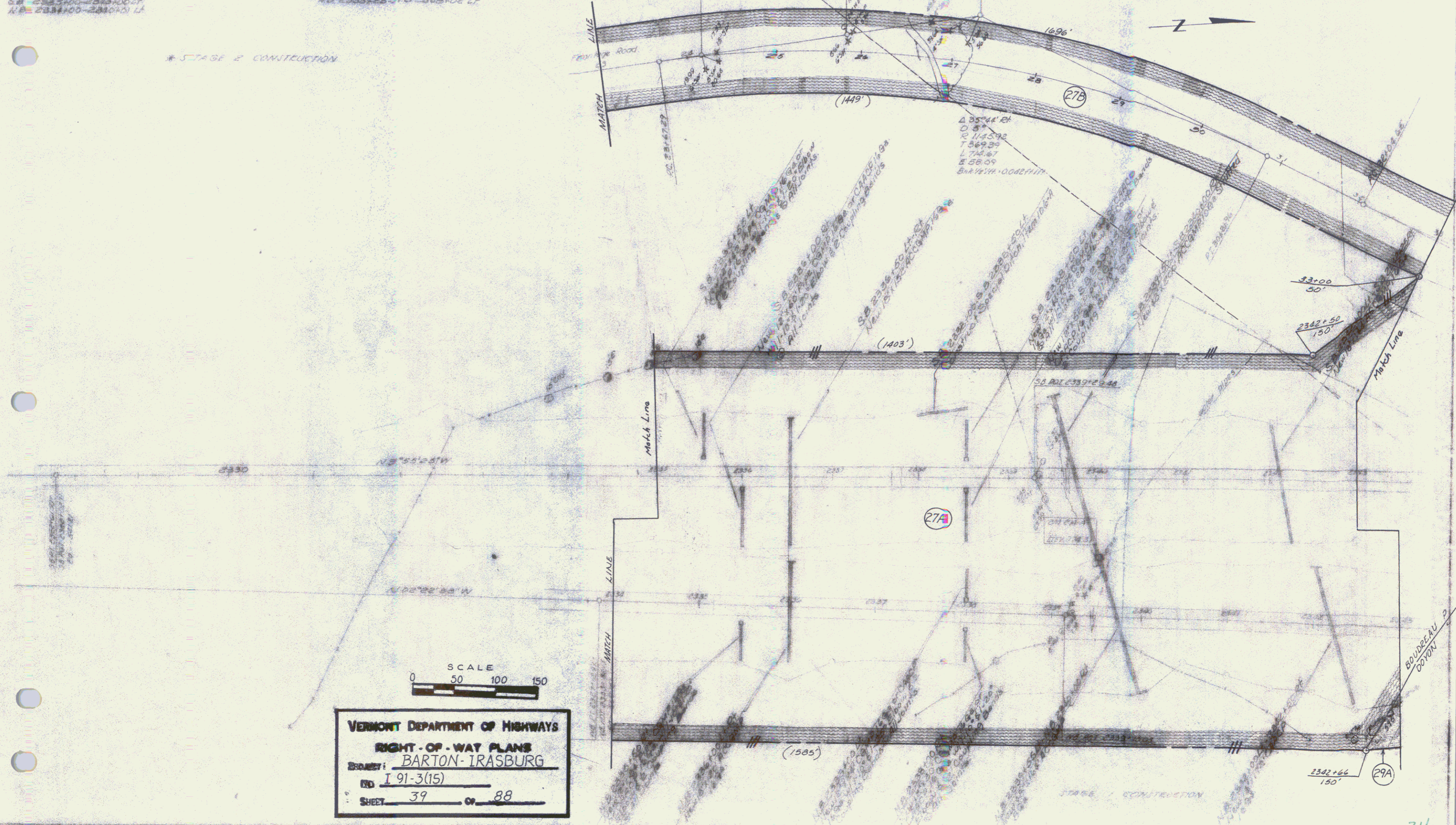

VERMONT DEPARTMENT OF HIGHWAYS
RIGHT-OF-WAY PLANS
 BOROUGH: BARTON-IRASBURG
 RD: I 91-3(15)
 SHEET: 39 OF 88

SHEET 39 34