

FORMERLY PARCEL 33B
 HARVEY M. & PATRICIA A. CAPLAN
 ACQUIRED BY W.D. DATED APRIL 23, 1971
 REC. MAY 19, 1971, IN BOOK 28, PAGE W223
 TOWN OF WHEELLOCK LAND RECORDS

STATE OF VERMONT
 TO
 WHEELLOCK CEMETERY COMMISSION

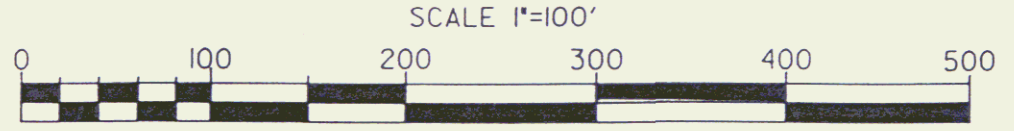
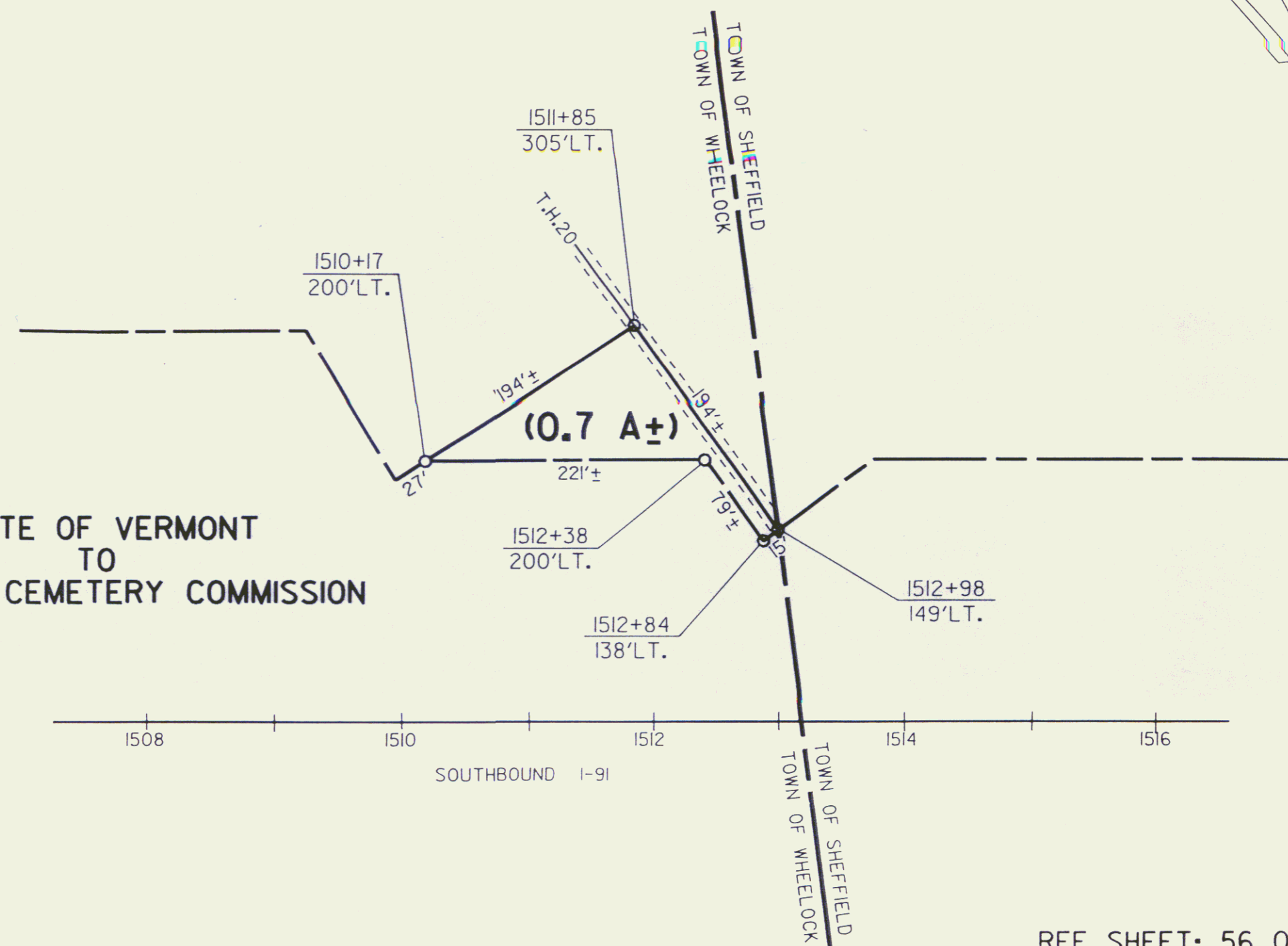

REF. SHEET: 56 OF 155

STATE OF VERMONT AGENCY OF TRANSPORTATION		
TOWN OF WHEELLOCK 56C		
PROJECT: LYNDON-BARTON I-91-3(14)		
APPROX. SCALE 1"=100'	DATE: 4-1-86	DRAWN BY D.E.M.

44