

Standard Steel Beam Guard Rail with Lt. Steel Posts - Item 545 E\*  
 SB 1405+40 - 1405+94 Lt.

Property Line Fence with Steel Posts (Mod), Item 555 II  
 SB 1396+00 - 1411+00 Lt.  
 NB 1397+00 - 1412+00 Rt.

Three Cable Guard Rail with Lt. St. Posts - Item 538\*  
 NB 1403+00 - 1405+50 Rt.  
 NB 1397+00 - 1412+00 Lt.  
 SB 1396+00 - 1403+98 Lt.  
 SB 1409+50 - 1411+00 Lt.

Bituminous Concrete Curb - Item 555\*  
 SB 1396+00 - 1403+00 Lt.

\*S.B.\*  
 Δ = 24° 01' 43" Lt.  
 D = 2° 00' 00"  
 F = 2,954.79'  
 T = 609.67'  
 L = 1,201.49'  
 E = 64.15'  
 Bk = 1/2' Ft.

Stone Fill for Slope Protection (Light Type), Item 512  
 NB 1402+30 - NB 1404+50 Rt - 2' High  
 NB 1406+30 - NB 1408+50 Rt - 2' High  
 SB 1398+00 Rt - NB 1400+48 Lt - Special Ditch  
 SB 1403+64 Rt - NB 1405+19 Lt - Special Ditch  
 SB 1409+45 Rt - 1409+60 Rt  
 SB 1396+50 Rt - 1398+00 Rt - 2' High  
 SB 1405+90 Lt 15' x 6'

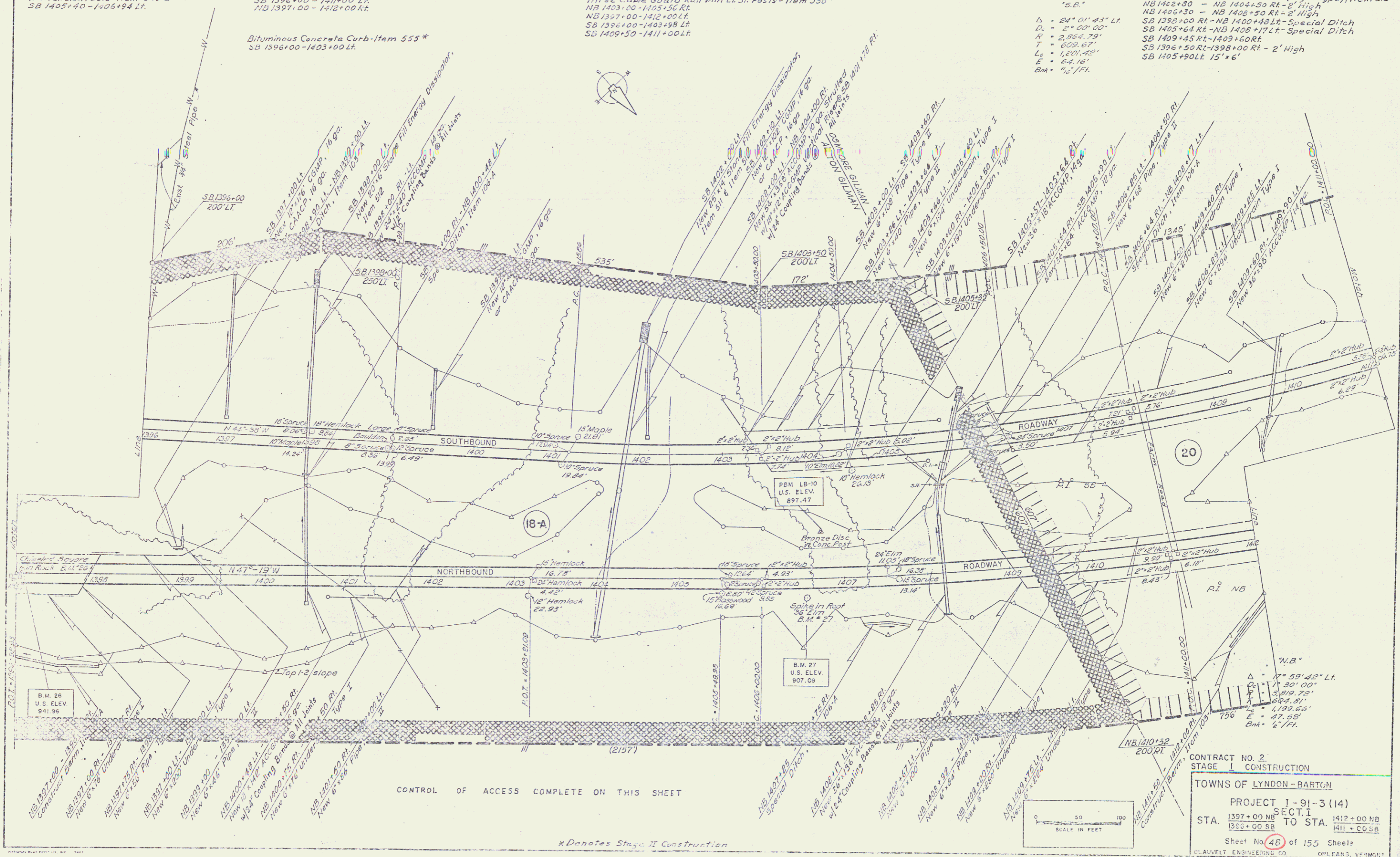

CONTROL OF ACCESS COMPLETE ON THIS SHEET

\*Denotes Stage II Construction

CONTRACT NO. 2  
 STAGE I CONSTRUCTION  
 TOWNS OF LYNDON - BARTON  
 PROJECT I-91-3 (14)  
 STA. 1397+00 NB TO STA. 1412+00 NB  
 1396+00 SB TO STA. 1411+00 SB  
 Sheet No. 48 of 155 Sheets  
 CLAUVELT ENGINEERING CO. OPLANDS, VERMONT