

Three Cable Guard Rail with Steel Posts, Item 542\*  
 NB 1328+00 - 1330+06 Lt.  
 NB 1330+00 - 1330+06 Rt.  
 SB 1323+75 - 1325+35 Lt.  
 SB 1325+25 - 1326+37 Rt.

Just Nothing Main Post  
 NB 1330+53 - 1332+00 Lt.  
 NB 1330+70 - 1332+00 Rt.

Construct Speed Change Lane  
 SB 1323+00 - 1330+00 Lt.

Demolition & Disposal  
 of Buildings  
 Item 538  
 SB 1331+00 180' Rt.

Stone Fill for Slope Protection  
 (Light Type), Item 512  
 SB 1325+20 - 1325+50 Lt - 2' High  
 NB 1329+40 - 1330+10 Lt - Special Ditch  
 SB 1326+07 - 1326+25 Rt - Inlet Ditch  
 NB 1330+65 Rt - Inlet Ditch

Riprap (Heavy Type) Item 513-A  
 NB 1330+24 - 1330+76 Rt  
 NB 1329+23 - 1329+74 Lt  
 SB 1324+85 - 1325+30 Lt  
 SB 1325+70 - 1326+15 Rt

Property Line Fence with Steel Posts (Mod), Item 583 II  
 SB 1323+00 - 1330+00 Lt.  
 NB 1323+70 - 1330+00 Rt.

Stone Fill Energy Dissipator  
 (Heavy Type), Item 511  
 NB 1329+36 Lt.  
 SB 1325+00 Lt.

Stone Fill for Slope Protection  
 (Heavy Type), Item 511  
 SB 1323+60 - 1324+70 Lt - Special Ditch  
 NB 1328+36 - 1329+11 Lt - Special Ditch

Plank Guard Rail, Item 540  
 SB 1326+40 Lt. (24)  
 NB 1335+10 Rt. (24)

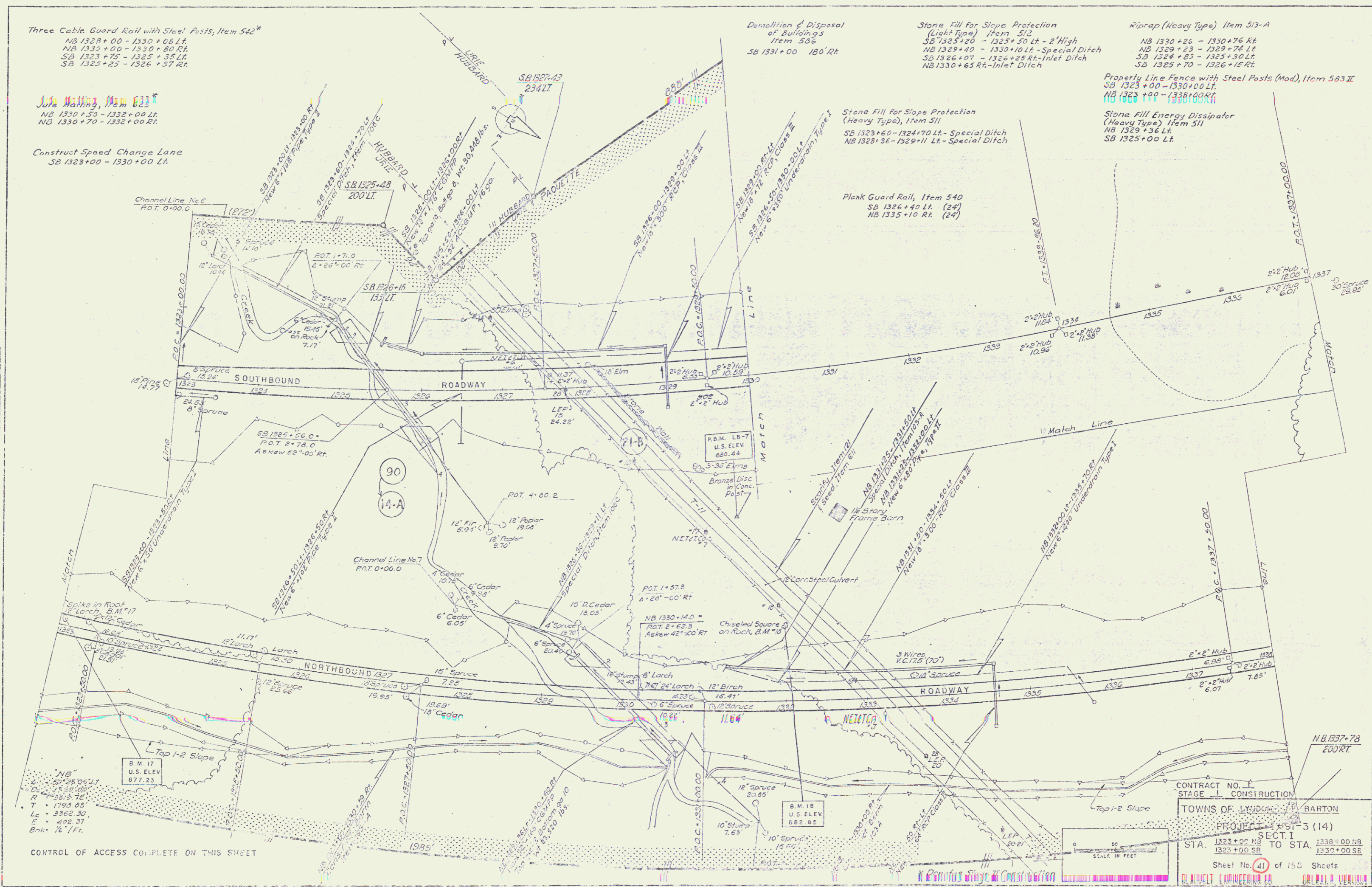

CONTROL OF ACCESS COMPLETE ON THIS SHEET

CONTRACT NO. 1  
 STAGE I CONSTRUCTION  
 TOWNS OF LYNDEN & BARTON  
 PROJECT EST 3 (14)  
 SECT. I  
 STA. 1323+00 NB TO STA. 1338+00 NB  
 1323+00 SB  
 Sheet No. 41 of 155 Sheets  
 CIVIL ENGINEER & ARCHITECT