

STATE OF VERMONT  
DEPARTMENT OF HIGHWAYS

PROPOSED IMPROVEMENT

TOWNS OF LYNDON-WHEELOCK-SHEFFIELD-GLOVER-BARTON

COUNTIES OF CALEDONIA-ORLEANS

INTERSTATE ROUTE 91  
LYNDON-BARTON

LENGTH OF ROW PROJECT SECT. I - 80,375 FEET = 15.223 MILES

SECTION I

Pin # 99R064

DE 2/1/00

R.O.W. PLANS

TRAFFIC DATA

1986	401	1270
1987	427	1320
1988	444	1370
D	0	0%
T	0	0%
V	0	0%

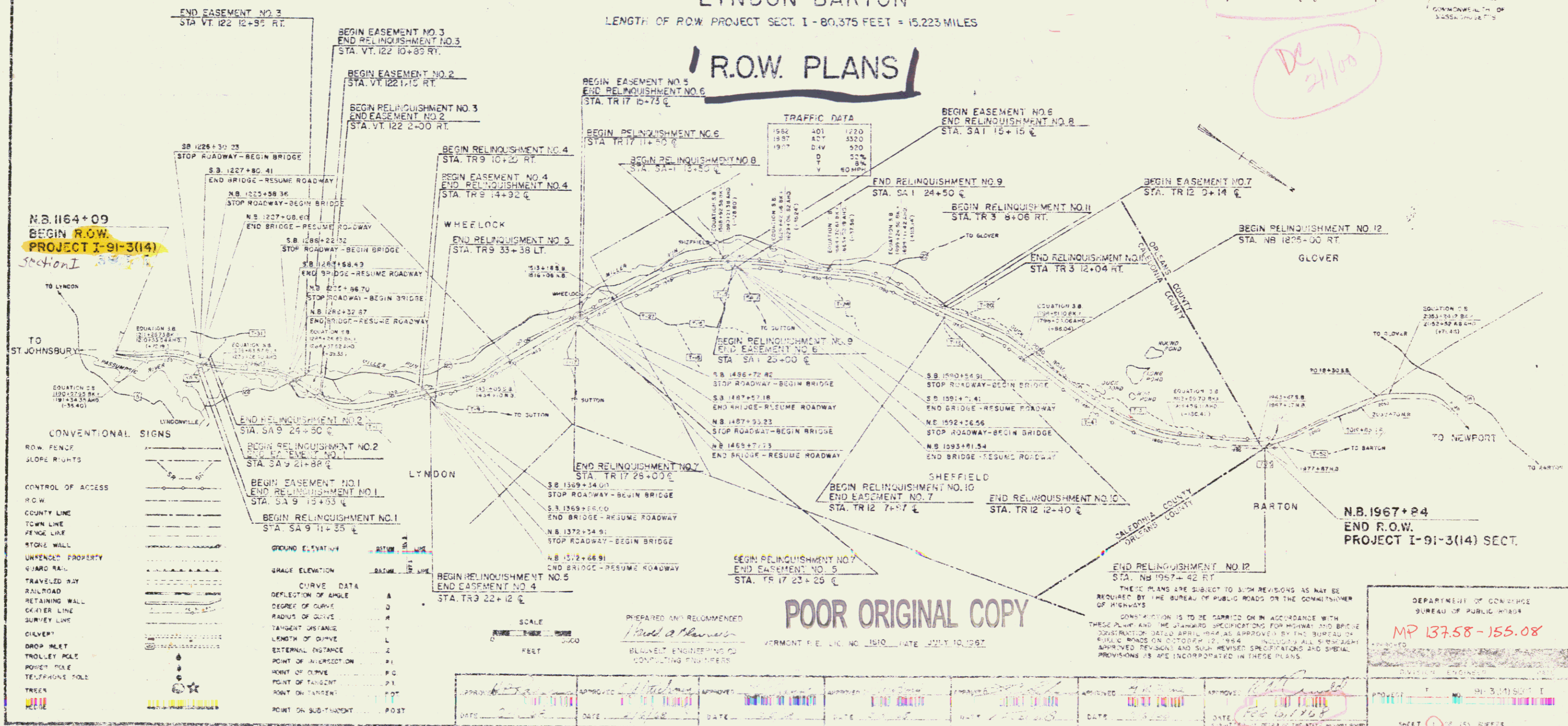

N.B. 1164+09  
BEGIN R.O.W.  
PROJECT I-91-3(14)  
SECTION I

- CONVENTIONAL SIGNS
- ROW FENCE
  - SLOPE RIGHTS
  - CONTROL OF ACCESS
  - R.O.W.
  - COUNTY LINE
  - TOWN LINE
  - FENCE LINE
  - STONE WALL
  - UNENCLOSED PROPERTY
  - GUARD RAIL
  - TRAVELED WAY
  - RAILROAD
  - RETAINING WALL
  - GRATER LINE
  - SURVEY LINE
  - CULVERT
  - DROP INLET
  - TROLLEY POLE
  - POWERS POLE
  - TELEPHONE POLE
  - TRUCK

GROUND ELEVATION

STATION	ELEVATION
SA 9 24+90	100.00
SA 9 21+82	100.00
SA 9 15+53	100.00
SA 9 11+35	100.00

CURVE DATA

STATION	DEFLECTION OF ANGLE	DEGREE OF CURVE	RADIUS OF CURVE	TANGENT DISTANCE	LENGTH OF CURVE	EXTERNAL DISTANCE	POINT OF INTERSECTION	POINT OF CURVE	POINT OF TANGENT	POINT ON TANGENT	POINT ON SUB-TANGENT
TR 9 10+22	A	3	1146	114.6	34.4	118.0	10+22	10+22	10+22	10+22	10+22
TR 9 14+32	A	3	1146	114.6	34.4	118.0	14+32	14+32	14+32	14+32	14+32
TR 9 33+38	A	3	1146	114.6	34.4	118.0	33+38	33+38	33+38	33+38	33+38
TR 17 28+00	A	3	1146	114.6	34.4	118.0	28+00	28+00	28+00	28+00	28+00
TR 17 23+25	A	3	1146	114.6	34.4	118.0	23+25	23+25	23+25	23+25	23+25
TR 12 12+40	A	3	1146	114.6	34.4	118.0	12+40	12+40	12+40	12+40	12+40
TR 12 0+14	A	3	1146	114.6	34.4	118.0	0+14	0+14	0+14	0+14	0+14
TR 12 0+14	A	3	1146	114.6	34.4	118.0	0+14	0+14	0+14	0+14	0+14
TR 12 0+14	A	3	1146	114.6	34.4	118.0	0+14	0+14	0+14	0+14	0+14

POOR ORIGINAL COPY

PREPARED AND RECOMMENDED  
Blair & Blaine  
BLAIR & BLAINE  
CONSULTING ENGINEERS

VERMONT P.E. LIC. NO. 1510 DATE JULY 10, 1967

THESE PLANS ARE SUBJECT TO SUCH REVISIONS AS MAY BE REQUIRED BY THE BUREAU OF PUBLIC ROADS OR THE COMMISSIONER OF HIGHWAYS.

CONSTRUCTION IS TO BE CARRIED ON IN ACCORDANCE WITH THESE PLANS AND THE STANDARD SPECIFICATIONS FOR HIGHWAY AND BRIDGE CONSTRUCTION, DATED APRIL, 1964, APPROVED BY THE BUREAU OF PUBLIC ROADS ON OCTOBER 12, 1964. UNLESS ALL SUCH REVISIONS, APPROVED REVISIONS AND SUCH REVISED SPECIFICATIONS AND SPECIAL PROVISIONS AS ARE INCORPORATED IN THESE PLANS.

DEPARTMENT OF CONSTRUCTION  
BUREAU OF PUBLIC ROADS  
MP 137.58-155.08

APPROVED	APPROVED	APPROVED	APPROVED	APPROVED	APPROVED	APPROVED	APPROVED
DATE	DATE	DATE	DATE	DATE	DATE	DATE	DATE