

CONTROL OF ACCESS IS COMPLETE ON THIS SHEET

SOUTHBOUND		NORTHBOUND	
96	99	96	99
Δ = 8°-11'-01"	Δ = 44°-38'-52"	Δ = 39°-30'-00"	Δ = 8°-45'-00"
Σ D = 0°-35'-09"	Σ D = 1°-00'-00"	Σ D = 8°-45'-00"	Σ D = 8°-45'-00"
Σ T = 1142.315	Σ T = 5729.58	Σ T = 7639.44	Σ T = 2472.024
Σ L = 818.01	Σ L = 2362.41	Σ L = 2472.024	Σ L = 2472.024
Σ E = 1833.38	Σ E = 4351.44	Σ E = 4771.47	Σ E = 4771.47
Σ R = 29.16	Σ R = 467.92	Σ R = 4771.47	Σ R = 4771.47
BANK = .027 / FT. LT.	BANK = .029 / FT. RT.	BANK = .029 / FT. RT.	BANK = .029 / FT. RT.

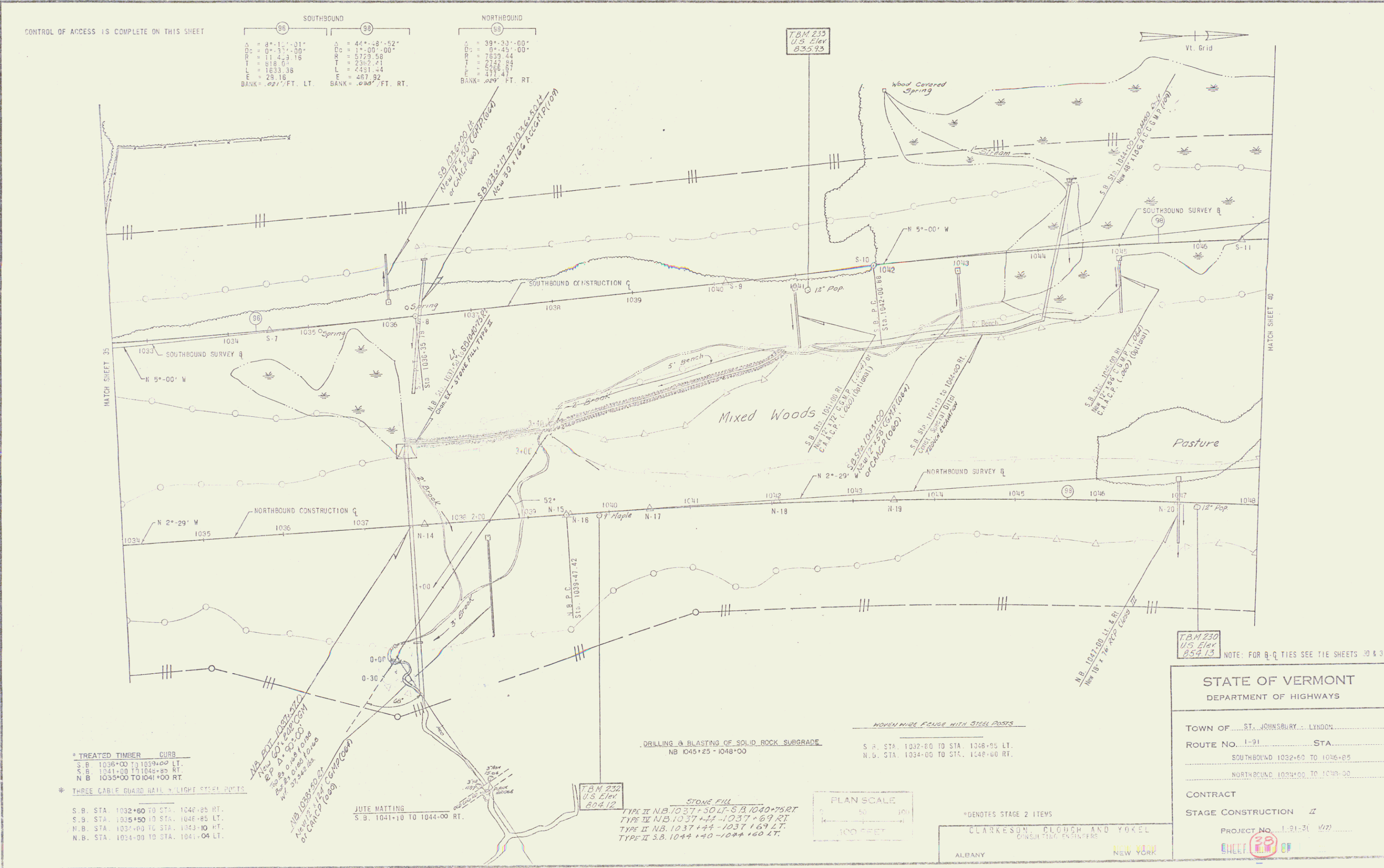

* TREATED TIMBER CURB
 S.B. STA. 1036+00 TO 1039+00 LT.
 N.B. STA. 1041+00 TO 1044+00 RT.

* THREE CABLE GUARD RAIL + LIGHT STEEL POSTS

S.B. STA. 1032+60 TO STA. 1046+85 RT.
 S.B. STA. 1035+50 TO STA. 1046+85 LT.
 N.B. STA. 1037+00 TO STA. 1043+10 RT.
 N.B. STA. 1034+00 TO STA. 1041+04 LT.

JUTE MATTING
 S.B. 1041+10 TO 1044+00 RT.

T.B.M. 232
 U.S. Elev.
 824.12

STONE FILL
 TYPE II NB. 1037+11 - 1037+69 RT.
 TYPE III NB. 1037+11 - 1037+69 RT.
 TYPE II NB. 1037+44 - 1037+69 LT.
 TYPE II S.B. 1044+10 - 1044+100 LT.

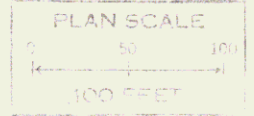

* DENOTES STAGE 2 ITEMS
 CLARKESON, GLOUGH AND YOKEL
 CONSULTING ENGINEERS
 ALBANY NEW YORK

STATE OF VERMONT
 DEPARTMENT OF HIGHWAYS

TOWN OF ST. JOHNSBURY - LYNDON

ROUTE NO. 1-91 STA. _____

SOUTHBOUND 1032+60 TO 1046+85
 NORTHBOUND 1034+00 TO 1043+00

CONTRACT _____

STAGE CONSTRUCTION II

PROJECT NO. 1-21-31 1/77