

TREATED TIMBER CURB ITEM 613.35  
N.B. STA. 997+50 TO STA. 1004+00 LT.

CONTROL OF ACCESS IS COMPLETE ON THIS SHEET

DRILLING AND BLASTING OF SOLID ROCK  
SUBGRADE, ITEM 206.10  
N.B. STA. 989+00 TO 995+50  
S.B. STA. 988+20 TO 997+00  
S.B. STA. 999+00 TO 1001+50

SOUTH 95 BOUND		NORTH 76 BOUND	
A	8°-40'-59"	Δ	6°-11'-29"
DC	0°-15'-00"	Dc	0°-15'-00"
R	22,918.31	R	22,918.31
T	1770.13	T	1239.48
L	3533.25	L	2476.54
E	68.26	E	33.49
BANK 021/ft LT. BANK 021/ft LT.			

VT. GRID

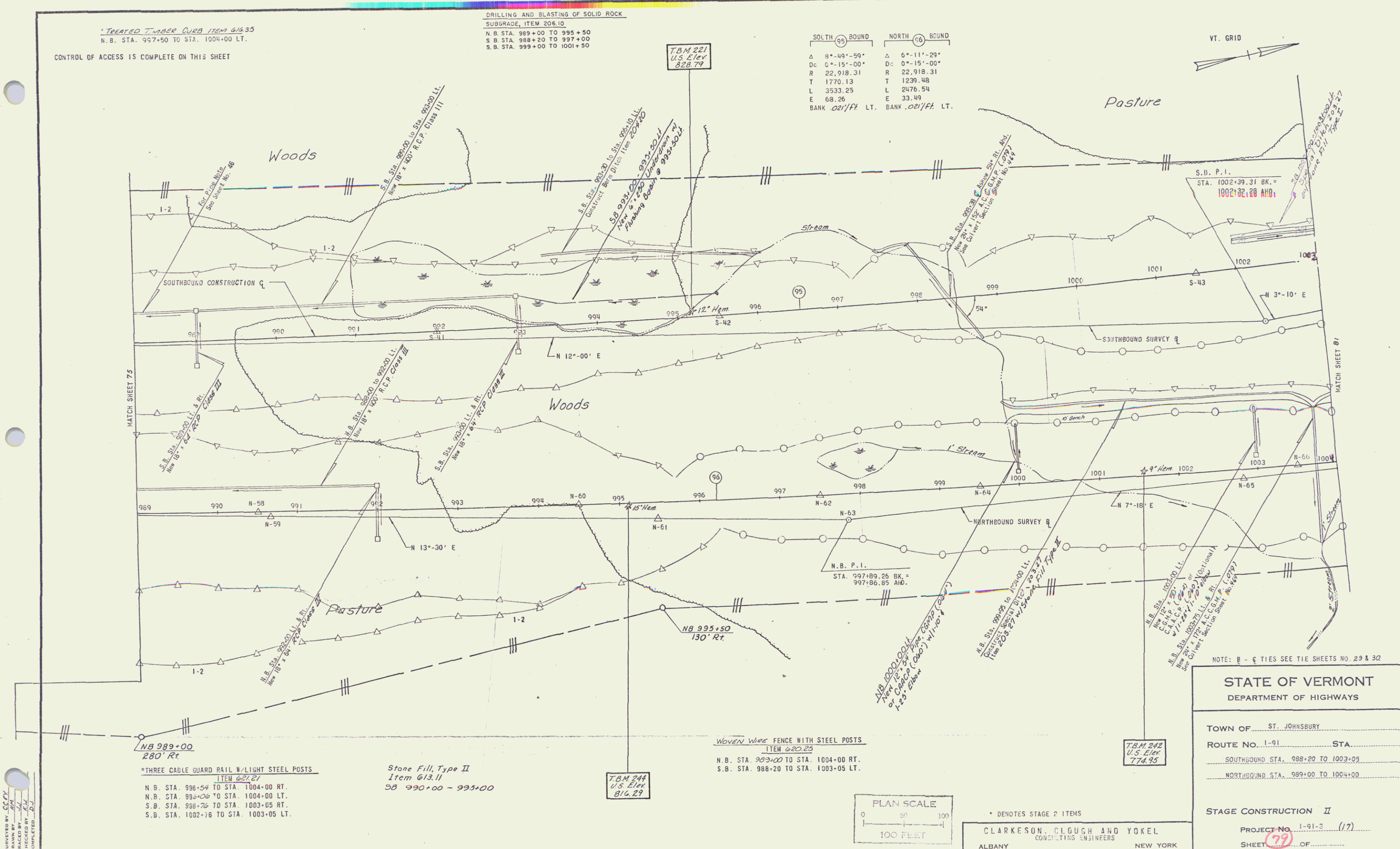
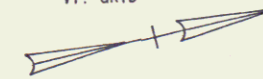

SURVEYED BY: C.C.V.  
CHECKED BY: J.S.V.  
COMPLETED: 1971

\*THREE CABLE GUARD RAIL W/LIGHT STEEL POSTS  
ITEM 621.27  
N.B. STA. 998+54 TO STA. 1004+00 RT.  
N.B. STA. 998+06 TO STA. 1004+00 LT.  
S.B. STA. 998+76 TO STA. 1003+05 RT.  
S.B. STA. 1002+76 TO STA. 1003+05 LT.

Stone Fill Type II  
Item 613.11  
SB 990+00 - 995+00

T.B.M. 244  
U.S. Elev.  
816.29

Woven Wire Fence with Steel Posts  
ITEM 620.23  
N.B. STA. 999+00 TO STA. 1004+00 RT.  
S.B. STA. 988+20 TO STA. 1003+05 LT.

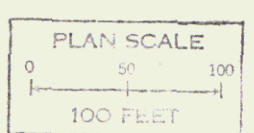

\* DENOTES STAGE 2 ITEMS  
CLARKESON, CLUGH AND YOKEL  
CONSULTING ENGINEERS  
ALBANY NEW YORK

NOTE: B - C TIES SEE TIE SHEETS NO. 29 & 32

**STATE OF VERMONT**  
DEPARTMENT OF HIGHWAYS

TOWN OF ST. JOHNSBURY

ROUTE No. 1-91 STA. \_\_\_\_\_

SOUTHBOUND STA. 988+20 TO 1003+05  
NORTHBOUND STA. 999+00 TO 1004+00

STAGE CONSTRUCTION II

PROJECT No. 1-91-3 (17)

SHEET 79 OF \_\_\_\_\_