

CONTROL OF ACCESS IS COMPLETE ON THIS SHEET.

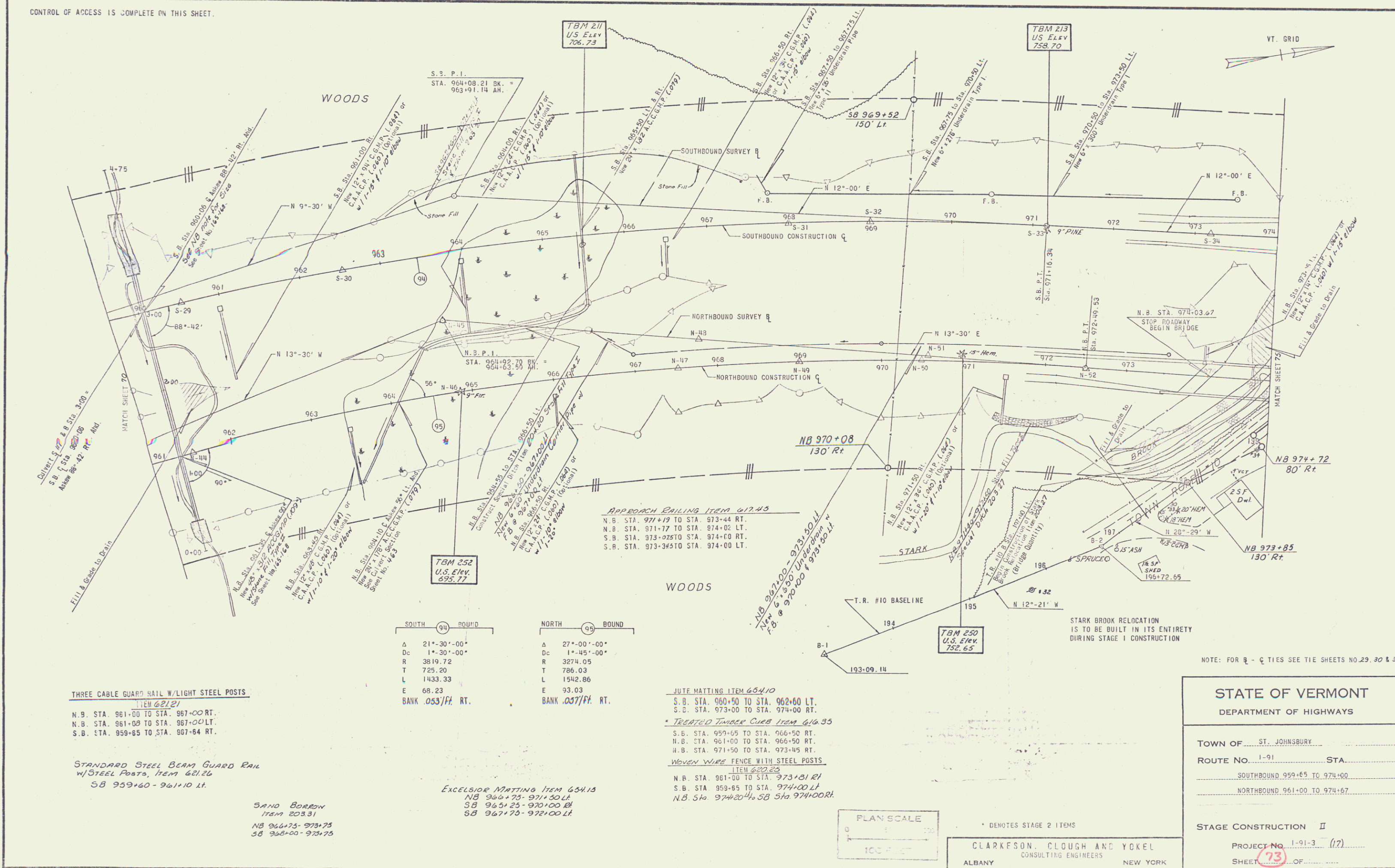

THREE CABLE GUARD RAIL W/LIGHT STEEL POSTS  
ITEM 621.21  
N.B. STA. 961+00 TO STA. 967+00 RT.  
N.B. STA. 961+00 TO STA. 967+00 LT.  
S.B. STA. 959+85 TO STA. 967+84 RT.

STANDARD STEEL BEAM GUARD RAIL  
W/STEEL POSTS, ITEM 621.26  
SB 959+60 - 961+10 LT.

SAND BORDIN  
ITEM 203.31  
NB 966+75 - 973+75  
SB 968+00 - 973+75

SOUTH (91) BOUND		NORTH (95) BOUND	
Δ	21'-30"-00"	Δ	27'-00"-00"
Dc	1'-30"-00"	Dc	1'-45"-00"
R	3819.72	R	3274.05
T	725.20	T	786.03
L	1433.33	L	1542.86
E	68.23	E	93.03
BANK .053/FT. RT.		BANK .037/FT. RT.	

EXCELSIOR MATTING ITEM 624.13  
NB 969+75 - 974+30 LT.  
SB 965+25 - 970+00 RT.  
SB 967+75 - 972+00 LT.

JUTE MATTING ITEM 624.10  
S.B. STA. 960+50 TO STA. 962+00 LT.  
S.D. STA. 973+00 TO STA. 974+00 RT.  
\* TREATED TIMBER CURB ITEM 616.35  
S.B. STA. 959+65 TO STA. 966+50 RT.  
N.B. STA. 961+00 TO STA. 966+50 RT.  
N.B. STA. 971+50 TO STA. 973+45 RT.  
WOVEN WIRE FENCE WITH STEEL POSTS  
ITEM 620.23  
N.R. STA. 961+00 TO STA. 973+81 RT.  
S.B. STA. 959+85 TO STA. 974+00 LT.  
N.B. STA. 974+20 1/2 SB STA. 974+00 RT.

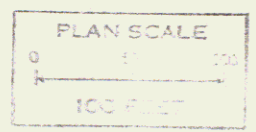

CLARKESON, CLOUGH AND YOKEL  
CONSULTING ENGINEERS  
ALBANY NEW YORK

NOTE: FOR R - C TIES SEE TIE SHEETS NO. 29, 30 & 31

STATE OF VERMONT  
DEPARTMENT OF HIGHWAYS

TOWN OF ST. JOHNSBURY

ROUTE No. 1-91 STA. \_\_\_\_\_

SOUTHBOUND 959+65 TO 974+00  
NORTHBOUND 961+00 TO 974+67

STAGE CONSTRUCTION II

PROJECT No. 1-91-3 (17)

SHEET 73 OF \_\_\_\_\_