

**EXCELSIOR MATTING**  
**ITEM 654.15**  
 N.B. STA. 805+00 - 808+00 LT.  
 N.B. STA. 809+00 - 811+50 LT.  
 N.B. STA. 810+10 - 813+10 RT.  
 N.B. STA. 813+00 - 815+00 LT.  
 S.B. STA. 809+00 - 808+00 LT.  
 W-N Ramp 15+00 - NB 810+00 RT  
 JUTE MATTING 654.10

N.B. STA. 801+00 TO STA. 805+00 RT.  
 RAMP W TO N STA. 15+00 TO 15+60 RT.  
 N.B. STA. 801+00 TO STA. 803+00 LT.

CONTROL OF ACCESS IS COMPLETE ON THIS SHEET.

N.B. Sta. 801+00 RT. to S.B. 801+00 LT.  
 W-N Ramp 15+00 to S.B. 801+00 LT.  
 w/ Stone Fill, Type II

N.B. Sta. 801+00 RT. to S.B. 801+00 LT.  
 W-N Ramp 15+00 to S.B. 801+00 LT.  
 w/ Stone Fill, Type II

N.B. Sta. 801+00 RT. to S.B. 801+00 LT.  
 W-N Ramp 15+00 to S.B. 801+00 LT.  
 w/ Stone Fill, Type II

N.B. Sta. 801+00 RT. to S.B. 801+00 LT.  
 W-N Ramp 15+00 to S.B. 801+00 LT.  
 w/ Stone Fill, Type II

RAMP W TO S STA. 7+24.53 RAMP W TO S STA. 7+48.00 =  
 STOP ROADWAY SLEEPERS RIVER RELOC.  
 BEGIN BRIDGE STA. 25+08.00  
 RAMP W TO S STA. 7+71.44  
 END BRIDGE  
 RESUME ROADWAY

RAMP W TO S STA. 7+48  
 TWIN 20' x 24' x 244' CONC. BOX

MATCH TO SHEET 64

RAMP W TO S STA. 145+71.87  
 STA. 145+71.87

RAMP W TO S STA. 145+71.87  
 STA. 145+71.87

RAMP W TO S STA. 145+71.87  
 STA. 145+71.87

RAMP W TO S STA. 145+71.87  
 STA. 145+71.87

RAMP W TO S STA. 145+71.87  
 STA. 145+71.87

RAMP W TO S STA. 145+71.87  
 STA. 145+71.87

RAMP W TO S STA. 145+71.87  
 STA. 145+71.87

RAMP W TO S STA. 145+71.87  
 STA. 145+71.87

RAMP W TO S STA. 145+71.87  
 STA. 145+71.87

RAMP W TO S STA. 145+71.87  
 STA. 145+71.87

RAMP W TO S STA. 145+71.87  
 STA. 145+71.87

RAMP W TO S STA. 145+71.87  
 STA. 145+71.87

RAMP W TO S STA. 145+71.87  
 STA. 145+71.87

RAMP W TO S STA. 145+71.87  
 STA. 145+71.87

RAMP W TO S STA. 145+71.87  
 STA. 145+71.87

RAMP W TO S STA. 145+71.87  
 STA. 145+71.87

RAMP W TO S STA. 145+71.87  
 STA. 145+71.87

RAMP W TO S STA. 145+71.87  
 STA. 145+71.87

RAMP W TO S STA. 145+71.87  
 STA. 145+71.87

RAMP W TO S STA. 145+71.87  
 STA. 145+71.87

RAMP W TO S STA. 145+71.87  
 STA. 145+71.87

RAMP W TO S STA. 145+71.87  
 STA. 145+71.87

RAMP W TO S STA. 145+71.87  
 STA. 145+71.87

RAMP W TO S STA. 145+71.87  
 STA. 145+71.87

RAMP W TO S STA. 145+71.87  
 STA. 145+71.87

RAMP W TO S STA. 145+71.87  
 STA. 145+71.87

RAMP W TO S STA. 145+71.87  
 STA. 145+71.87

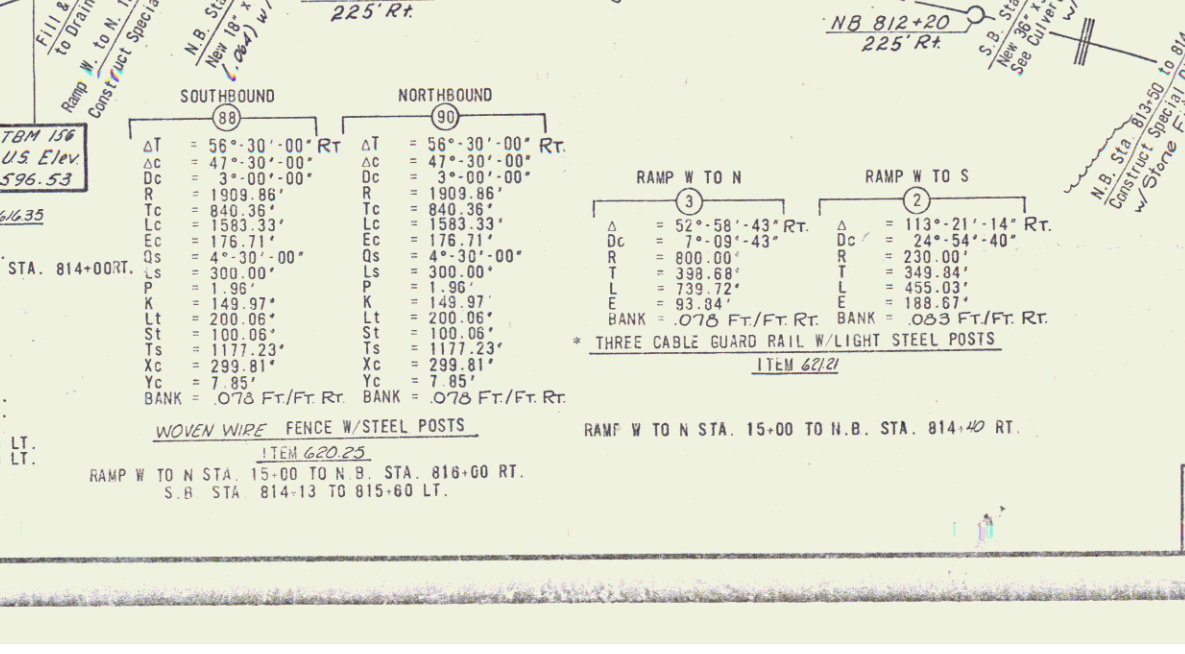
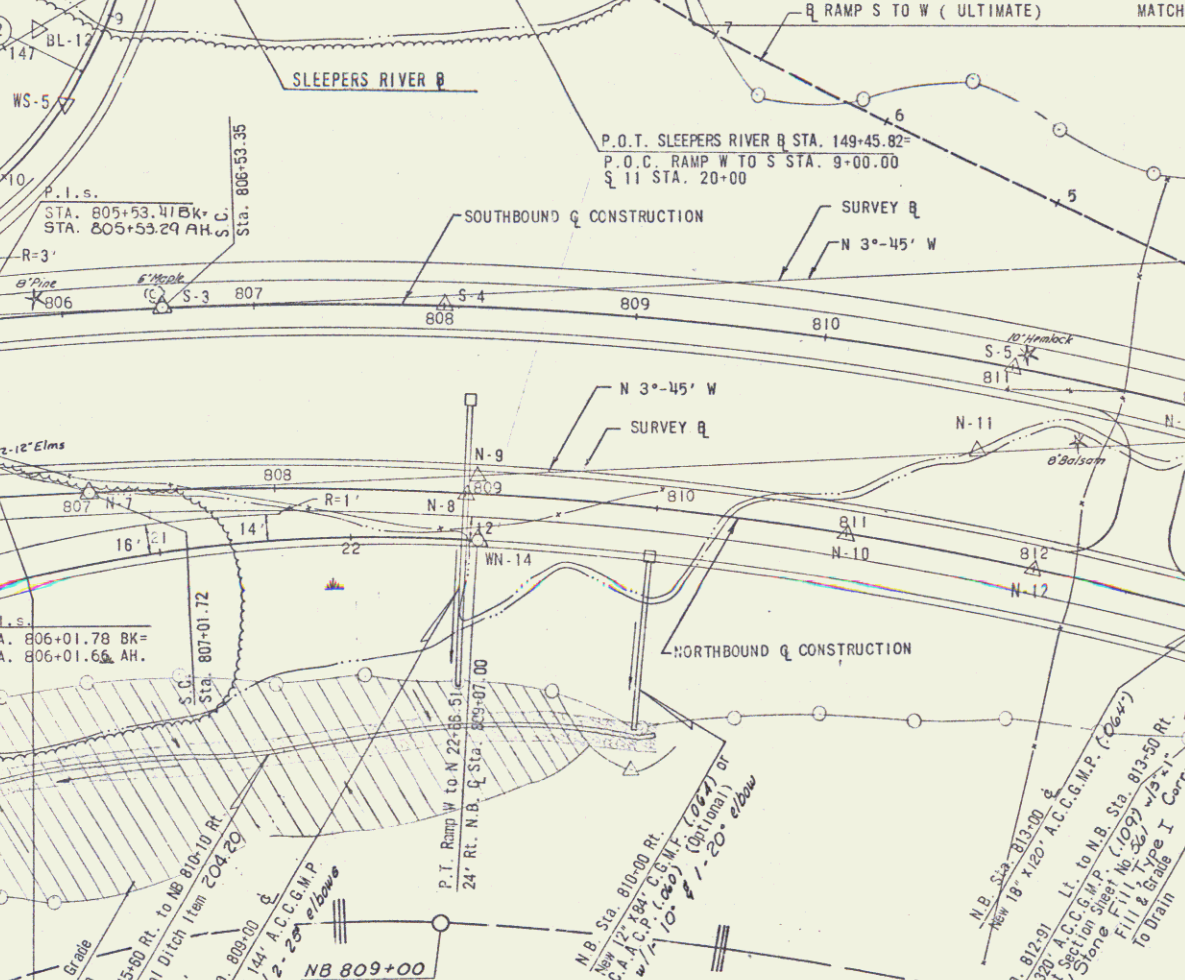
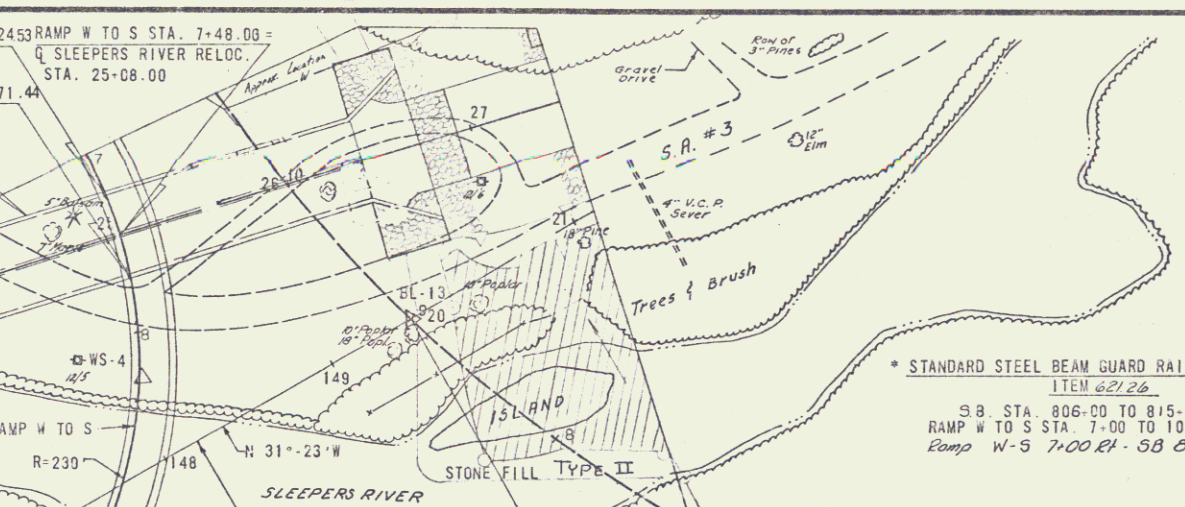

SOUTHBOUND		NORTHBOUND	
ΔT	= 56° 30' 00" RT	ΔT	= 56° 30' 00" RT
Dc	= 47° 30' 00"	Dc	= 47° 30' 00"
R	= 3° 00' 00"	R	= 3° 00' 00"
Lc	= 1909.86'	Lc	= 1909.86'
Tc	= 840.38'	Tc	= 840.38'
Ec	= 1593.33'	Ec	= 1593.33'
Sc	= 176.71'	Sc	= 176.71'
Os	= 4° 30' 00"	Os	= 4° 30' 00"
Ps	= 300.00'	Ps	= 300.00'
K	= 1.96'	K	= 1.96'
Lt	= 149.97'	Lt	= 149.97'
St	= 200.06'	St	= 200.06'
Ts	= 100.06'	Ts	= 100.06'
Xc	= 117.23'	Xc	= 117.23'
Yc	= 299.81'	Yc	= 299.81'
BANK	= 7.85' FT/FT RT	BANK	= 7.85' FT/FT RT

RAMP W TO N		RAMP W TO S	
Δ	= 52° 58' 43" RT	Δ	= 113° 21' 14" RT
Dc	= 7° 09' 43"	Dc	= 24° 54' 40"
R	= 800.00'	R	= 230.00'
T	= 339.88'	T	= 349.84'
L	= 739.72'	L	= 455.03'
E	= 93.04'	E	= 188.67'
BANK	= 0.76 FT/FT RT	BANK	= 0.63 FT/FT RT

Construct 'U' Turn  
 NB 812+30 LT - SB 811+86 RT  
 DRILLING & BLASTING OF SOLID  
 ROCK SUBGRADE ITEM 200.10  
 NB 813+25 - 816+00

\* STANDARD STEEL BEAM GUARD RAIL W/STEEL POSTS  
 ITEM 627.26  
 S.B. STA. 806+00 TO 815+60 LT.  
 RAMP W TO S STA. 7+00 TO 10+00 LT.  
 Ramp W-S 7+00 RT - SB 801+00 LT

RAMP S TO W (ULTIMATE) MATCH TO SHEET 75

P.O.T. SLEEPERS RIVER STA. 149+45.82  
 P.O.C. RAMP W TO S STA. 9+00.00  
 STA. 20+00

N 3°-45' W  
 SURVEY

N 3°-45' W  
 SURVEY

N 3°-45' W  
 SURVEY

N 3°-45' W  
 SURVEY

N 3°-45' W  
 SURVEY

N 3°-45' W  
 SURVEY

N 3°-45' W  
 SURVEY

N 3°-45' W  
 SURVEY

N 3°-45' W  
 SURVEY

N 3°-45' W  
 SURVEY

N 3°-45' W  
 SURVEY

N 3°-45' W  
 SURVEY

NOTE: FOR R - C TIES SEE THE SHEET NO. 32.33 & 34

**STATE OF VERMONT**  
 DEPARTMENT OF HIGHWAYS

TOWN OF ST. JOHNSBURY  
 ROUTE NO. 1-91 STA.  
 SOUTHBOUND STA. 801+00 TO 815+60  
 NORTHBOUND STA. 801+00 TO 815+00  
 RAMP W TO S STA. 7+00 TO 11+48.87  
 RAMP W TO N STA. 15+00 TO 22+66.51

STAGE CONSTRUCTION II  
 PROJECT No. 1-91-3 (17)  
 SHEET 69 OF

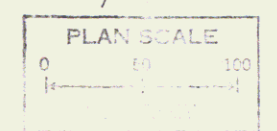

\* DENOTES STAGE 2 ITEMS  
 CLARKESON, SLOUGH AND YOKEL  
 CONSULTING ENGINEERS  
 ALBANY NEW YORK