

CONTROL OF ACCESS IS COMPLETE ON THIS SHEET.

SAND BORROW, ITEM 203.31
Rte. 2 Reloc. 64+50-73+50 E.B. &
Rte. 2 Reloc. 64+50-66+50 W.B. &
Rte. 2 Reloc. 69+00-73+50 W.B. &

STONE FILL For Slope Stabilization
Item 613.11
Rte. 2 Reloc. 63+25-66+75 E.B. Lt. (Type II)

Match to Insert 'C', Sheet 47

ROUTE 2 RELOCATION STA. 75+00.00
END CONSTRUCTION U.S. ROUTE 2
ON PROJECT I-91-3(19)

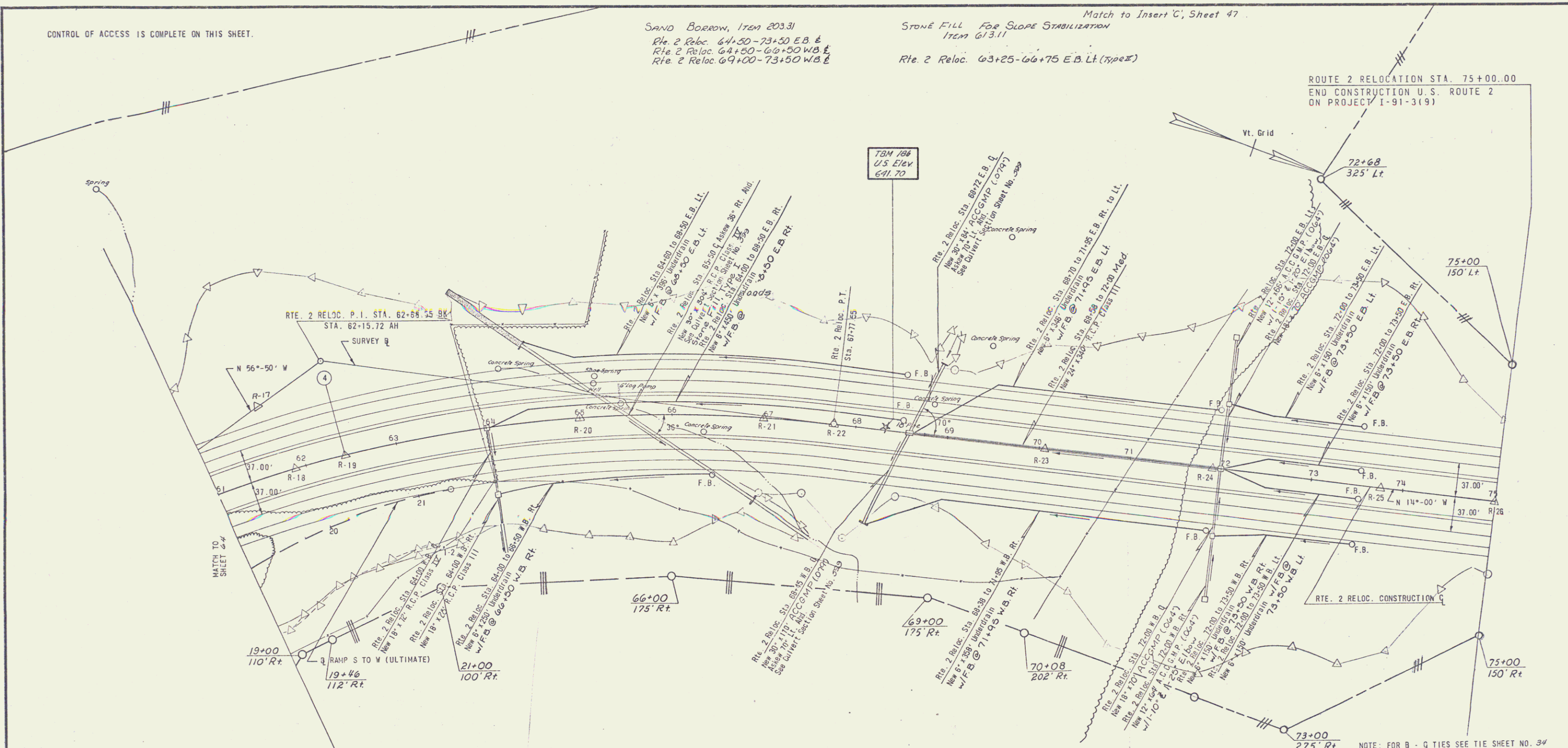

ROUTE #2

A	= 42'-50'-00" Rt.
Dc	= 4'-00'-00" Rt.
R	= 1432.40
T	= 561.83
L	= 1070.83
BANK	= 105.24
	= 0.75 Ft./Ft. Rt.

JUTE MATTING ITEM 654.10
 RTE. 2 RELOC. STA. 61+00 TO 63+00 MED.
 RTE. 2 RELOC. STA. 61+00 TO 63+00 E. B. LT.
 RTE. 2 RELOC. STA. 64+00 TO 67+50 MED.
 RTE. 2 RELOC. STA. 64+50 TO 67+00 E. B. LT.

WOVEN WIRE FENCE W. STEEL POSTS
 ITEM 620.25
 RTE. 2 RELOC. STA. 61+00 TO 75+00 E. B. LT.
 RTE. 2 RELOC. STA. 61+00 TO 75+00 W. B. RT.

Construct Fence prior to
 any other work in these Areas
 U.S. 2 Reloc. 70+20 - 75+00 Rt.
 U.S. 2 Reloc. 72+50 - 75+00 Lt.

DRILLING & BLASTING OF SOLID
 ROCK SUBGRADE ITEM 206.10
 Rte 2 Reloc. 61+00 - 64+50

ROUTE 2 RELOCATION IS TO BE BUILT IN ITS
 ENTIRETY DURING STAGE I CONSTRUCTION, EXCEPT
 17'± WEARING COURSE AND CORRESPONDING
 SHOULDER COURSE.

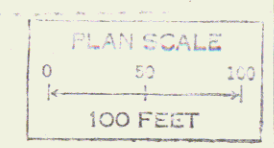

CLARKSON, CLOUGH AND YOKEL
 CONSULTING ENGINEERS
 ALBANY NEW YORK

STATE OF VERMONT
 DEPARTMENT OF HIGHWAYS

TOWN OF ST. JOHNSBURY

ROUTE No. I-91 STA. _____

ROUTE 2 RELOCATION STA. 61+00 TO STA. 75+00

STAGE CONSTRUCTION II

PROJECT No. I-91-3 (17)

SHEET 47 OF _____

SUBMITTED BY: C.C.K.
 DRAWN BY: J.W.
 CHECKED BY: J.W.
 COMPLETED: 2/77