

CONTROL OF ACCESS IS COMPLETE ON THIS SHEET

RAMP S TO E		
1	2	3
$\Delta = 60^{\circ}43'10''$ RT.	$\Delta = 140^{\circ}24'02''$ RT.	$\Delta = 109^{\circ}17'48''$ RT.
$Dc = 24^{\circ}54'40''$	$Dc = 16^{\circ}36'27''$	$Dc = 24^{\circ}54'40''$
$R = 230.00'$	$R = 345.00'$	$R = 230.00'$
$T = 137.43'$	$T = 958.29'$	$T = 324.22'$
$L = 247.76'$	$L = 845.41'$	$L = 438.75'$
$E = 37.93'$	$E = 873.51'$	$E = 181.52'$
BANK = .063 Ft./Ft. Rt.	BANK = .063 Ft./Ft. Rt.	BANK = .063 Ft./Ft. Rt.

TREATED TIMBER CURB ITEM 616.35
 Rte 2 Reloc 44+89 EB LT - Ramp S-E 13+00 LT
 Rte 2 Reloc 44+00 WB LT - Ramp W-S 0+30 RT
 * SB 788+50 - 792+00 LT
 * SB 799+00 - 801+00 LT
 * Ramp S-E 9+50 - 13+00 LT
 * SB 795+00 LT - Ramp S-E 4+50 RT
 Rte 2 Reloc 45+34 - 45+29 EB RT
 Rte 2 Reloc 45+04 - 45+09 WB LT

RAMP E TO S			RAMP W TO S		
2	3	1	1	2	3
$\Delta = 25^{\circ}16'24''$ LT.	$\Delta = 37^{\circ}01'24''$ RT.	$\Delta = 115^{\circ}13'46''$ RT.	$\Delta = 115^{\circ}13'46''$ RT.	$\Delta = 115^{\circ}13'46''$ RT.	$\Delta = 115^{\circ}13'46''$ RT.
$Dc = 14^{\circ}25'56''$	$Dc = 4^{\circ}05'33''$	$Dc = 16^{\circ}36'27''$	$Dc = 16^{\circ}36'27''$	$Dc = 16^{\circ}36'27''$	$Dc = 16^{\circ}36'27''$
$R = 397.00'$	$R = 1400.00'$	$R = 345.00'$	$R = 345.00'$	$R = 345.00'$	$R = 345.00'$
$T = 89.01'$	$T = 458.74'$	$T = 458.74'$	$T = 458.74'$	$T = 458.74'$	$T = 458.74'$
$L = 175.12'$	$L = 904.65'$	$L = 893.84'$	$L = 893.84'$	$L = 893.84'$	$L = 893.84'$
$E = 9.86'$	$E = 76.39'$	$E = 299.13'$	$E = 299.13'$	$E = 299.13'$	$E = 299.13'$
BANK = .075 Ft./Ft. LT.	BANK = .031 Ft./Ft. RT.	BANK = .053 Ft./Ft. RT.	BANK = .053 Ft./Ft. RT.	BANK = .053 Ft./Ft. RT.	BANK = .053 Ft./Ft. RT.

ITEM 613.11
 S.B. STA. 788+00 TO STA. 788+70 LT.
 S.B. STA. 789+65 TO STA. 792+00 LT.
 S.B. STA. 794+41 TO STA. 795+30 LT.
 S.B. STA. 798+80 TO STA. 801+00 LT.
 ROUTE 2 RELOC. STA. 46+10 TO STA. 47+23 E.B. LT.
 ROUTE 2 RELOC. STA. 49+00 TO STA. 49+85 W.B. RT.
 RAMP S TO E STA. 0+00 TO STA. 2+50 RT.
 RAMP S TO E STA. 1+95 TO STA. 2+90 LT.
 RAMP S TO E STA. 3+30 TO STA. 4+45 RT.
 RAMP S TO E STA. 3+45 TO STA. 4+30 LT.
 RAMP S TO E STA. 11+20 TO STA. 15+32 RT.
 RAMP E TO S STA. 18+90 TO STA. 21+00 LT.
 ROUTE 2 RELOC. STA. 46+87 TO STA. 47+87 W.B. RT.

ITEM 617.45
 APPROACH DRILLING
 Rte 2 46+00 - 46+27 WB RT
 Rte 2 44+89 - 45+16 EB LT
 Rte 2 45+34 - 45+59 EB RT
 Rte 2 45+04 - 45+29 WB LT

ITEM 616.15
 GRANITE SLOPE EROSION
 Ramp S-E 7+20 - 9+08 LT
 Ramp E-S 18+17 - 14+00 LT

ITEM 620.25
 WOMEN WIDE FENCE W/ STEEL POSTS
 RAMP E TO S STA. 20+70 TO 7+40 RT.

ITEM 620.40
 REMOVAL & DISPOSAL OF PRESENT GUARD RAIL
 RTE 2 RELOC STA. 50+92 TO 52+10 E.B. LT.

ITEM 620.45
 STANDARD STEEL BEAM GUARD RAIL W/ STEEL POSTS
 S.B. 788+00 - 792+75 LT
 S.B. 801+00 LT - Ramp S-E 5+02 RT
 Ramp S-E 9+17 - 13+00 RT
 Ramp S-E 1+30 - 4+25 LT

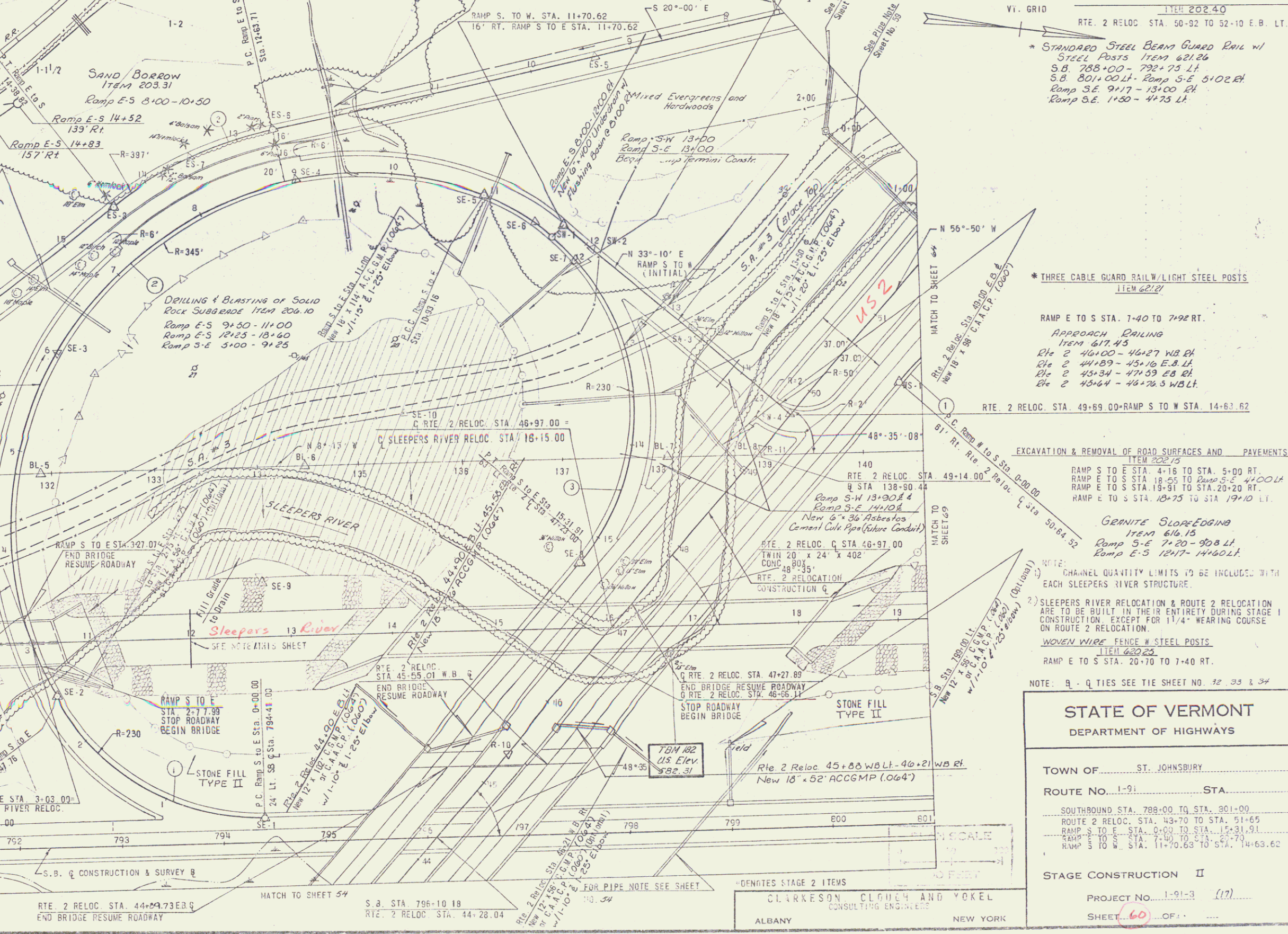

STATE OF VERMONT
 DEPARTMENT OF HIGHWAYS

TOWN OF ST. JOHNSBURY

ROUTE No. 1-91 STA. _____

SOUTHBOUND STA. 788+00 TO STA. 801+00
 ROUTE 2 RELOC. STA. 43+70 TO STA. 51+65
 RAMP S TO E STA. 0+00 TO STA. 15+31.91
 RAMP S TO E STA. 7+50 TO STA. 11+31.70
 RAMP S TO W STA. 11+70.65 TO STA. 14+63.62

STAGE CONSTRUCTION II

PROJECT No. 1-91-3 (17)

SHEET 60 OF 100

DESIGNED BY: C.C.Y.
 TRACED BY: J.L.J.
 CHECKED BY: J.L.J.
 DATE: 10/1/58