

CONTROL OF ACCESS IS COMPLETE ON THIS SHEET.

STONE FILL, TYPE II
ITEM 613.11

N.B. STA. 788+00 TO 792+25 RT.
RTE. 2 RELOC. STA. 39+40 TO 40+50 EB LT.

STONE FILL For Slope Stabilization
Item 613.11
Rte 2 Reloc. 30+00-32+00 W.B. Rt. (Type II)

STANDARD STEEL BEAM GUARD RAIL W/STEEL POSTS
ITEM 621.22

RTE. 2 RELOC. STA. 35+04-40+80 EB LT.
* NB 793+80 TO 794+00 LT.

JUTE MATTING ITEM 654.10
STONE FILL, TYPE I
ITEM 613.11

N.B. STA. 792+25 TO 795+25 RT.
N.B. STA. 788+00 TO 790+00 LT.
N.B. STA. 781+00 TO 785+00 LT.
N.B. STA. 796+50 TO 799+00 LT.
N.B. STA. 800+00 TO 801+00 LT.
RAMP W TO N STA. 11+50 TO 11+50 RT.

* GRANITE SLOPE EDGING
ITEM 616.15
RAMP N TO W 5+45 TO 7+30 LT.
RAMP W TO N 8+65 TO 12+10 LT.

APPROACH RAILING
ITEM 617.45
Rte 2 40+00-41+07 E.B. Lt.
Rte 2 40+39.5-41+52 E.B. Rt.
Rte 2 39+65-41+30 W.B. Lt.
Ramp N-W 10+10 Rt. - Rte 2 42+37 W.B. Rt.

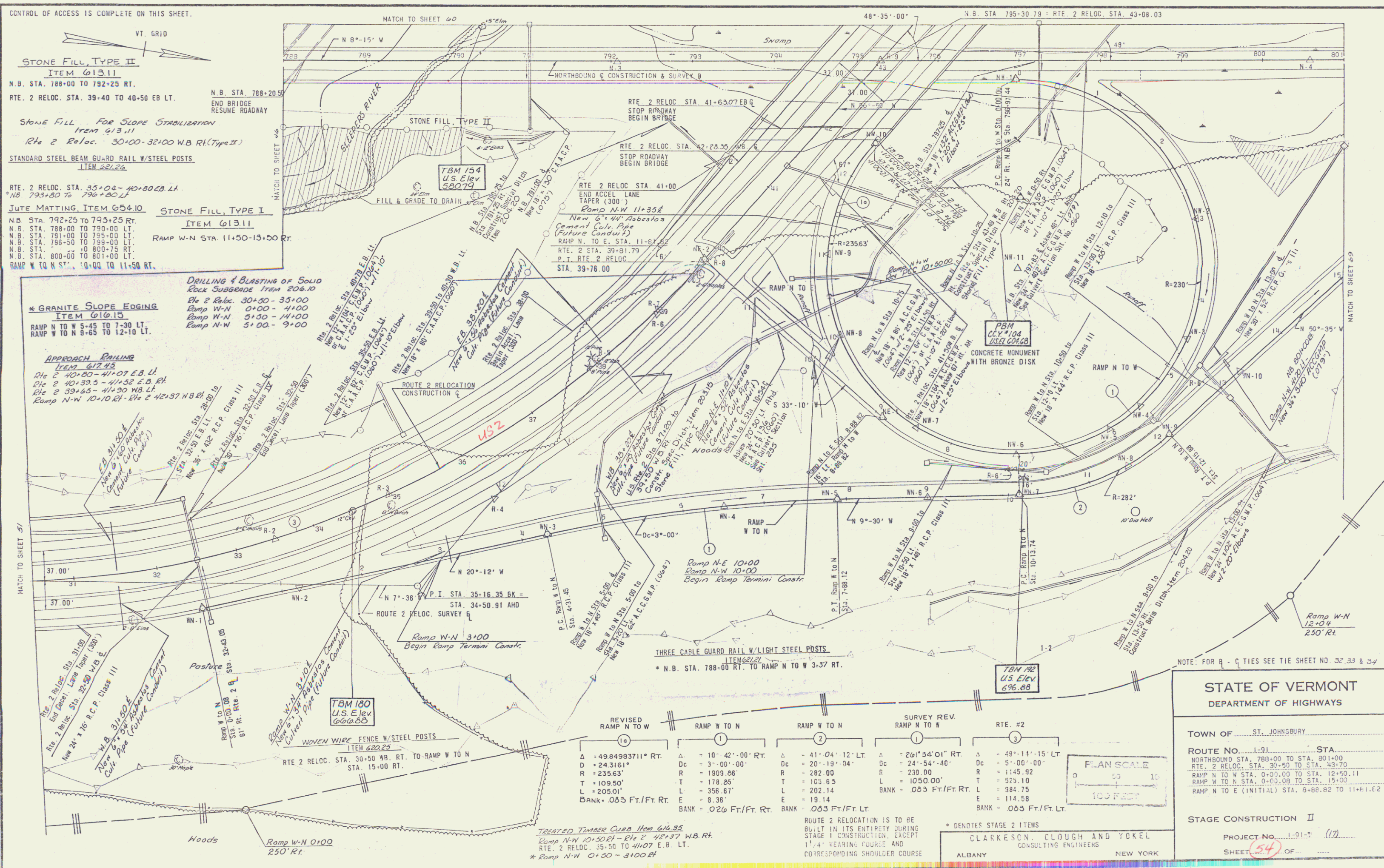

DESIGNED BY: C.C. EX
CHECKED BY: J.M.
DATE: 11/11/77
COMPLETED: 11/11/77

REVISED	RAMP N TO W	RAMP W TO N	RAMP W TO N	SURVEY REV.	RAMP N TO S	RTE. #2
Δ = 4984983711° RT.	Δ = 10° 42' 00" RT.	Δ = 41° 04' 12" LT.	Δ = 261° 34' 01" RT.	Δ = 49° 11' 15" LT.		
D = 243161°	Dc = 3° 00' 00"	Dc = 20° 19' 04"	Dc = 24° 54' 40"	Dc = 5° 00' 00"		
R = 23563°	R = 1909.66'	R = 282.00'	R = 230.00'	R = 1145.92'		
T = 109.50'	T = 178.85'	T = 103.65'	L = 1050.00'	T = 529.10'		
L = 20501'	L = 356.67'	L = 202.14'	BANK = .085 Ft./Ft. RT.	L = 384.75'		
BANK = .085 Ft./Ft. RT.	E = 8.36'	E = 19.14'		L = 114.59'		
	BANK = .026 Ft./Ft. RT.	BANK = .083 Ft./Ft. LT.		BANK = .005 Ft./Ft. LT.		

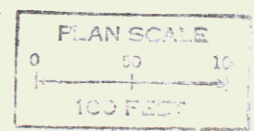

STATE OF VERMONT
DEPARTMENT OF HIGHWAYS

TOWN OF ST. JOHNSBURY
ROUTE No. 1-91 STA. 788+00 TO STA. 801+00
NORTHBOUND STA. 788+00 TO STA. 801+00
RTE. 2 RELOC. STA. 30+50 TO STA. 43+70
RAMP N TO W STA. 0+00.00 TO STA. 12+50.11
RAMP W TO N STA. 0+00.00 TO STA. 15+00
RAMP N TO E (INITIAL) STA. 8+88.82 TO 11+61.62

STAGE CONSTRUCTION II
PROJECT No. 1-91-7 (17)
SHEET (54) OF

* DENOTES STAGE 2 ITEMS
CLARKESON, CLOUGH AND YOKEL
CONSULTING ENGINEERS
ALBANY NEW YORK

ROUTE 2 RELOCATION IS TO BE BUILT IN ITS ENTIRETY DURING STAGE I CONSTRUCTION, EXCEPT 1'4" WEARING COURSE AND CORRESPONDING SHOULDER COURSE

TREATED TIMBER CURB Item 616.35
Ramp N-W 10+50 RT. - Rte 2 42+37 W.B. Rt.
RTE. 2 RELOC. 35+50 TO 41+07 E.B. LT.
* Ramp N-W 0+30 - 3+00 RT.