

No. DEMOLITION & DISPOSAL OF BUILDING CONT'D. No. DEMOLITION & DISPOSAL OF BUILDING CONT'D. No. DEMOLITION & DISPOSAL OF BUILDING CONT'D. APPROACH RAILING EXCAVATION & REMOVAL OF ROAD SURFACES AND PAVEMENTS

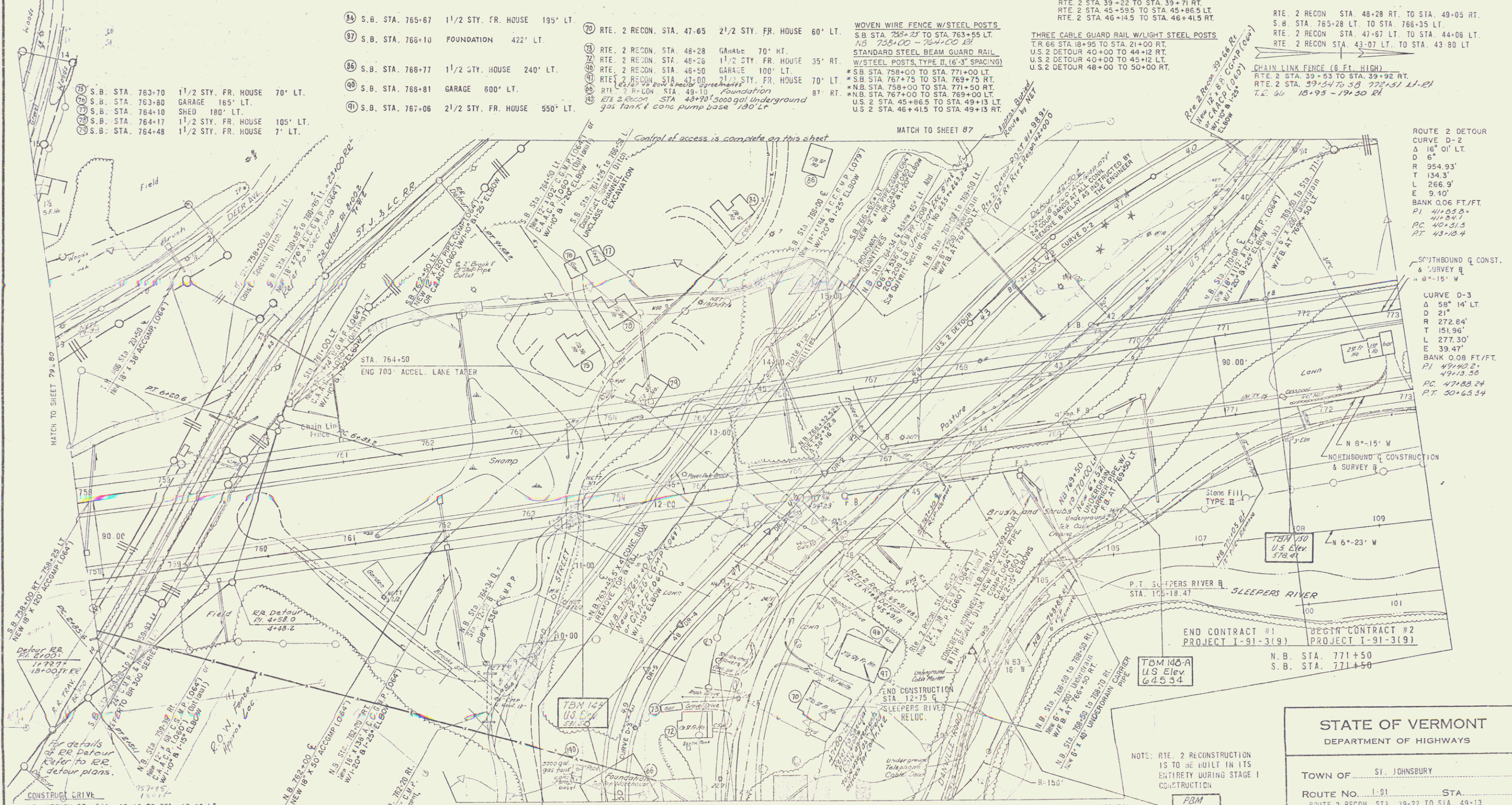

JUTE MATTING
 N.B. STA. 767+00 TO STA. 768+50 RT.
 N.B. STA. 770+50 TO STA. 771+50 LT.
 S.B. STA. 762+75 TO STA. 765+50 LT.
EROSION MATTING
 N.B. STA. 767+00 TO STA. 770+00 LT.
 N.B. STA. 760+00 TO STA. 762+00 LT.
 N.B. STA. 763+00 TO STA. 766+00 LT.
 S.B. STA. 769+50 TO STA. 771+50 LT.
 U.S. 2 STA. 47+50 TO STA. 48+50 LT.

SAND BORROW
 N.B. 766+50 TO 769+50

STONE FILL, TYPE II
 S.B. STA. 765+50 TO STA. 768+58 LT.
 N.B. STA. 759+00 TO STA. 761+50

TREATED TIMBER CURB
 N.B. STA. 758+00 TO STA. 765+40 RT.
 S.B. STA. 758+00 TO STA. 768+50 LT.
 N.B. STA. 768+00 TO STA. 771+50 RT.
 RTE. 2 RECON. STA. 39+00 TO STA. 39+68 RT.

Stone Fill Type I
 S.B. STA. 769+25' - 771+50 LT.

STONE FILL, TYPE II
 S.B. STA. 760+50 TO STA. 762+75 LT.
 N.B. STA. 768+00 TO STA. 771+50 RT.
 S.B. STA. 768+00 TO STA. 769+22 LT.

REMOVAL & DISPOSAL OF EXISTING GUARD RAIL
 N.B. STA. 767-15 TO STA. 762+58 RT.
 S.B. STA. 763-52 RT.
 RTE. 2 RECON. STA. 39+30 TO STA. 44+42 RT.
 RTE. 2 RECON. STA. 40+62 TO STA. 42-10 LT.
 RTE. 2 RECON. STA. 44-24 TO STA. 49+40 LT.

Notes:
 Note: For Unc. Chan. Exc. Refer to Sleepers River Chan. Exc. Chan. X-sections
 Note: For lighting details refer to lighting detail sheet No. _____

Notes:
 RTE. 2 RECONSTRUCTION IS TO BE BUILT IN ITS ENTIRETY DURING STAGE I CONSTRUCTION.
 CLARKESON, CROUCH AND YOXEL CONSULTING ENGINEERS
 ALBANY NEW YORK

STATE OF VERMONT
 DEPARTMENT OF HIGHWAYS

TOWN OF ST. JOHNSBURY

ROUTE No. 191

ROUTE 2 RECON. STA. 19-22 TO STA. 49-13
 NORTHBOUND STA. 758+10 TO STA. 771+50
 SOUTHBOUND STA. 758+00 TO STA. 771+50
 MT. VERNON ST., STA. 14+00 TO STA. 15+00

STAGE CONSTRUCTION II

PROJECT No. 191 (17)

SHEET 85 OF 85