

CONTROL OF ACCESS IS COMPLETE ON THIS SHEET.

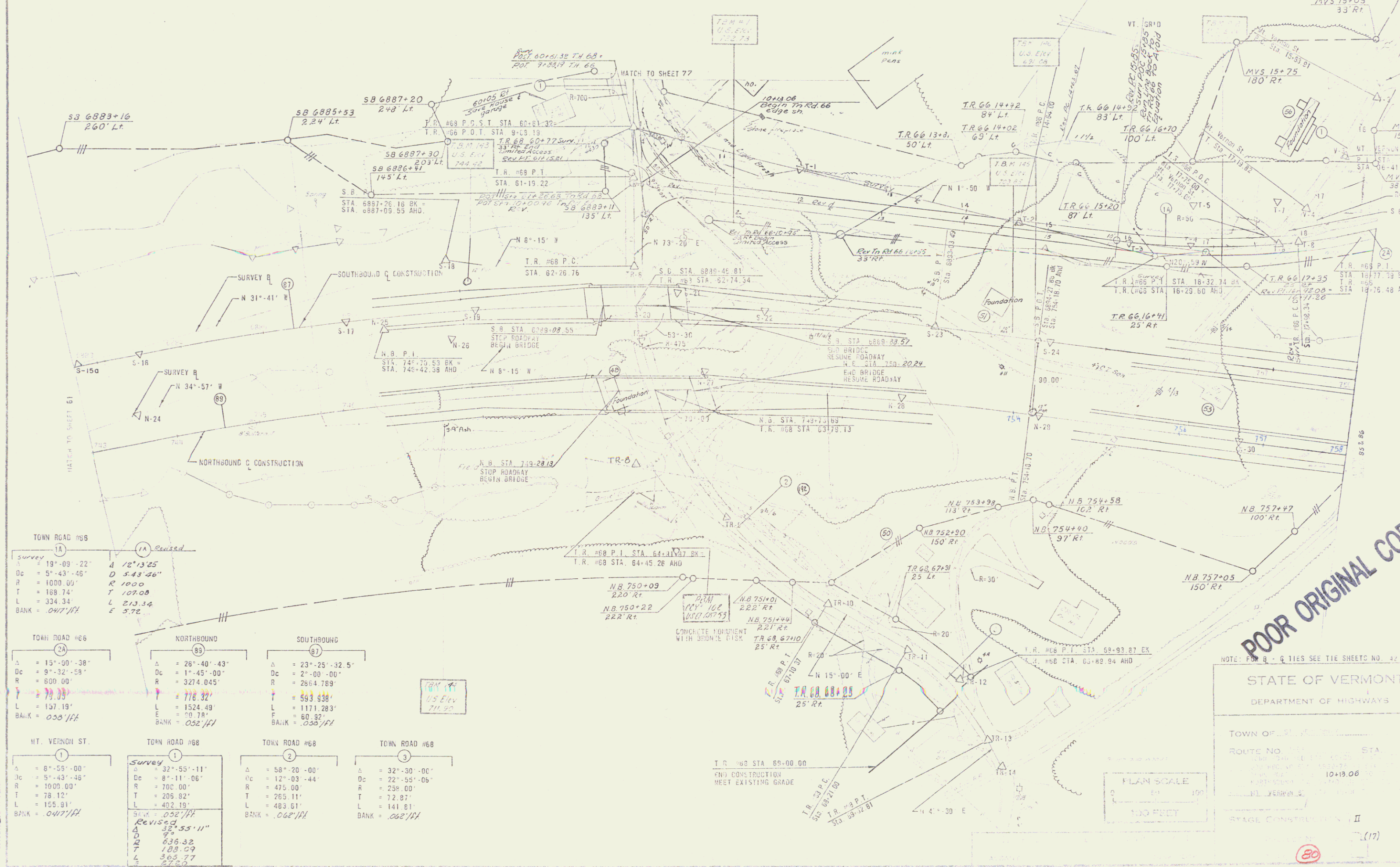

TOWN ROAD #65	TOWN ROAD #66	NORTHBOUND	SOUTHBOUND	MT. VERNOH ST.	TOWN ROAD #68 (1)	TOWN ROAD #68 (2)	TOWN ROAD #68 (3)
Survey $\Delta = 19^{\circ}09'22''$ $Dc = 5^{\circ}43'46''$ $R = 1000.00'$ $T = 168.74'$ $L = 334.34'$ $BANK = .0417/H$	Survey $\Delta = 12^{\circ}13'25''$ $Dc = 1^{\circ}45'00''$ $R = 1000.00'$ $T = 107.08'$ $L = 213.34'$ $E = 3.72'$	$\Delta = 26^{\circ}40'43''$ $Dc = 1^{\circ}45'00''$ $R = 3274.045'$ $L = 718.32'$ $L = 1524.49'$ $E = 10.78'$ $BANK = .032/H$	$\Delta = 23^{\circ}25'32.5''$ $Dc = 2^{\circ}00'00''$ $R = 2864.789'$ $L = 593.938'$ $L = 1171.283'$ $F = 60.32'$ $BANK = .035/H$	$\Delta = 8^{\circ}55'00''$ $Dc = 5^{\circ}43'46''$ $R = 1000.00'$ $T = 78.12'$ $L = 155.91'$ $BANK = .0417/H$	Survey $\Delta = 32^{\circ}55'11''$ $Dc = 8^{\circ}11'06''$ $R = 700.00'$ $T = 205.82'$ $L = 492.19'$ $BANK = .052/H$ Revised $\Delta = 38^{\circ}35'11''$ $Dc = 7^{\circ}59'32''$ $R = 636.32'$ $T = 188.29'$ $L = 369.77'$ $E = 67.20'$	$\Delta = 58^{\circ}20'00''$ $Dc = 12^{\circ}03'44''$ $R = 475.00'$ $T = 265.11'$ $L = 483.61'$ $BANK = .062/H$	$\Delta = 32^{\circ}30'00''$ $Dc = 22^{\circ}55'06''$ $R = 238.00'$ $T = 12.87'$ $L = 141.81'$ $BANK = .002/H$

**POOR ORIGINAL COPY**

NOTE: FOR B & G TIES SEE TIE SHEETS NO. 42 & 43

STATE OF VERMONT  
DEPARTMENT OF HIGHWAYS

TOWN OF ST. ALBANS

ROUTE NO. 100

STATIONING

10+19.06

PLAN SCALE  
1" = 100'

STAGE CONSTRUCTION II