

CONTROL OF ACCESS IS COMPLETE ON THIS SHEET.

No. DEMOLITION & DISPOSAL OF BUILDING

1	N.B. 6861-45	1 1/2 STY. FR. HOUSE 67' RT.
2	N.B. 6862-00	BARN 85' RT.
3	N.B. 6863-21	Shed 125' RT.
4	N.B. 6863-43	Camp 165' RT.

DRILLING AND BLASTING OF SOLID ROCK SUBGRADE
 N.B. 6860+50-6869+00
 S.B. 6857+75-6867+65

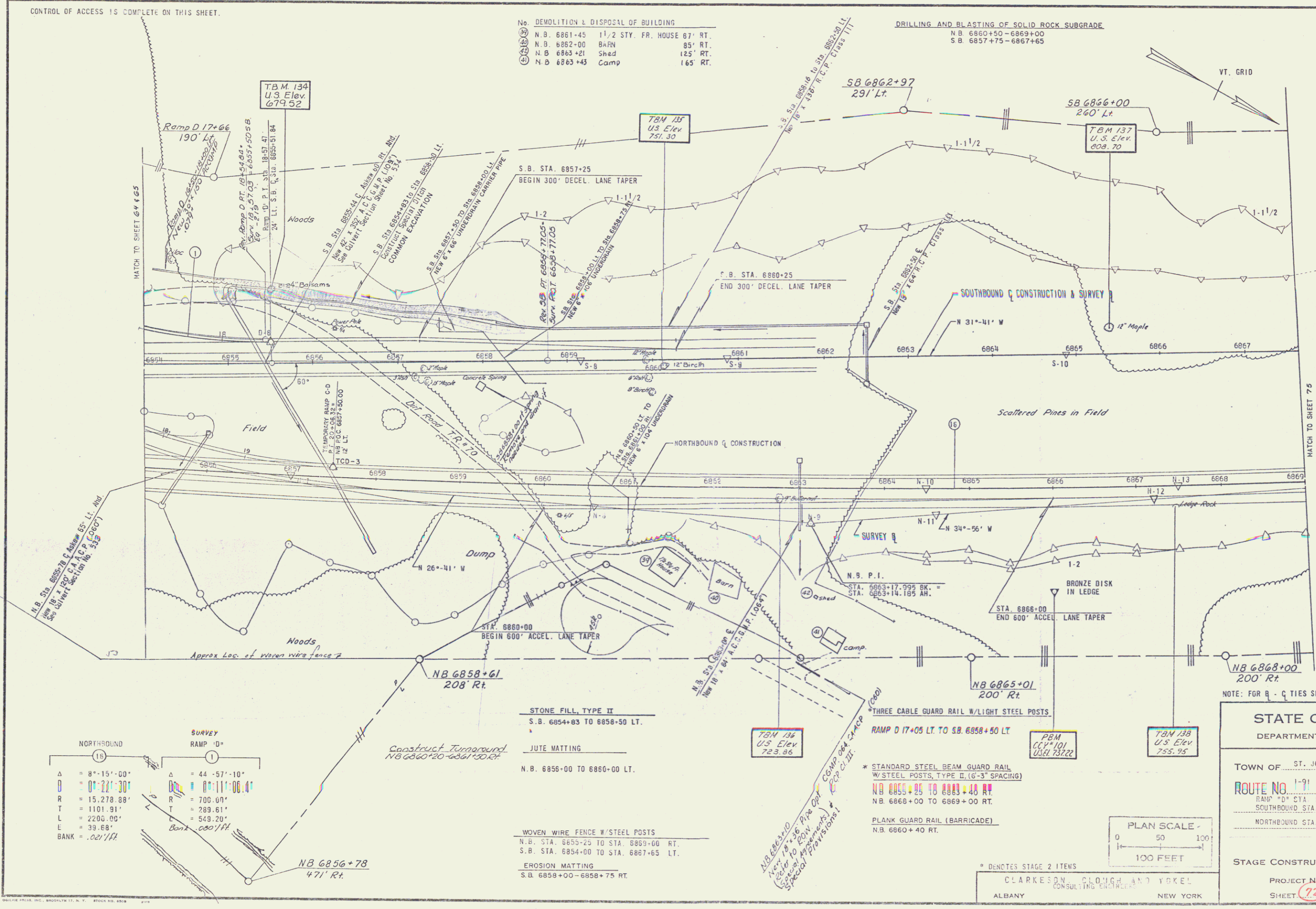

NORTHBOUND		SURVEY RAMP 10°	
Δ	= 8°-15'-00"	Δ	= 44°-57'-10"
D	= 0'-22'-30"	R	= 700.00'
R	= 15.278.88'	T	= 289.61'
T	= 1101.91'	L	= 549.20'
L	= 2200.00'	E	= 39.68'
E	= 39.68'	BANK	= .021/1%

- STONE FILL, TYPE II
S.B. 6854+83 TO 6858+50 LT.
- JUTE MATTING
N.B. 6856+00 TO 6860+00 LT.
- WOVEN WIRE FENCE W/STEEL POSTS
N.B. STA. 6853+25 TO STA. 6859+00 RT.
S.B. STA. 6854+00 TO STA. 6867+65 LT.
- EROSION MATTING
S.B. 6858+00-6858+75 RT.

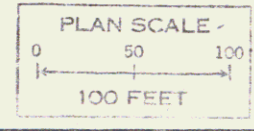

STATE OF VERMONT
 DEPARTMENT OF HIGHWAYS

TOWN OF ST. JOHNSBURY

ROUTE NO. 1-91 STA.

RAMP "D" STA. 17+05 TO STA. 13+57.17
 SOUTHBOUND STA. 6854+00 TO STA. 6857+65
 NORTHBOUND STA. 6855+25 TO STA. 6863+00

STAGE CONSTRUCTION : II

PROJECT NO. 1-91-3 (17)

SHEET 72 OF 78

DESIGNED BY: C.C.V.
 DRAWN BY: J.V.
 CHECKED BY: J.V.
 COMPLETED: 11/11