

ALL DRIVES AS INDICATED ON PLANS ARE SUBJECT TO PERMITS PURSUANT TO TITLE 19, SECTION 43, V.S.A.

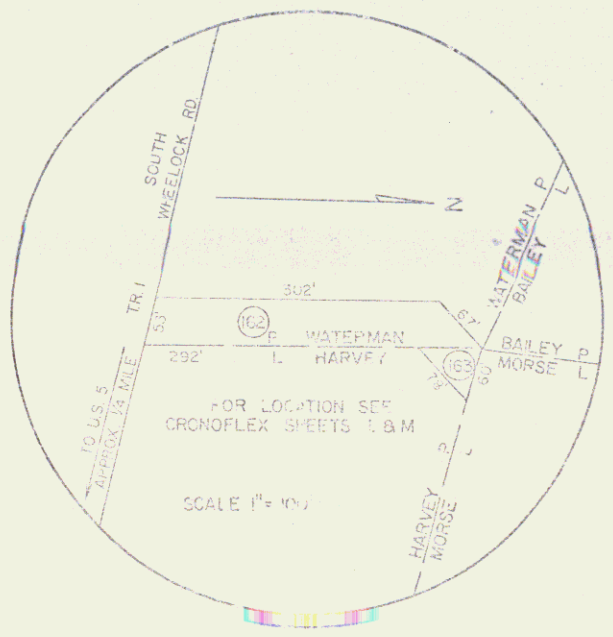

POOR ORIGINAL COPY

STATE OF VERMONT	
DEPARTMENT OF HIGHWAYS	
TOWN OF LYONS	STA.
ROUTE NO. 131	SOUTHBOUND 1155+00 TO 1165+00
	NORTHBOUND 1165+00 TO 1170+00
CONTRACT # 3	STAGE CONSTRUCTION
PROJECT NO. 1-91-209 Sec II	SHEET 92

B.M. 1  
U.S. Elev  
622.41

DESIGNED BY: [illegible]  
DRAWN BY: [illegible]  
CHECKED BY: [illegible]  
DATE: [illegible]