

CONTROL OF ACCESS IS COMPLETE ON THIS SHEET.

NORTHBOUND		SOUTHBOUND	
Δt	= 49'-05'-36"	Δt	= 49'-05'-36"
Δc	= 39'-39'-36"	Δc	= 39'-39'-36"
Δd	= 3'-09'-00"	Δd	= 3'-09'-00"
R	= 1909.36	R	= 1909.36
Tc	= 669.01	Tc	= 669.01
Lc	= 1287.00	Lc	= 1287.00
Ec	= 113.79	Ec	= 113.79
Os	= 5'-15'-00"	Os	= 5'-15'-00"
Ls	= 350.00	Ls	= 350.00
P	= 2.67	P	= 2.67
K	= 174.95	K	= 174.95
Lt	= 233.44	Lt	= 233.44
St	= 116.76	St	= 116.76
Ts	= 1048.76	Ts	= 1048.76
X	= 349.7	X	= 349.7
Y	= 10.58	Y	= 10.58
BANK	= 15/16"/FT. LT.	BANK	= 15/16"/FT. LT.

RAMP "B"		RAMP "D"	
Δ	= 60'-37'-39"	Δ	= 7'-16'-45"
Δc	= 11'-27'-39"	Δc	= 2'-51'-53"
R	= 500	R	= 2000.00
T	= 292	T	= 127.21
L	= 523.88	L	= 254.09
BANK	= 1"/FT. RT.	BANK	= 3/8"/FT. LT.

RAMP "C"	
Δ	= 8'-43'-15"
Δc	= 2'-51'-53"
R	= 2000.00
T	= 15.50
L	= 304.41
BANK	= 9/8"/FT. RT.

SA #10 RELOC.	
Δ	= 40'-00' RT
D	= 9'-45'
R	= 587.95
T	= 219.89
L	= 410.25
REV	
Δ	= 38'-09'-43' RT
D	= 12'-00'
R	= 477.47
T	= 165.08
L	= 317.88
BANK	= 15/16"/FT. RT

SA #10 2.66	
Δ	= 8'-20'-00' LT.
D	= 4'-00'
R	= 1432.40
T	= 104.35
L	= 208.33
BANK	= 1/4"/FT

THREE CABLE GUARD RAIL W/LIGHT STEEL POSTS
ITEM 538
S.B. STA. 1143+50 TO STA. 1148+00 LT.
N.B. STA. 1144+00 TO STA. 1149+45 RT.
RAMP "D" STA. 2+50 TO STA. 7+50 LT.
RAMP "C" STA. 2+30 TO STA. 11+54 RT.
RAMP "B" STA. 0+24 TO STA. 3+12 RT.
RAMP "A" STA. 2+26 TO STA. 6+20 LT.

REVISIONS BY VERMONT HIGHWAY DEPT.
DATE: 11/20/66
BY: [Signature]

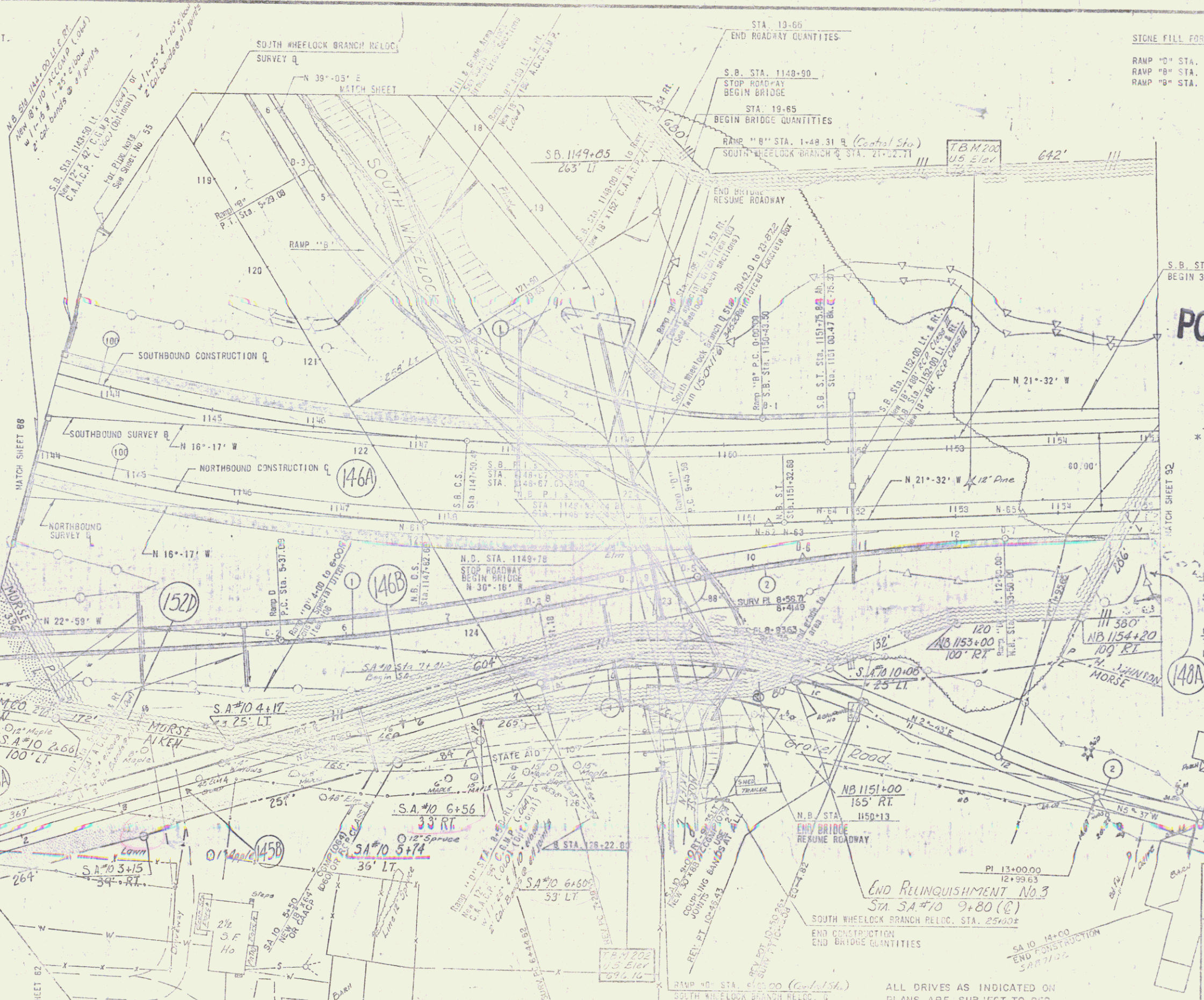

STONE FILL FOR SLOPE PROTECTION (LIGHT TYPE)
ITEM 512
RAMP "D" STA. 8+50 TO 9+45 RT. BRIDGE QUANTITIES
RAMP "B" STA. 1+50 TO 2+35 RT. HIGHWAY QUANTITY
RAMP "C" STA. 0+95 TO 1-53 RT.

S.B. STA. 1154+25
BEGIN 300' DECEL. LANE TAPER

POOR ORIGINAL COPY

JUTE MATTING ITEM 623
* N.B. STA. 1144+00 TO 1151+00 LT.
N.B. STA. 1145+20 TO 1146+00 RT.
S.B. STA. 1146+25 TO 1146+00 LT.

* TREATED TIMBER CURB ITEM 558
S.B. STA. 1143+50 TO 1147+00 LT.
RAMP "D" STA. 2+50 TO 4+50 RT.
RAMP "C" STA. 6+00 TO 7+50 LT.
RAMP "B" STA. 8+50 TO 11+00 RT.

PROPERTY LINE FENCE WITH STEEL POSTS
ITEM 583-11
S.W.B. STA. 18+78 LT. TO S.B. STA. 1155+00 LT.

CHAIN-LINK FENCE (6' HIGH)
T.R. #60. STA. 1+30 LT. TP RAMP "D" STA. 8+80 RT.
RAMP "D" STA. 9+35 RT. TO N.B. STA. 1155+00 RT.

Note: See Sheet BR 1005 For
Control Stationing (B.F. Datum)
for Construction Report

STATE AID NO. AND SOUTH WHEELLOCK BRANCH
RELOCATION ARE TO BE BUILT IN THEIR
ENTIRETY DURING STAGE I CONSTRUCTION.

NOTE: FOR R - C TIES SEE THE SHEETS NO. 30, 31 & 32

STATE OF VERMONT
DEPARTMENT OF HIGHWAYS

TOWN OF ST. JOHNSBURY - LYNDON

ROUTE No. 1-91

SOUTHBOUND 1143+20 TO 1155+00

NORTHBOUND 1144+00 TO 1155+00

STATE AID 1+37 TO 1+40

CONTRACT

STAGE CONSTRUCTION I

Project No. 111(0) 600 I
Sheet 91 of 172

Note: Revisions by Vermont Highway Dept.
(1) R.C. Box Extended under SA #10 (452)
By: [Signature] Chd. by: [Signature]

ALL DRIVES AS INDICATED ON
PLANS ARE SUBJECT TO PER-
MITS PURSUANT TO TITLE 19,
SECTION 43, V.S.A.

* INDICATES GRADE 2 ITEMS

VERMONT HIGHWAY DEPT.
M.B. NY 250 STATE ST. BURLINGTON, VT. 05401