

ACQUIRED AS PARCEL 110E 28.0A± CLYDE R. & RUTH E. WALKER BY W.D.
 DATED APRIL 15, 1971 REC. APRIL 20, 1971 IN BK. 55 PG. 202 IN THE
 TOWN OF LYNDON LAND RECORDS.

ACQUIRED AS PARCEL 111E 9.7 A± ROBERT H. & LORNA M. MASON BY W.D.
 DATED JULY 20, 1971 REC. JULY 30, 1971 IN BK. 55 PG. 307 IN THE TOWN
 OF LYNDON LAND RECORDS.

ACQUIRED AS PARCEL 112D 10.76 A± GEORGE H. BAILEY ESTATE BY ADM.
 DEED DATED NOV. 24, 1971 REC. JAN. 4, 1972 IN BK. 53 PG. 231-233 IN
 THE TOWN OF LYNDON LAND RECORDS.

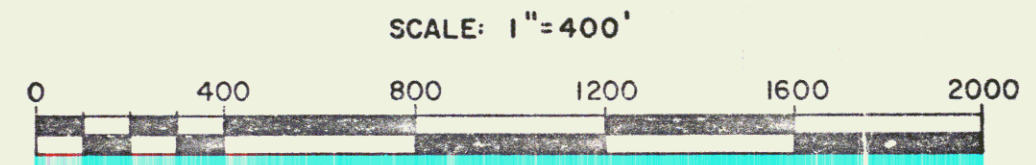
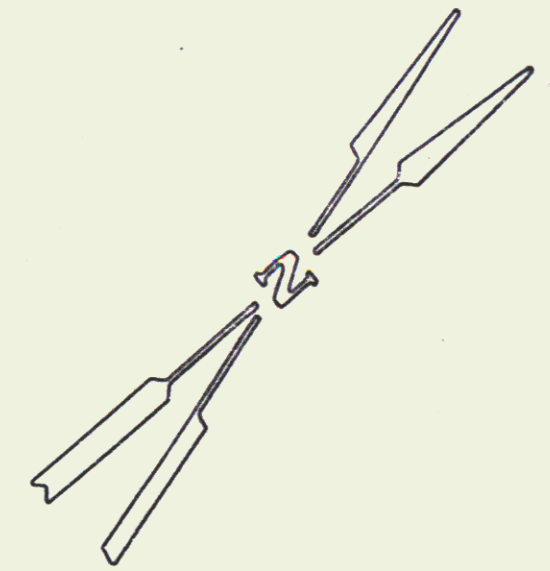
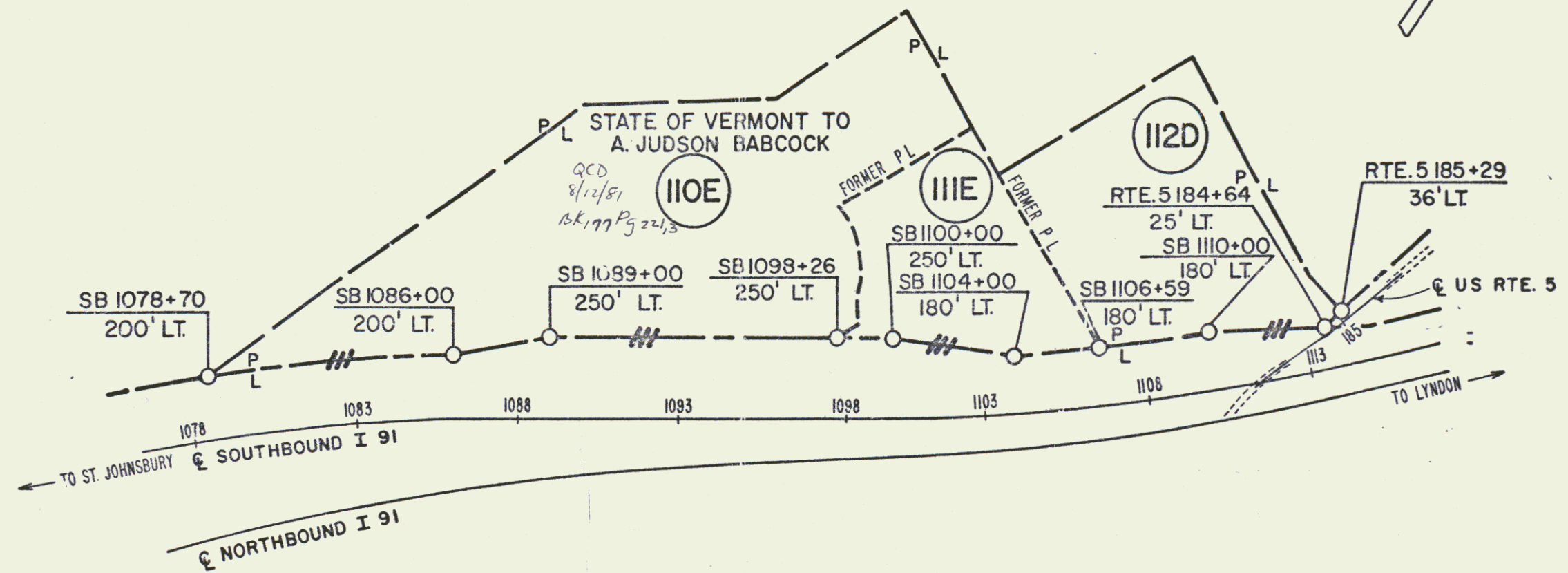

(83A)

CRONO. K & L OF P
 REF. ST. JOHNSBURY-LYNDON SHEETS 83,85 OF 177

**STATE OF VERMONT
 AGENCY OF TRANSPORTATION**

TOWN OF LYNDON

PROJECT I 91-3 (13) SECT. II

APPROX. SCALE 1"=400'	DATE 7/27/81	DRAWN BY B.A.M.
-----------------------	--------------	-----------------