

T.M. 221  
U.S. Elev  
821.46

SOUTHBOUND		NORTHBOUND	
$\Delta = 8^{\circ} 49' 03''$	$\Delta = 8^{\circ} 10' 01''$	$\Delta = 3^{\circ} 47' 23''$	
$Dc = 0^{\circ} 15' 00''$	$Dc = 0^{\circ} 30' 00''$	$Dc = 0^{\circ} 30' 23''$	
$R = 22,918.31$	$R = 11,459.10$	$R = 11,316.61$	
$T = 1770.13$	$T = 818.08$	$T = 850.14$	
$L = 3533.29$	$L = 1633.39$	$L = 1933.59$	
$E = 68.26$	$E = 29.16$	$E = 41.42$	
BANK = 1/4 FT. LT. BANK = 1/4 FT. LT.		BANK = 1/4 FT. LT.	

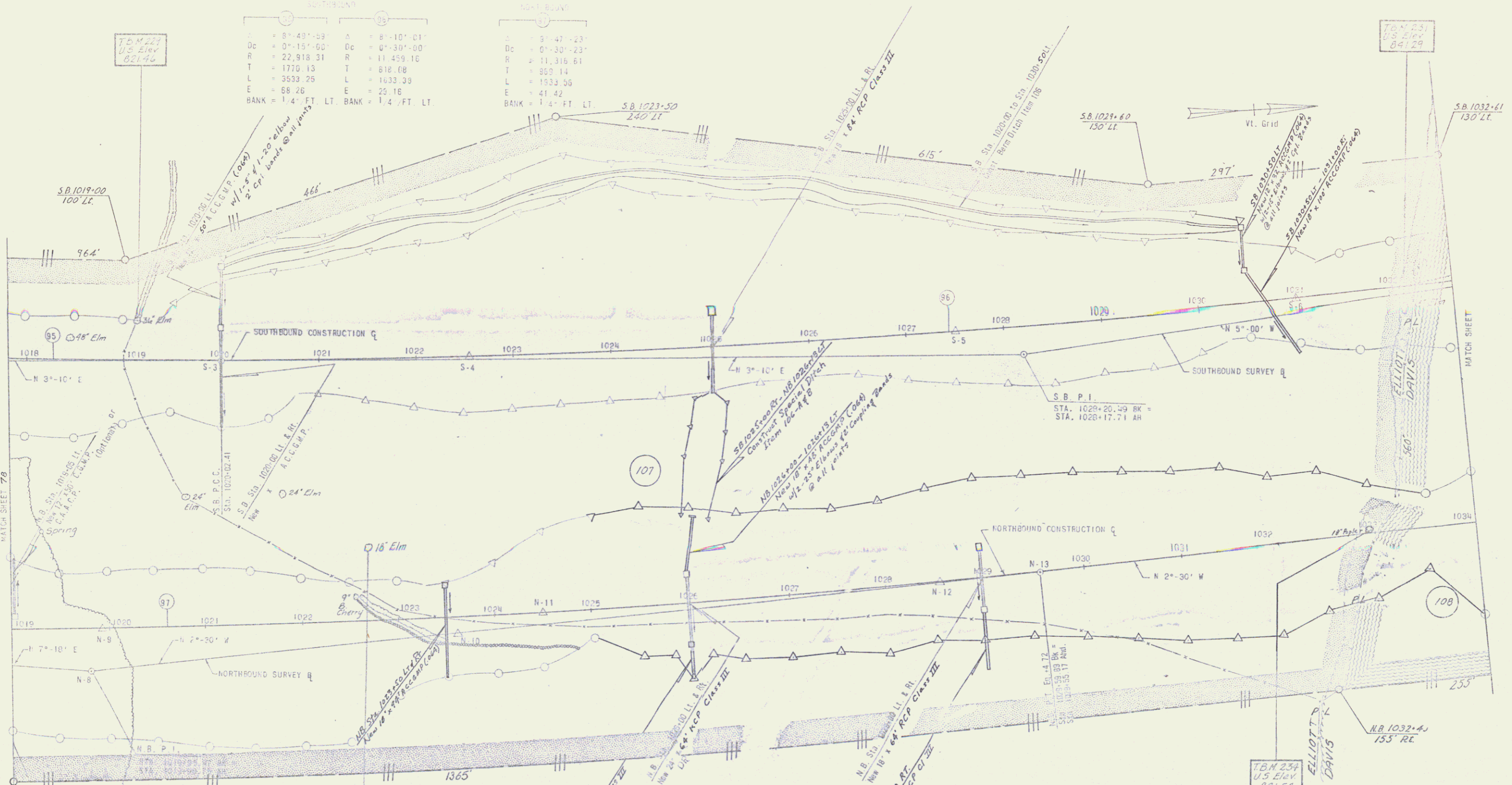

MATCH SHEET 79

MATCH SHEET

POOR ORIGINAL COPY

STATE OF VERMONT  
DEPARTMENT OF HIGHWAYS

TOWN OF ST. JOHNSBURY

ROUTE No. 1-91 STA.

SOUTHBOUND 1017+00 TO 1032+60

NORTHBOUND 1019+00 TO 1034+00

CONTRACT # 4

STAGE CONSTRUCTION I

PROJECT No. 1-91-303 Sec. II

SHEET 72 OF 77

CLARKSON, DUDMAN AND FURR  
ALBANY NEW YORK