

POOR ORIGINAL COPY

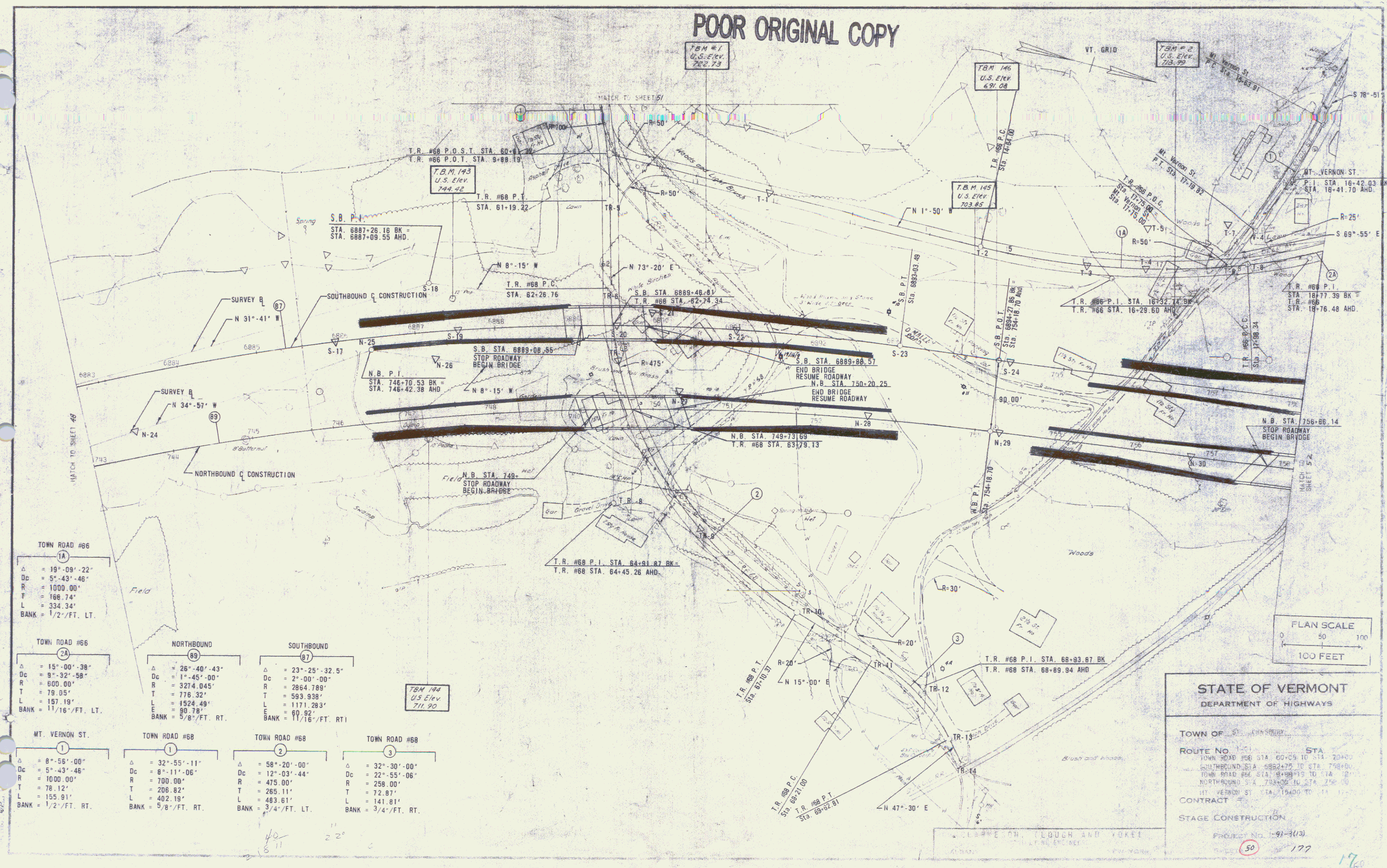

TOWN ROAD #66
 (1A)
 $\Delta = 19^{\circ}-09'-22''$
 $Dc = 5^{\circ}-43'-46''$
 $R = 1000.00'$
 $T = 168.74'$
 $L = 334.34'$
 BANK = $1/2$ "/FT. LT.

TOWN ROAD #66
 (2A)
 $\Delta = 15^{\circ}-00'-38''$
 $Dc = 9^{\circ}-32'-58''$
 $R = 600.00'$
 $T = 79.05'$
 $L = 157.19'$
 BANK = $1/16$ "/FT. LT.

NORTHBOUND
 (89)
 $\Delta = 26^{\circ}-40'-43''$
 $Dc = 1^{\circ}-45'-00''$
 $R = 3274.045'$
 $T = 776.32'$
 $L = 1524.49'$
 $E = 80.78'$
 BANK = $5/8$ "/FT. RT.

SOUTHBOUND
 (87)
 $\Delta = 23^{\circ}-25'-32.5''$
 $Dc = 2^{\circ}-00'-00''$
 $R = 2864.789'$
 $T = 593.938'$
 $L = 1171.283'$
 $E = 60.92'$
 BANK = $1/16$ "/FT. RT.

MT. VERNON ST.
 (1)
 $\Delta = 8^{\circ}-55'-00''$
 $Dc = 5^{\circ}-43'-46''$
 $R = 1000.00'$
 $T = 76.12'$
 $L = 155.91'$
 BANK = $1/2$ "/FT. RT.

TOWN ROAD #68
 (1)
 $\Delta = 32^{\circ}-55'-11''$
 $Dc = 8^{\circ}-11'-06''$
 $R = 700.00'$
 $T = 208.82'$
 $L = 402.19'$
 BANK = $5/8$ "/FT. RT.

TOWN ROAD #68
 (2)
 $\Delta = 58^{\circ}-20'-00''$
 $Dc = 12^{\circ}-03'-44''$
 $R = 475.00'$
 $T = 285.11'$
 $L = 493.61'$
 BANK = $3/4$ "/FT. LT.

TOWN ROAD #68
 (3)
 $\Delta = 32^{\circ}-30'-00''$
 $Dc = 22^{\circ}-55'-06''$
 $R = 258.00'$
 $T = 72.87'$
 $L = 141.81'$
 BANK = $3/4$ "/FT. RT.

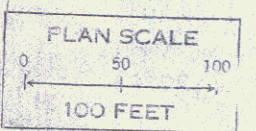

STATE OF VERMONT
 DEPARTMENT OF HIGHWAYS

TOWN OF ... CHANDLER

ROUTE No. 101

STA. 60+00 TO STA. 20+00

SOUTHBOUND STA. 68+27.10 TO STA. 798+00

TOWN ROAD #66 STA. 8+98+19 TO STA. 12+00

NORTHBOUND STA. 793+00 TO STA. 256+00

MT. VERNON ST. STA. 19+00 TO STA. 11+00

CONTRACT No. 1-91-3(13)

STAGE CONSTRUCTION

PROJECT No. 1-91-3(13)

50 177