

CONTROL OF ACCESS IS COMPLETE ON THIS SHEET

*ILLUMINIOUS CURBSIDE LIGHT ITEM 822
S.B. STA. 6701+00 TO STA. 6703+50 RT.
S.B. STA. 6706+00 TO STA. 6708+50 RT.
S.B. STA. 6714+50 TO STA. 6716+00 LT.

Diagram of Drive Signs (Item 823)
S. Signal Posts (Item 824)
NB 6698+00-6718+00 LT.
SB 6701+00-6716+00 LT.

PLANK ROAD RAIL
ITEM 840
S.B. STA. 6706+25 LT.

*THREE CARL MARLER PAIS 6" x 12" STEEL POSTS
ITEM 827
S.B. STA. 6725+00 TO STA. 6715+00 RT.

ALL DRIVES AS INDICATED ON
PLANS ARE SUBJECT TO PER-
MITS PURSUANT TO TITLE 19,
SECTION 43, V.S.A.

Henry A. & Mildred T. Denio

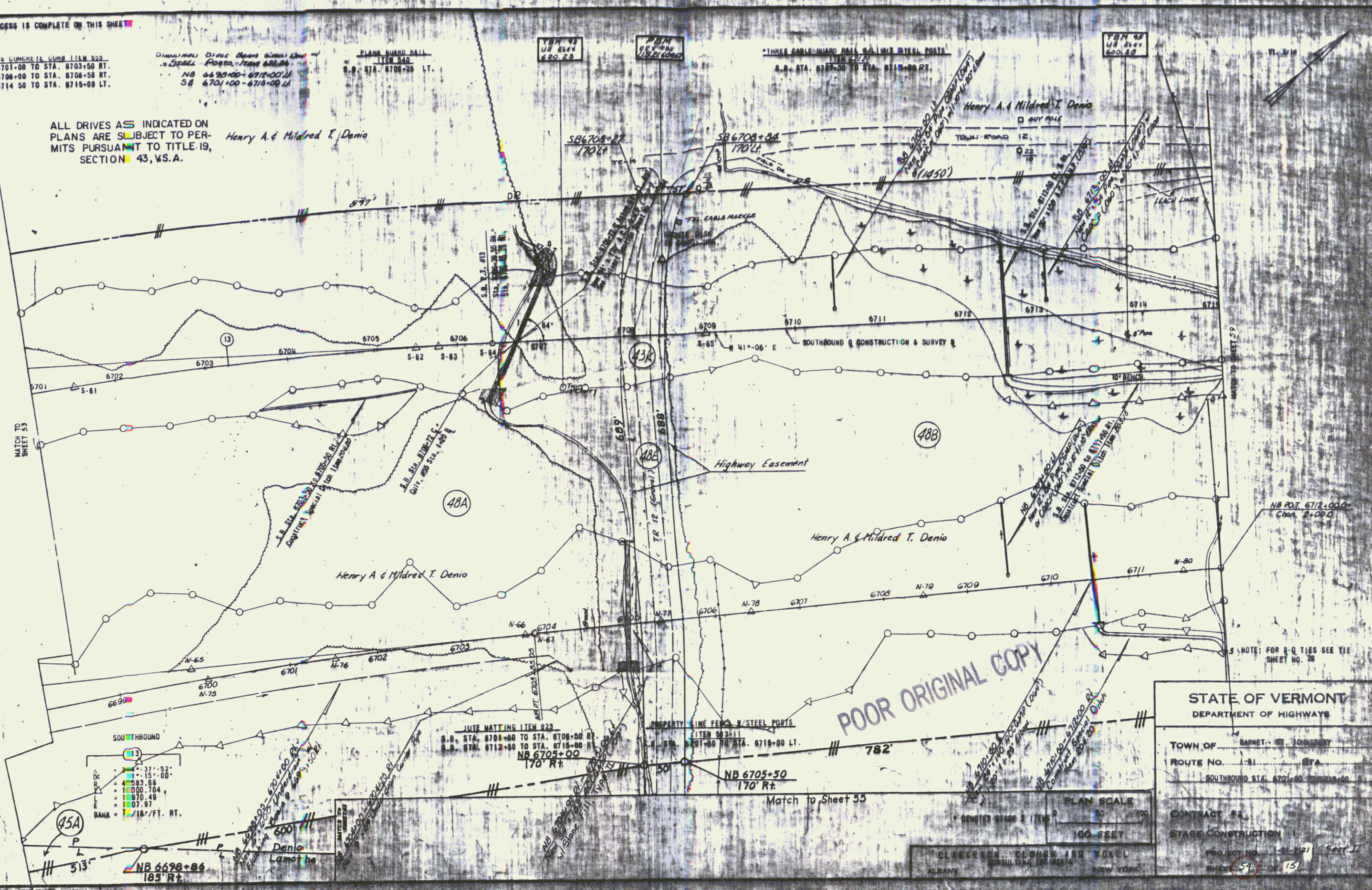

MATCH TO SHEET 53

MATCH TO SHEET 59

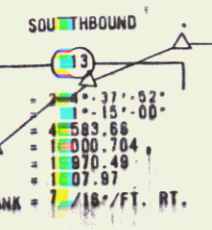

ROUTE MARKING ITEM 823
S.B. STA. 6708+00 TO STA. 6708+50 RT.
S.B. STA. 6712+00 TO STA. 6716+00 RT.
NB 6703+00
170' RT.

PROPERTY LINE FENCE W/ STEEL POSTS
ITEM 824
S.B. STA. 6707+00 TO STA. 6716+00 LT.

NB 6705+50
170' RT.

Match to Sheet 55

STATE OF VERMONT
DEPARTMENT OF HIGHWAYS

TOWN OF BARNET, W. JOHNSBURY
ROUTE NO. 131
SOUTHBOUND STA. 6701+00 TO STA. 6716+00

CONTRACT 84
STAGE CONSTRUCTION
PROJECT NO. 131-81 Part 1
SHEET 54 OF 15

PLAN SCALE
1" = 100 FEET

ALBANY NEW YORK