

FORMERLY PARCEL 41B RUSSELL A. & RUTH S. WHELOCK ACQUIRED
 BY W.D. DATED APRIL 17, 1972. REC. APRIL 25, 1972 IN BK. 55 PG. 487
 IN THE TOWN OF BARNET LAND RECORDS

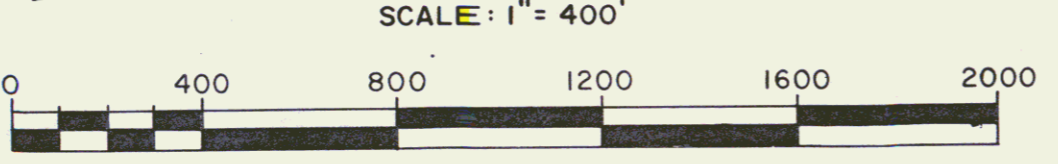
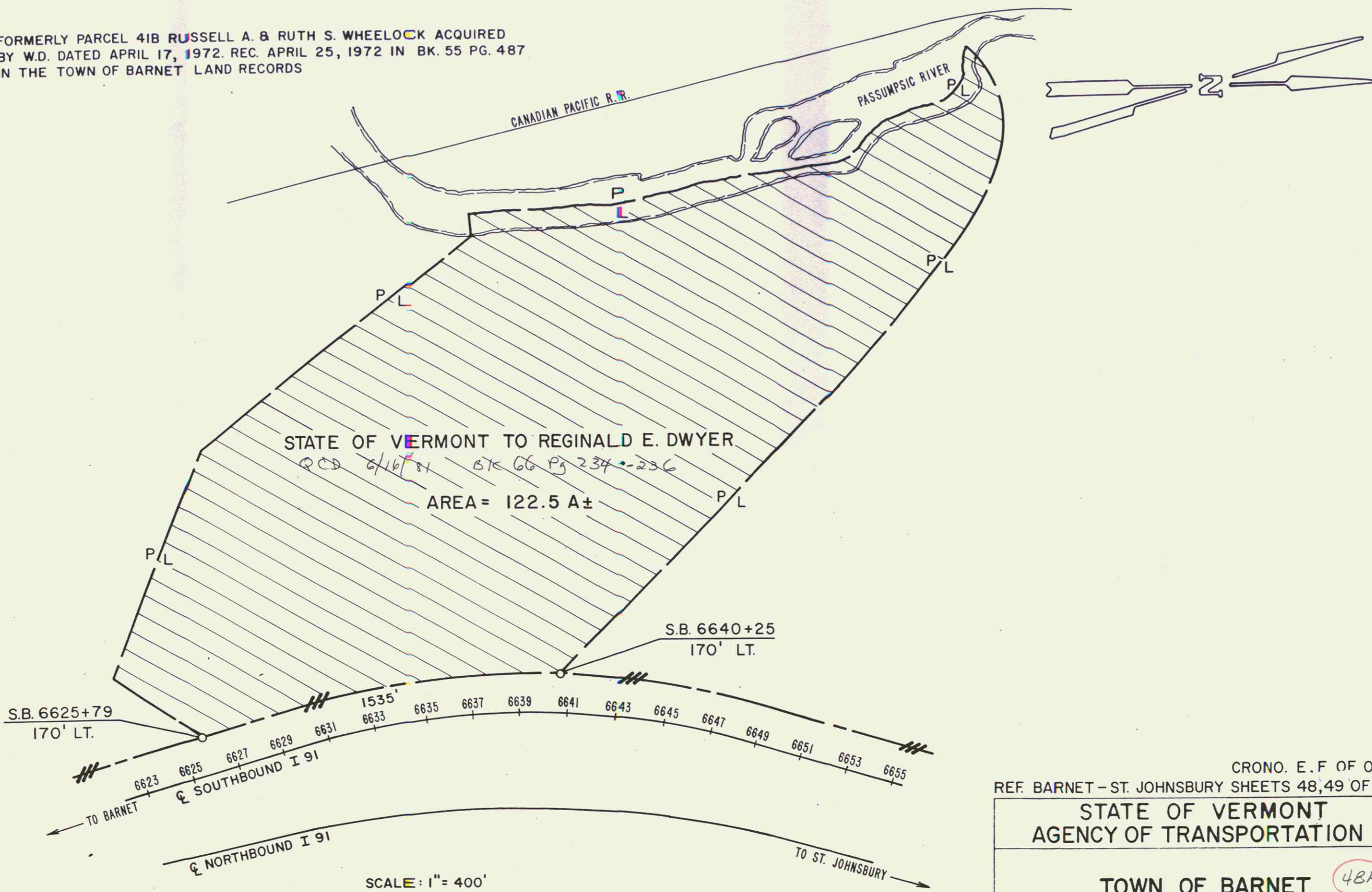

CRONO. E. F OF O
 REF. BARNET - ST. JOHNSBURY SHEETS 48, 49 OF 151

STATE OF VERMONT
 AGENCY OF TRANSPORTATION

TOWN OF BARNET (48A)

PROJECT I 91 - 2 (21) SECT. II

APPROX SCALE 1"=400'	DATE 6/4/81	DRAWN BY B.A.M.
----------------------	-------------	-----------------

40