

SB 6405+20 282' LT  
BEGIN ROW PROJECT  
I-91-2(21) Sect. I  
Q1091-2(47) Sect. I

Ramp B' 16+70  
163' RT  
Stevens River Reloc. 1+00  
140' RT

S.B. STA. 6404+00.00  
RAMP B STA. 15+73.74 RT  
S.B. STA. 639+36.54 RT  
END PROJECT I-91-2(16)  
CONTRACT #4  
BEGIN PROJECT I-91-2(21)  
CONTRACT #1

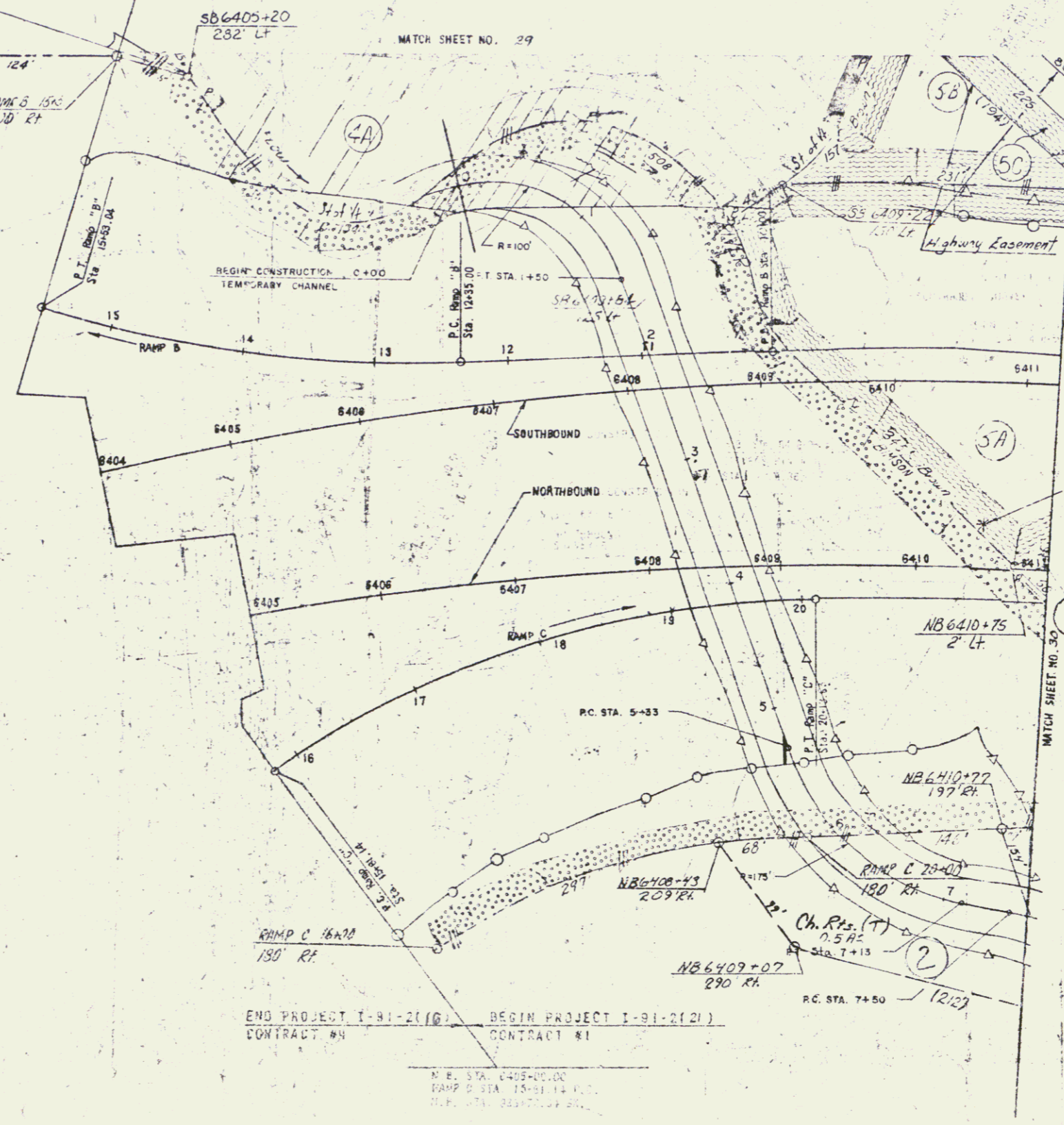

90A  
90C

Connecticut River Lodge No 7  
Independent Order of Old  
Follows A Fraternal Organization

11B

END PROJECT I-91-2(16)  
CONTRACT #4  
BEGIN PROJECT I-91-2(21)  
CONTRACT #1

M.E. STA. 6405+00.00  
RAMP C STA. 15+81.14 RT  
M.P. STA. 639+77.04 RT

POOR ORIGINAL COPY

STATE OF VERMONT  
TOWN OF BARNET - ST. JOHNSBURY  
PROJECT NO. 1-91-2(21) Q1091-2(47)  
SHEET 28 OF 102

2 JAN 10 1984