

ALL OF ADDRESS IS COMPLETE ON THIS SHEET.

- *THREE RAIL GUARD RAIL W/ LIGHT STEEL POSTS
ITEM 532
RAMP "A" STA. 15+53 RT. TO S.B. STA. 8411+25 LT.
RAMP "C" STA. 15+81 RT. TO N.B. STA. 8411+00 RT.
- *EXCAVATION AND REMOVAL OF ROAD SURFACES
AND/OR PAVEMENTS ITEM 119
S.B. STA. 8410+00 TO STA. 8411+25 LT.
- *GRANITE SLOPE EDGING ITEM 556-A
S.B. STA. 8406+59 TO STA. 8506+11 LT.
RAMP "B" STA. 13+04 TO STA. 13+55 S. LT.
- PROPERTY LINE FENCE WITH STEEL POSTS
ITEM 563-11
RAMP "B" STA. 15+53 RT. TO S.B. STA. 8409+25 LT.
RAMP "C" STA. 18+00 RT. TO N.B. STA. 8410+87 RT.
S.B. STA. 8408+92 TO STA. 8411+25 LT.

RAMP B		RAMP C	
Δc = 18°-13'-22"	Δc = 35°-23'-58"	Δc = 35°-23'-58"	Δc = 35°-23'-58"
Dc = 5'-43'-47"	Dc = 8'-11'-06"	Dc = 8'-11'-06"	Dc = 8'-11'-06"
R = 10000.00	R = 700.00	R = 700.00	R = 700.00
T = 1800.93	T = 723.40	T = 723.40	T = 723.40
L = 3003.05	L = 432.49	L = 432.49	L = 432.49
BANK = 1'-2'-FT. RT.	BANK = 1'-FT. RT.	BANK = 1'-FT. RT.	BANK = 1'-FT. RT.

NORTHBOUND		SOUTHBOUND	
Δc = 27°-32'-08"	Δc = 34°-11'-44"	Δc = 34°-11'-44"	Δc = 34°-11'-44"
Dc = 2'-20'-00"	Dc = 2'-15'-00"	Dc = 2'-15'-00"	Dc = 2'-15'-00"
R = 2400.81	R = 2046.48	R = 2046.48	R = 2046.48
T = 600.74	T = 795.47	T = 795.47	T = 795.47
L = 1100.10	L = 1542.03	L = 1542.03	L = 1542.03
E = 72'-65"	E = 121.36	E = 121.36	E = 121.36
BANK = 3'-FT. RT.	BANK = 3'-FT. RT.	BANK = 3'-FT. RT.	BANK = 3'-FT. RT.

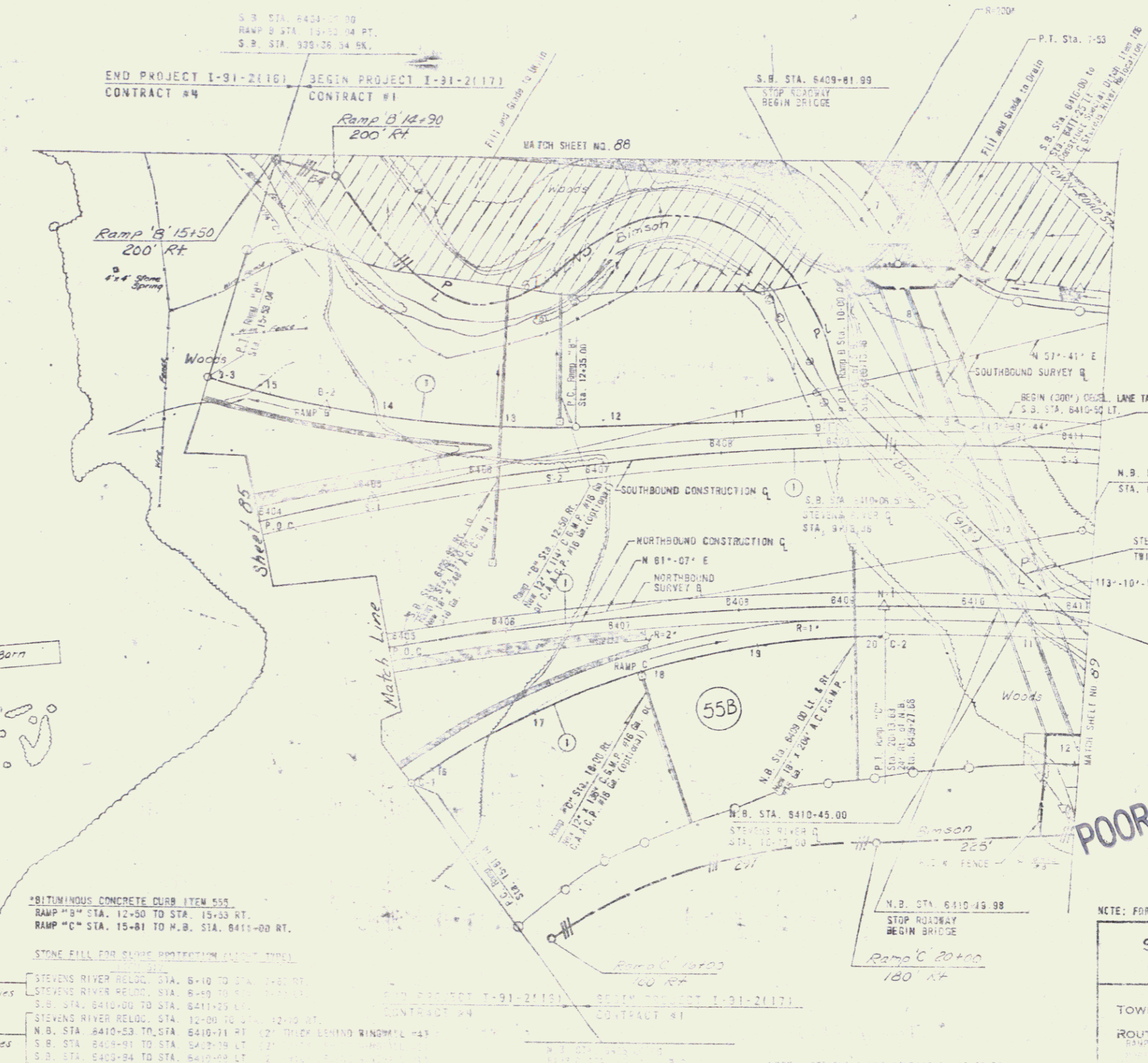

*BITUMINOUS CONCRETE CURB ITEM 555
RAMP "B" STA. 12+50 TO STA. 15+53 RT.
RAMP "C" STA. 15+81 TO N.B. STA. 8411+00 RT.

STONE FILL FOR EROSION PROTECTION QUANTITIES

Bridge	Quantities	STEVENS RIVER RELOC. STA. 8+10 TO STA. 12+00 RT.
Bridge	Quantities	STEVENS RIVER RELOC. STA. 8+40 TO STA. 12+00 RT.
Bridge	Quantities	S.B. STA. 8410+00 TO STA. 8411+25 LT.
Bridge	Quantities	STEVENS RIVER RELOC. STA. 12+00 TO STA. 12+10 RT.
Bridge	Quantities	N.B. STA. 8410+53 TO STA. 8410+11 RT. (27' TRUCK BEHIND RINGWALL #43)
Bridge	Quantities	S.B. STA. 8409+91 TO STA. 8409+19 LT. (27' TRUCK BEHIND RINGWALL #43)
Bridge	Quantities	S.B. STA. 8408+94 TO STA. 8409+19 LT.

POOR ORIGINAL COPY

NOTE: FOR R, D, TIES SEE THE SHEET NO. 87 & 88

STATE OF VERMONT
DEPARTMENT OF HIGHWAYS

TOWN OF Ryegate-Barre

ROUTE NO. 1-91

RAMP "B" STA. 12+50 TO STA. 15+53 RT.
RAMP "C" STA. 15+81 TO N.B. STA. 8411+00 RT.
RAMP "E" STA. 18+00 TO STA. 18+00 RT.
CONTRACT # 1

STAGE CONSTRUCTION 1

PROJECT NO. 1-91-01201

87