

DRILLING & BLASTING OF SOLID  
ROCK SURGRADE - ITEM 115  
NB Sta 920+25 - 924+50  
SB Sta 921+75 - 925+00

SB SPIRAL DATA

Ca	21.15'
La	200.00'
P	0.65'
K	39.39'
Xc	139.97'
Yc	2.62'
Ts	1743.78'

RAMP A CURVE DATA

S	151.52'-57" RI
D	21-17'-30"
R	2500.00'
T	348.74'
L	639.00'
E	24.21'
Bank	1/4" FT
PI	N 655,199.787
E	613,294.142

RAMP D CURVE DATA

S	251-11'-43" RI
D	31-19'-11"
R	1800.00'
T	335.82'
L	659.61'
E	37.00'
Bank	3/4" FT
PI	N 654,912.991
E	613,313.787

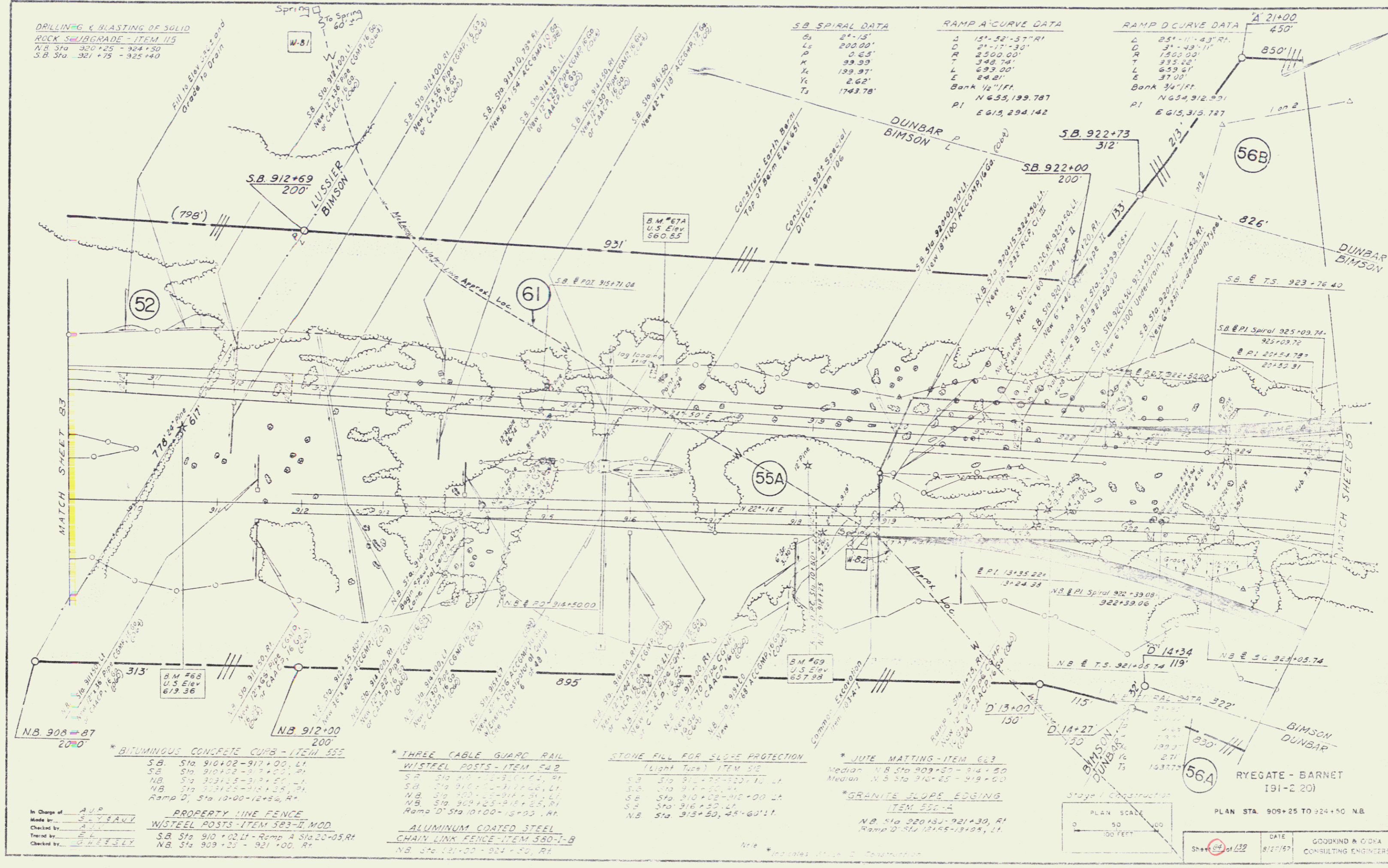

\* BITUMINOUS CONCRETE CURB - ITEM 555

SB Sta	910+02-917+00, LI
SB Sta	910+02-917+00, RI
NB Sta	909+25-912+50, LI
NB Sta	909+25-912+50, RI
Ramp D	Sta 10+00-12+50, RI

\* THREE CABLE GUARD RAIL  
W/STEEL POSTS - ITEM 542

SB Sta	910+02-917+00, RI
SB Sta	910+02-917+00, LI
NB Sta	909+25-912+50, LI
NB Sta	909+25-912+50, RI
Ramp D	Sta 10+00-12+50, RI

STONE FILL FOR SLOPE PROTECTION  
(Light Taper) ITEM 52

SB Sta	910+02-917+00, LI
SB Sta	910+02-917+00, RI
NB Sta	910+02-912+50, LI
NB Sta	910+02-912+50, RI
NB Sta	916+50, LI
NB Sta	916+50, RI
NB Sta	915+50, 45'-60" LI

\* JUTE MATTING - ITEM 623

Median	NB Sta 909+50 - 914+50
Median	NB Sta 910+25 - 919+50

\* GRANITE SLOPE EDGING  
ITEM 556-A

NB Sta	920+50-921+30, RI
Ramp D	Sta 10+00-12+50, RI

PROPERTY LINE FENCE  
W/STEEL POSTS - ITEM 583-II MOD

SB Sta	910+02 LI - Ramp A Sta 20+05, RI
NB Sta	909+25 - 921+00, RI

ALUMINUM COATED STEEL  
CHAIN LINK FENCE - ITEM 580-J-B

NB Sta	921+00 - 924+50, RI
--------	---------------------

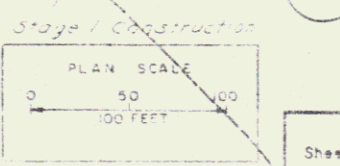

Sheet 04 of 132 DATE 8/20/97 GOODKIND & ODKA CONSULTING ENGINEERS