

Stone Fill, Type II
 SB 5864+39 LT - 5869+0 LT
 C/L 17+75-24+90 Rt. Lt. (Bridge Quant.)
 NB 5867+60 - 5871+00 Rt. (Rdwy Quant.)
 8+50

Stone Fill, Type I
 SB 5864+95 - 5865+05 Lt.
 SB 5866+95 - 5867+05 Lt.
 Use Type II at above Sta.

Woven Wire Fence w/ Steel Posts
 JB 5864+39 - 5871+0 Lt.
 NB 5864+39 - 5871+0 Rt.

Topsoil Stockpiles
 W 5865+0 - 5867+0 Lt. (1000 yd)

Sta 17+75 (Channel)
 Begin Construction
 Wells River Reloc.

Utility Marking
 JB 5863+10 - 5868+35 Lt.

Station	Use	Remarks
Wells E. 17+90	lt	Farm Drive

***Treated Timber Curb**
 JB 5864+00 - 5875+40 Lt.
 NB 5864+00 - 5865+10 Rt.

Guard Rail - Plank w/ Wood Posts
 NB 5867+80 Rt.
 SB 5871+03 Lt.

***Guard Rail - Standard Steel Beam**
 TYPE II (6-3 SPACING)
 SB 5864+77 - 5871+00 Lt.
 NB 5864+77 - 5870+30 Rt.
 NB 5860+96 - SB 5860+96
 NB 5864+50 - SB 5864+50

***Approach Railings (2 Rail Aluminum)**
 NB 5864+50 - 5864+77 Rt.
 NB 5864+50 - 5865+63 Lt.
 S. D. 5864+50 - 5866+95 Rt.
 S. D. 5864+50 - 5864+95 Lt.

DATE	BY	REVISION

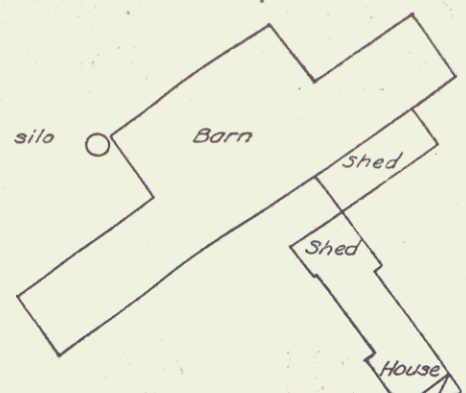
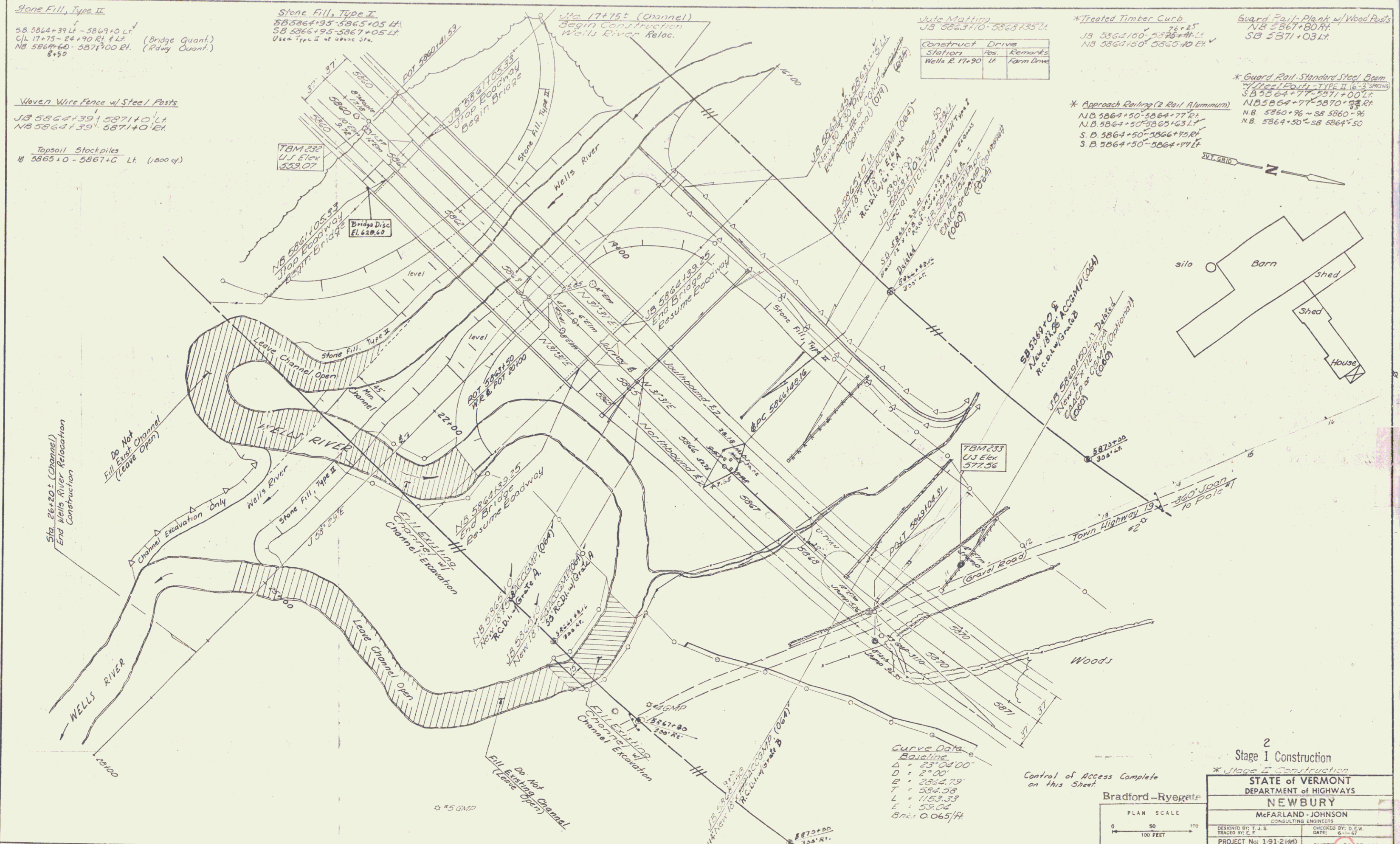

Curve Data
 BOLDING
 Δ = 23° 04' 00"
 D = 27.00'
 E = 2862.79'
 T = 584.58'
 L = 1153.33'
 E = 59.04'
 Brk = 0.065/ft

Control of Access Complete on this Sheet.

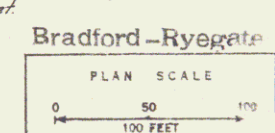

2
 Stage I Construction
 * Stage II Construction

STATE OF VERMONT
 DEPARTMENT OF HIGHWAYS

NEWBURY
 McFARLAND-JOHNSON
 CONSULTING ENGINEERS

DESIGNED BY: J. S. McFARLAND	CHECKED BY: D. E. W. JOHNSON
DATE: 6-11-47	DATE: 6-11-47
PROJECT No: 1-91-2(40)	SHEET 27 OF 28

R.O.W/const 144