

Woven Wire Fence w/ Steel Posts  
Rte. 302 - 94' LT Ramp 'B' 6+00 RT

Sand Parrow  
NB 5844+00 - 5849+00  
SB 5844+00 - 5846+60

Drilling & Blasting of Solid Rock Subgrade  
NB 5844+00 - 5849+00  
SB 5844+00 - 5846+60

Removal & Disposal of Present  
Road Mail Rte 302  
983+65 ~ 984+11 Lt.  
983+65 ~ 984+11 Lt.

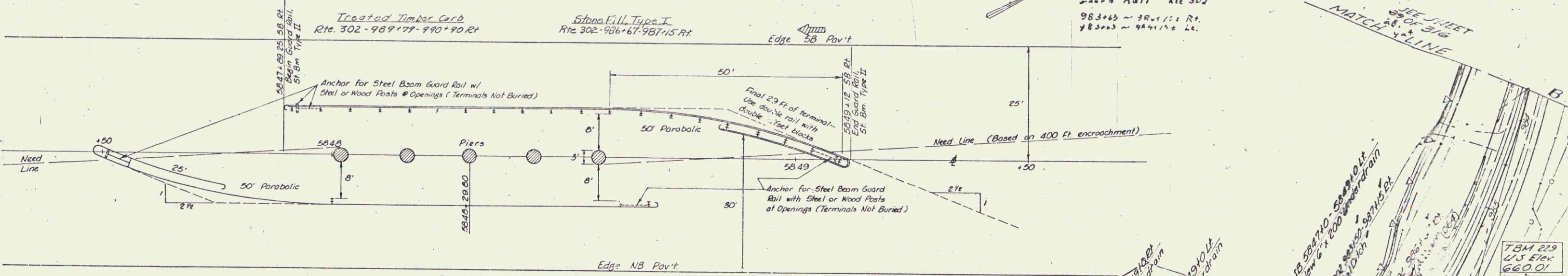

Scale 1" = 10'

5847+89.25 - 5849+12.0 SB Rt. 15175 (182) LF incl 17' P&C  
5847+48 - 5848+70.75 NB Lt. 15175 (182) LF incl 12' P&C  
Guard Rail, Standard Steel Beam with Steel Posts, Type II

Approach Railing 2 Rail Aluminum  
Rte 302 Lt. 985+15 - 986+16  
Rt. 984+90 - 987+15  
985+29 - 986+03 984+75 - 984+25

5844+00  
END PROJECT (191-211) BEGIN PROJECT (191-216)  
CONTRACT 4

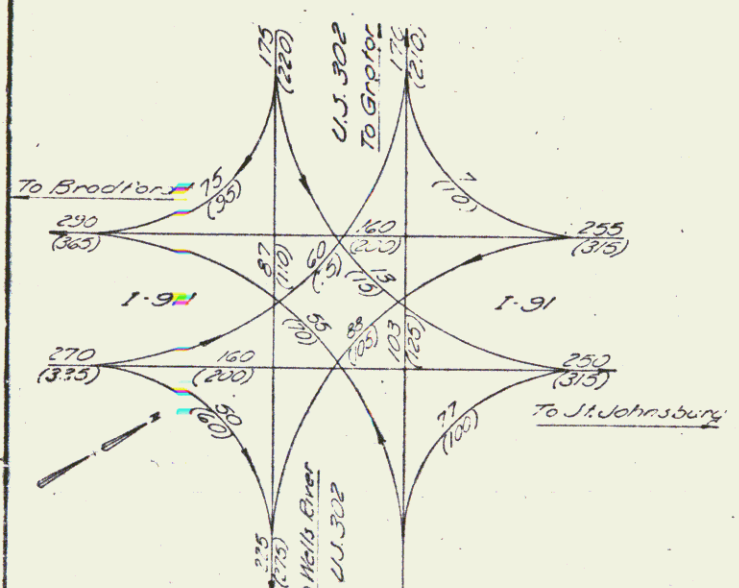
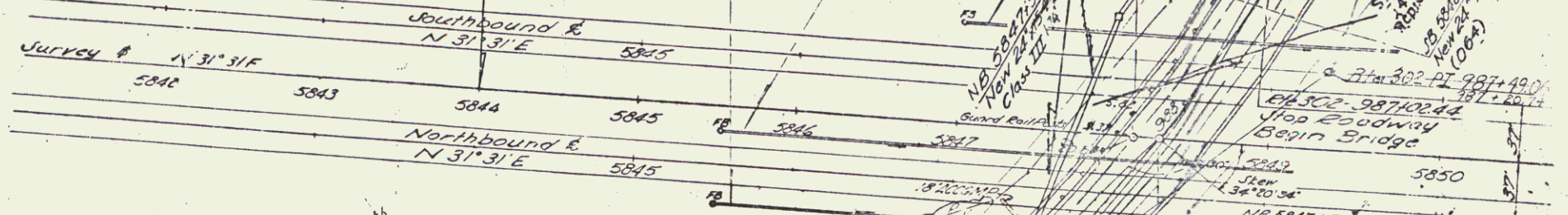

TRAFFIC TURNING MOVEMENT  
Key  
2001-1975 Estimated 30M Foot Mtr Volume  
(200) - 300 (D.H.V. - Design Hour Volume)

Control of Access Complete  
on this Sheet except at  
NB 5839+7 5835 5842

MATCH  
SEE SHEET 2 OF 316

RAMP 'A' 84+11.55 - 99+85.3 Rt.  
Ramp 'B' 90+00.00 - 99+85.3 Rt.  
Ramp 'C' 90+00.00 - 99+85.3 Rt.  
Ramp 'D' 90+00.00 - 99+85.3 Rt.

\* Stage I Construction

STATE OF VERMONT  
DEPARTMENT OF HIGHWAYS  
NEWBURY

M. FARLAND - JOHNSON  
CONSULTING ENGINEER

DESIGNED BY: P. H. STACY  
CHECKED BY: D. E. W. DATE: 6-1-67

PROJECT No: 1-4-2-R-1  
SHEET 22 OF 72