

* Standard Steel Beam Guardrail
 1/2" Steel Bolts Iron 514 A
 NB 5158 +00 - 5160+50 RT
 Property line fence to be erected prior to construction in this area.
 Ramp A' +03 - 3+57 Rt.

Property Line Fence
 1/2" Steel Bolts Iron 514 A
 NB 5158 +00 - 5174+00 RT
 SB 5158 +00 - 5174+00 LT

Vertical Curve Data
 NB 5160+00 - 5162+00
 NB 5162+00 - 5164+00
 NB 5164+00 - 5166+00
 NB 5166+00 - 5168+00
 NB 5168+00 - 5170+00
 NB 5170+00 - 5172+00
 NB 5172+00 - 5174+00

Vertical Curve Data
 NB 5174+00 - 5176+00
 NB 5176+00 - 5178+00
 NB 5178+00 - 5180+00
 NB 5180+00 - 5182+00
 NB 5182+00 - 5184+00
 NB 5184+00 - 5186+00
 NB 5186+00 - 5188+00
 NB 5188+00 - 5190+00

Vertical Curve Data
 NB 5190+00 - 5192+00
 NB 5192+00 - 5194+00
 NB 5194+00 - 5196+00
 NB 5196+00 - 5198+00
 NB 5198+00 - 5200+00

Vertical Curve Data
 NB 5200+00 - 5202+00
 NB 5202+00 - 5204+00
 NB 5204+00 - 5206+00
 NB 5206+00 - 5208+00
 NB 5208+00 - 5210+00

NB + JB Curve Data

$\Delta = 44^{\circ} 37' 02.5''$
 $\theta = 3^{\circ} 07' 30''$
 $L = 250$
 $T = 1065.81$
 $E = 106.65$
 $JT = 166.65$
 $JT' = 01.36$
 $\Delta = 33^{\circ} 22' 02.5''$
 $D = 2^{\circ} 30'$
 $L = 1534.70$
 $R = 2291.03$
 $Bnt = 799.74$

Curve Data
 Ramp D
 $\Delta = 33^{\circ} 22' 02.5''$
 $D = 10^{\circ} 00'$
 $E = 672.94$
 $T = 172.44$
 $L = 335.00$
 $R = 253.39$
 $Bnt = 876.74$

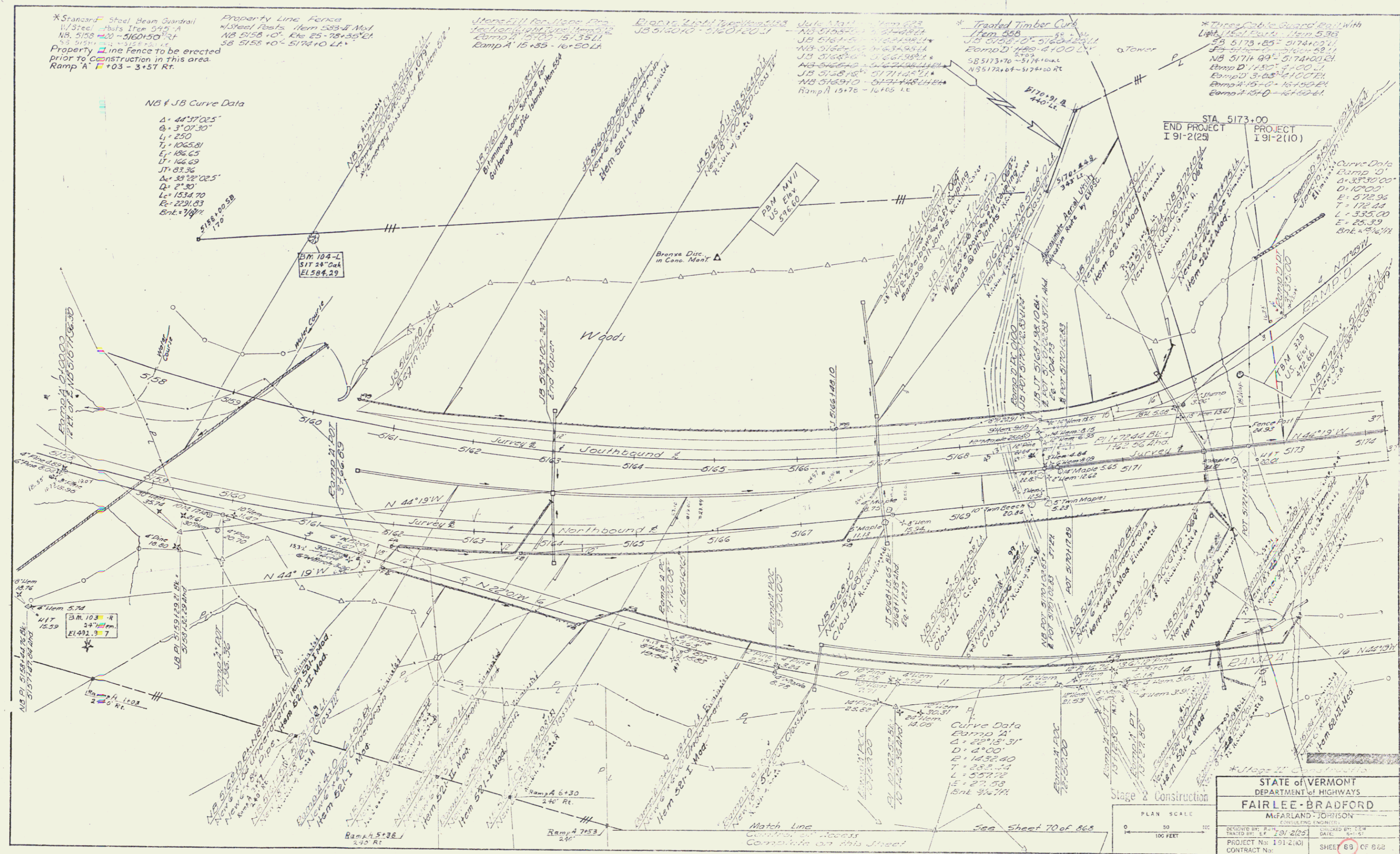

STATE OF VERMONT
 DEPARTMENT OF HIGHWAYS
FAIRLEE-BRADFORD
 McFARLAND-JOHNSON
 CONSULTING ENGINEERS

DESIGNED BY: R.M. [unclear] DATE: 9-1-57
 TRACED BY: L.P. [unclear] DATE: 9-1-57
 PROJECT No: 191-2(10) SHEET 69 OF 662
 CONTRACT No: [unclear]

Sheet 72 of 117 Sheets