

Property Line Fence to be erected prior to construction in this area  
 NB 4936+54 Rt - NB 4952+00 BL

Drilling & Blasting of Solid Rock, Subgrade  
 NB 4935+15 - 4955+50  
 SB 4949+38 - 4951+50

Property Line Fence  
 NB 4936+00 - 4952+00 Lt  
 NB 4936+00 - 4952+00 Rt

Standard Steel Beam Guard Rail  
 SB 4936+00 - 4940+50 Rt  
 SB 4937+00 - 4943+00 Lt

Joint Elevation Projection  
 NB 4936+00 - 4952+00 Lt  
 NB 4936+00 - 4952+00 Rt

Sub-base of Sand, Item 202  
 NB 4944+75 - 4946+00  
 NB 4948+25 - 4952+00  
 SB 4945+00 - 4952+00

Curve Data  
 J/B  
 Δ = 25° 04' 15"  
 D = 17' 00"  
 P = 5729.58'  
 T = 1186.25'  
 L = 2342.36'  
 E = 12161'  
 Bnt = 71677'

Sub-base of Sand, Item 202  
 NB 4944+75 - 4946+00  
 NB 4948+25 - 4952+00  
 SB 4945+00 - 4952+00

\* Troofed Timber Curb  
 Item 500  
 SB 4937+18 - 4943+97 Lt

\* Three Course Guard Rail  
 Light Iron Bolt, Item 538  
 NB 4936+00 - 4940+00 Lt  
 NB 4936+00 - 4940+00 Rt  
 NB 4936+00 - 4940+00 Lt

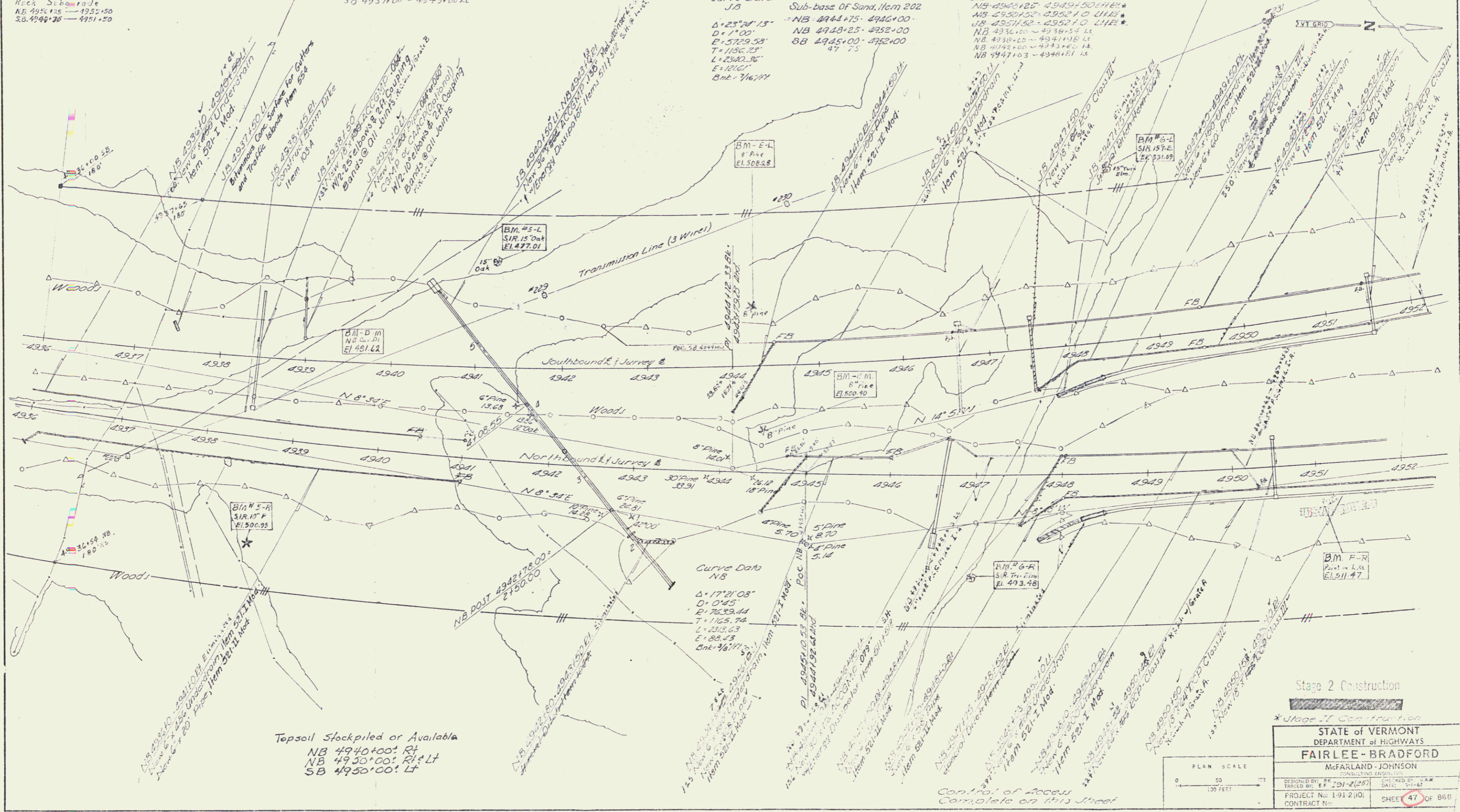

Topsoil Stockpiled or Available  
 NB 4940+00: Rt  
 NB 4950+00: Rt & Lt  
 SB 4950+00: Lt

Curve Data  
 NB  
 Δ = 17° 21' 08"  
 D = 0' 45"  
 P = 7689.44'  
 T = 1165.74'  
 L = 2323.63'  
 E = 88.45'  
 Bnt = 71677'

Control of Access  
 Complete on this Street

PLAN SCALE  
 0 50 100 FEET

Stage 2 Construction

STATE of VERMONT  
 DEPARTMENT of HIGHWAYS  
**FAIRLEE - BRADFORD**  
 McFARLAND - JOHNSON  
 CONSULTING ENGINEERS

DESIGNED BY: J.K. THORPE  
 CHECKED BY: J.W. DATE: 11-67  
 PROJECT No: 1-91-2(10) SHEET 47 OF 668  
 CONTRACT No:

Sheet 32 of 117 Sheets