

NB 4336100
 180.21
 NB 4337195
 180.21
 NB 4336154
 180.21

Curve Data
 JBL
 $\Delta = 27^{\circ} 45'$
 $D = 1100'$
 $E = 572.38$
 $T = 1182.37$
 $L = 2507.86$
 $E = 12.91$
 $Set = 34.77$

Curve Data
 JBL
 $\Delta = 17^{\circ} 08'$
 $D = 645'$
 $E = 332.44$
 $T = 642.40$
 $L = 1322.45$
 $E = 12.91$
 $Set = 14.77$

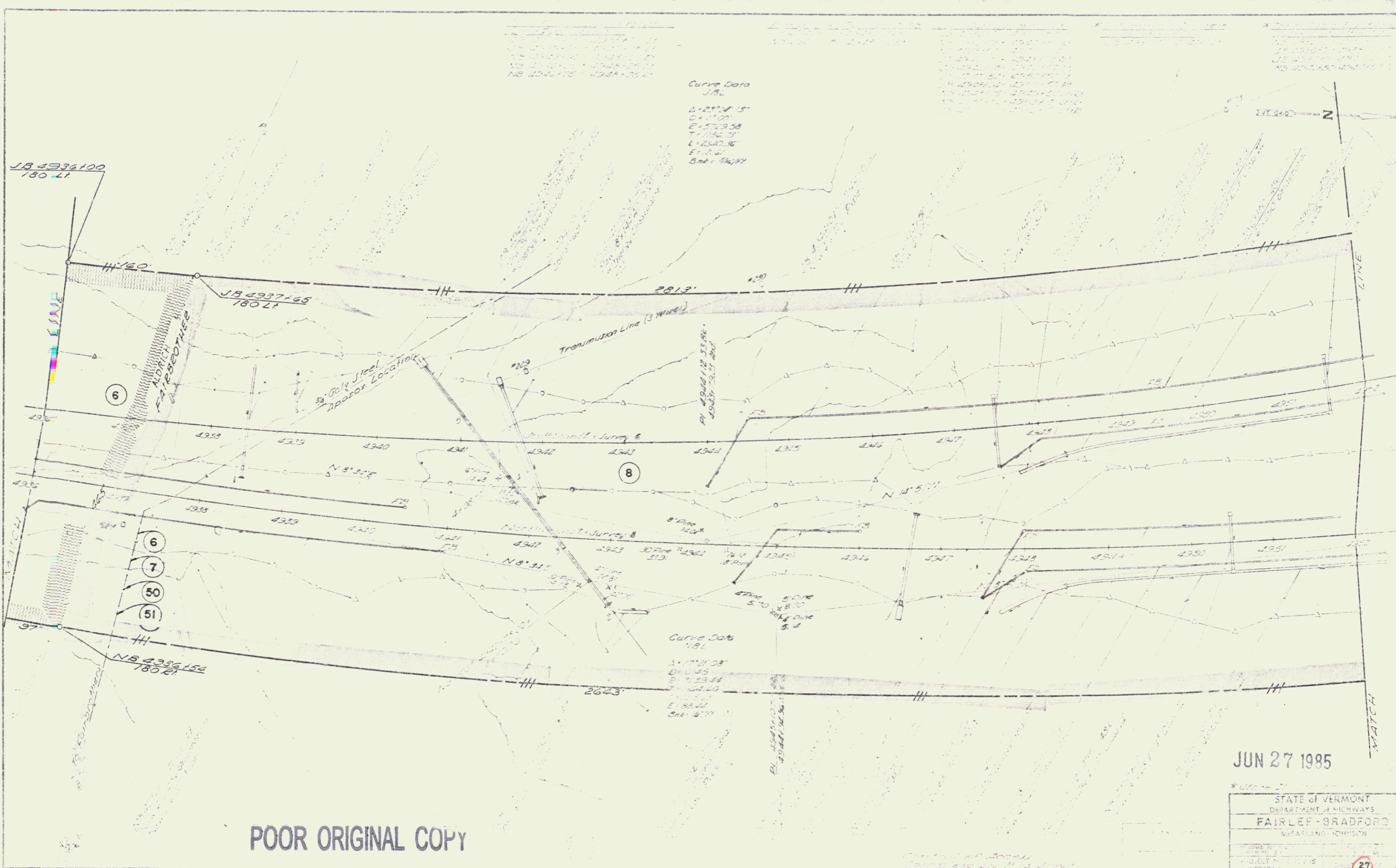

- (6)
- (7)
- (50)
- (51)

POOR ORIGINAL COPY

JUN 27 1985

STATE OF VERMONT
 DEPARTMENT OF HIGHWAYS
 FAIRLEE-BRADFORD
 METARLAND THOMPSON

PROJECT NO. 11115
 CONTRACT NO. 27

STAGE II CON