

CONSTRUCT SPEED CHANGE LANE (INCL. 300' TAPER)		
STATION	STATION	POS
SOUTHBOUND		
4482+00	4483+00	0
NORTHBOUND		
4482+00	4483+00	0

CONSTRUCT RAMP		
STATION	STATION	RAMP
SOUTHBOUND		
4482+00	4483+00	C
NORTHBOUND		
4482+00	4483+00	D

STONE FILL FOR SLOPE PROTECTION (LIGHT TYPE) ITEM 512		
STATION	STATION	POS
SOUTHBOUND		
4482+00	4483+00	0
NORTHBOUND		
4482+00	4483+00	0

RRAP (HEAVY TYPE) ITEM 513-A		
STATION	STATION	POS
SOUTHBOUND		
4482+00	4483+00	0
NORTHBOUND		
4482+00	4483+00	0

RRAP (LIGHT TYPE) ITEM 513-B		
STATION	STATION	POS
NORTHBOUND		
4482+00	4483+00	0

FOR PAVEMENT WIDTHS AND ELEVATIONS AT RAMP EXIT AND ENTRANCE SEE SHEET 35 OF 188.

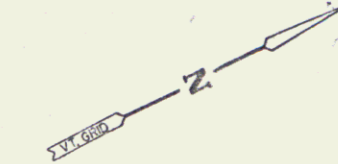

NB 4493+00  
 END PROJECT 191-2(7) BEGIN PROJECT 191-2(24)  
 END CONTRACT NO 4 (4)

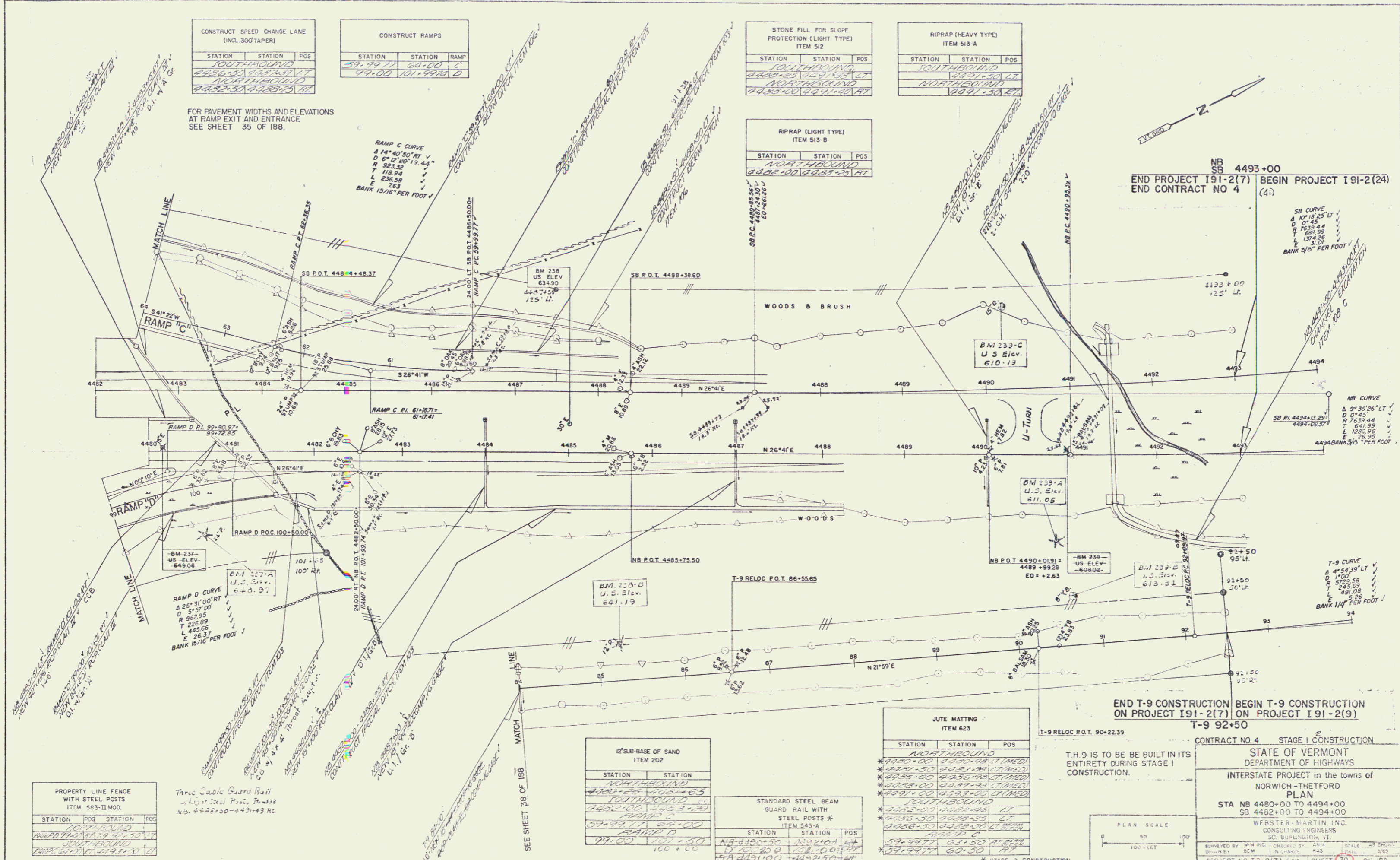

PROPERTY LINE FENCE WITH STEEL POSTS ITEM 583-II MOD.			
STATION	POS	STATION	POS
SOUTHBOUND			
4482+00	0	4483+00	0
NORTHBOUND			
4482+00	0	4483+00	0

Triple Cable Guard Rail  
 4" x 4" Steel Post, 3" x 3" x 30'  
 NB: 4482+50-4493+43 NC

12" SUB-BASE OF SAND ITEM 202		
STATION	STATION	POS
SOUTHBOUND		
4482+00	4483+00	0
NORTHBOUND		
4482+00	4483+00	0

STANDARD STEEL BEAM GUARD RAIL WITH STEEL POSTS * ITEM 545-A		
STATION	STATION	POS
SOUTHBOUND		
4482+00	4483+00	0
NORTHBOUND		
4482+00	4483+00	0

JUTE MATTING ITEM 623		
STATION	STATION	POS
NORTHBOUND		
4482+00	4483+00	0
SOUTHBOUND		
4482+00	4483+00	0

T.H.9 IS TO BE BUILT IN ITS ENTIRETY DURING STAGE I CONSTRUCTION.



END T-9 CONSTRUCTION BEGIN T-9 CONSTRUCTION ON PROJECT 191-2(7) ON PROJECT 191-2(9)  
 T-9 92+50

CONTRACT NO. 4 STAGE I CONSTRUCTION

STATE OF VERMONT  
 DEPARTMENT OF HIGHWAYS  
 INTERSTATE PROJECT in the towns of  
 NORWICH-THETFORD  
 PLAN  
 STA NB 4480+00 TO 4494+00  
 SB 4482+00 TO 4494+00

WEBSTER-MARTIN, INC.  
 CONSULTING ENGINEERS  
 501 BURLINGTON, VT.

PROJECT NO. 191-2(7) (4) SHEET 39 OF 188

100