

FOR PAVEMENT WIDTHS AND ELEVATIONS AT RAMP EXIT AND ENTRANCE SEE SHEET 23 OF 198

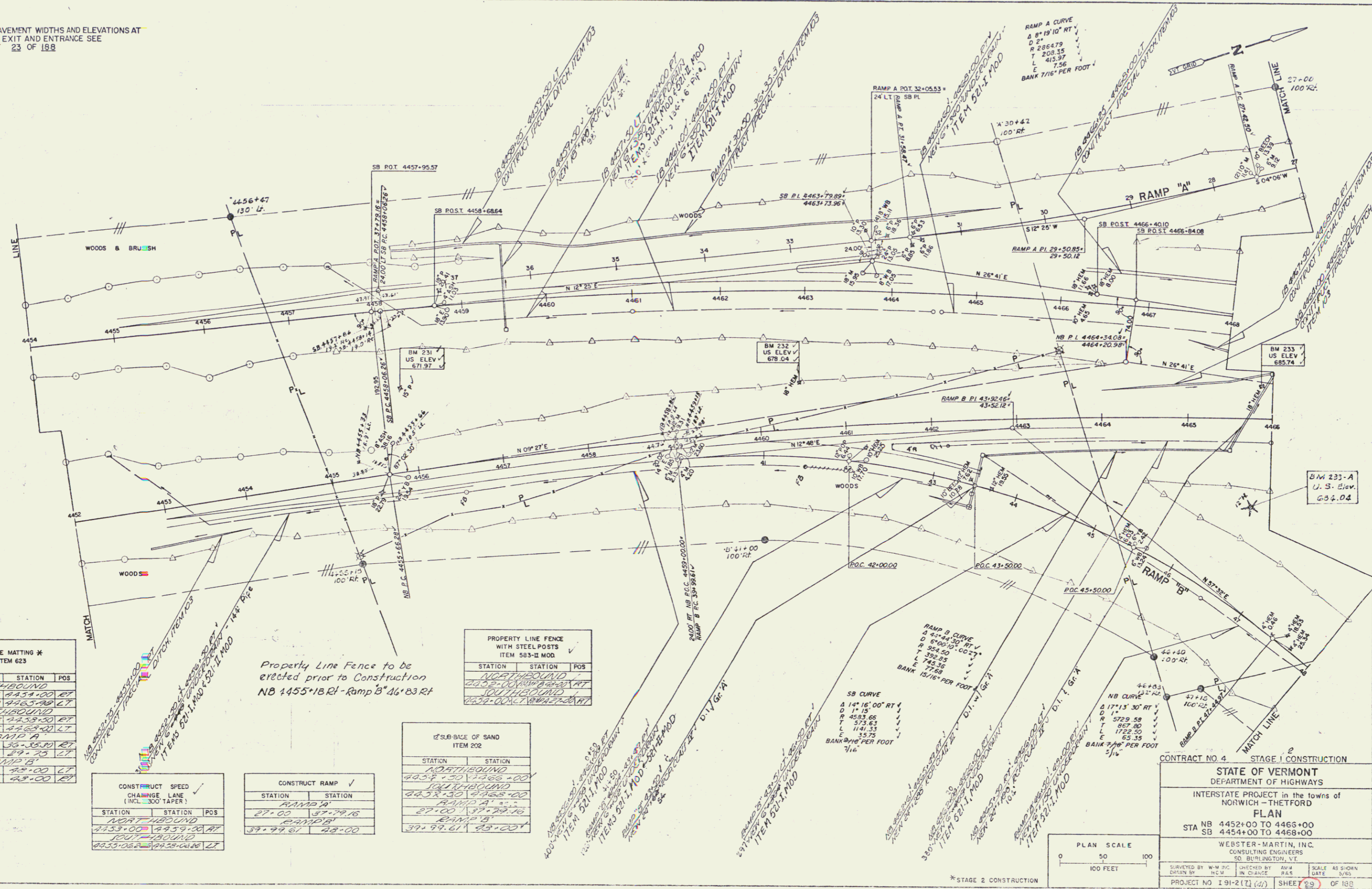

JUTE MATTING *
ITEM 623

STATION	STATION	POS
NORTHBOUND		
4453+00	4454+00	RT
4454+00	4465+00	LT
SOUTHBOUND		
4453+00	4453+00	RT
4453+00	4453+00	LT
4453+00	4453+00	RT
4453+00	4453+00	LT

CONSTRUCT SPEED CHANGE LANE (INCL. 300' TAPER)

STATION	STATION	POS
NORTHBOUND		
4453+00	4459+00	RT
SOUTHBOUND		
4453+00	4459+00	LT

CONSTRUCT RAMP

STATION	STATION
RAMP A	
27+00	37+99.16
RAMP B	
39+99.61	48+00

2" SUB-BASE OF SAND ITEM 202

STATION	STATION
NORTHBOUND	
4453+50	4466+00
SOUTHBOUND	
4453+30	4466+00
RAMP A	
27+00	37+99.16
RAMP B	
39+99.61	48+00

PROPERTY LINE FENCE WITH STEEL POSTS ITEM 583-B MOD

STATION	STATION	POS
NORTHBOUND		
4453+00	4466+00	RT
SOUTHBOUND		
4453+00	4466+00	LT

Property Line Fence to be erected prior to Construction
NB 1455+18 Rt - Ramp B 46+83 Rt



CONTRACT NO. 4 STAGE I CONSTRUCTION

STATE OF VERMONT
DEPARTMENT OF HIGHWAYS

INTERSTATE PROJECT in the towns of
NORWICH - THETFORD

PLAN
STA NB 4452+00 TO 4466+00
SB 4454+00 TO 4468+00

WEBSTER-MARTIN, INC.
CONSULTING ENGINEERS
50 BURLINGTON, VT

SUBMITTED BY W.M.M. IN CHARGE
CHECKED BY A.W.M. IN CHARGE
DATE 5/25/55

PROJECT NO. I 91-2 (1) SHEET 29 OF 198