

INDEX OF SHEETS

- 1 TITLE SHEET
- 1-A ALIGNMENT DATA SHEET
- 2-3 TYPICAL SECTIONS (INTERSTATE ROADWAY) BITUMINOUS CONCRETE IMPROVEMENT, ITEM 361 MOD. TYPE III
- 4 TYPICAL SECTIONS (T-58 RELOCATION)
- 5-6 QUANTITY SHEETS
- 7-11 DRAINAGE SHEETS
- 12-18 GRADE AND EARTHWORK SHEETS
- 19-19' R.M.W. DETAIL SHEETS
- 20-41A PLAN AND PROFILE SHEETS
- 42 A-80 SOLID ROCK EXCAVATION 1-17-68(R)
- 43 B-18 BANKING TABLES 7/17/67(R)
- 44 B-25 TYPICAL SLOPE GRADING 3/10/65
- 45 B-26 MUCK EXCAVATION 3/10/65
- 46 B-28 EMBANKMENT ON A SLOPE 3/10/65
- 47 B-31 UNDERGRAIN WITH SHATTERED ROCK SUEGRADE 3/10/65
- 48 C-1 CURBS 10/23/68 (R)
- 49-50 BLANK
- 51 D-1 PRECAST RCP DROP INLET WITH COVER 8/1/66 (R)
- 52 D-2 UNDERGRAIN AND HEADWALLS 4-14-68 (R)
- 53 D-3 JUTE MATTING, TREATED GUTTERS 7/19/67 (R)
- 54 D-4 ELBOWS, FLUSHING BASINS, METAL END SECTIONS 12-4-68 (R)
- 55 D-8 DROP INLETS 3/10/65
- 56 D-10 DROP INLET TOPS 3/10/65
- 57 D-11 DETAILS OF GRATES AND COVERS 3/10/65
- 58 D-16 PRECAST REINFORCED CONCRETE CURB DROP INLET, CAST IRON GRATES 7/18/67 (R)
- 59 D-17 ACCOMP. VERTICAL RISER 7-1-68 (R)
- 60 E-31 FEDERAL AID CONST. IDENT. SIGNS 8/21/67 (R)
- 61 E-32 ROAD CONST. APPROACH SIGNS 1/6/67
- 62 E-34 ON PROJECT CONST. SIGNS 5/3/67 (R)
- 63 F-1 PROJECT LINE FENCE 11/29/67 (R)
- 64 G-22 TWO CABLE GUARD RAIL 12-3-68 (R)
- 65 G-20 TWO CABLE GUARD RAIL - LEAD END ANCHORAGE 3/10/65
- 66 G-4 PLANK GUARD RAIL - SLICE POSTS, MARKER POSTS 12/30/65 (R)
- 67 J-1 BOUNDARY MARKERS 3/10/65

- 68 SCD-01-67 GENERAL NOTES 1/24/68
- 69 SCD-02-67 BEAM HAUNCH DETAILS 1/24/68
- 70 SCD-05-67 CURB DETAILS 1/24/68
- 71 SCD-04-67 END BLOCK DETAILS 12/17/68
- 72-73 SB-R1-64 ALUMINUM BRIDGE RAILING DETAILS SH.1, 11/8/66 R. SH.2, 11/8/66 R.
- 74 SB-R2-65 GALVANIZED STEEL BRIDGE RAILING DETAILS 11/8/66 R.
- 75 SB-P1-66 CONCRETE PILING 11/8/66
- 76-78 BLANK
- RELUCATED T-58 BRIDGE OVER INTERSTATE
M.L. STA 4417+00
- 79 PLAN AND ELEVATION
- 80 BRIDGE QUANTITY SHEET
- 81 PRELIMINARY INFORMATION SHEET
- 82 BORING LOG
- 83-84 SUPERSTRUCTURE DETAILS
- 85 JOINT DETAILS
- 86-93 ABUTMENT AND FOOTING DETAILS
- 94-96 REINFORCING STEEL SCHEDULE
- 97-98 DETAILS OF 108" COMPP # NB STA 4411+20 RT - 4412+25 LT
- 99 DETAILS OF 108" COMPP # T-58 STA. 813+00
- 100 DETAILS OF 12'-10" X 8'-4" COMPP # SB STA 4419+00 RT - 4419+50 LT
- 101-241 MAINLINE SECTIONS
- 242-246B T-58 & T-7 RELOCATION SECTIONS
- 247-251 CHANNEL LINE, NO. 5 SECTIONS
- 252-254 DRAINAGE SECTIONS

STATE OF VERMONT
DEPARTMENT OF HIGHWAYS

PROPOSED IMPROVEMENT

INTERSTATE PROJECT
TOWNS OF NORWICH & THETFORD
COUNTIES OF WINDSOR & ORANGE
INTERSTATE ROUTE 91
WHITE RIVER JCT - BRADFORD ROAD
CONTRACT NO 3

BEGINNING AT A POINT APPROXIMATELY 0706 MILES
SOUTHERLY OF THE WINDSOR-ORANGE COUNTY LINE
AND PROCEEDING NORTHERLY 2.568 MILES

LENGTH OF ROADWAY 13,561.08 FEET = 2.568 MILES
LENGTH OF CONTRACT 13,561.08 FEET = 2.568 MILES

TRAFFIC DATA

YEAR	ADT	DMV	D	T	V
1962	2440				
1967	6650	945	54%	6%	60 MPH
1967					

GENERAL NOTES

1. ALL CONSTRUCTION SHALL BE IN ACCORDANCE WITH THE STANDARD SPECIFICATIONS FOR CONSTRUCTION OF PUBLIC ROADS, AS APPROVED BY THE BOARD OF SUPERVISORS, VERMONT, AND THE STANDARD SPECIFICATIONS FOR CONSTRUCTION OF BRIDGES, AS APPROVED BY THE BOARD OF SUPERVISORS, VERMONT.

2. THE CONTRACTOR SHALL BE RESPONSIBLE FOR OBTAINING ALL NECESSARY PERMITS AND RIGHTS-OF-WAY FROM THE APPROPRIATE AGENCIES AND INDIVIDUALS.

3. THE CONTRACTOR SHALL MAINTAIN ACCESS TO ALL ADJACENT PROPERTIES AND PUBLIC ROADS AT ALL TIMES.

4. THE CONTRACTOR SHALL BE RESPONSIBLE FOR THE PROTECTION OF ALL UTILITIES AND STRUCTURES ENCOUNTERED DURING CONSTRUCTION.

5. THE CONTRACTOR SHALL MAINTAIN THE EXISTING GRADE AND EARTHWORK WHEREVER POSSIBLE.

6. THE CONTRACTOR SHALL BE RESPONSIBLE FOR THE PROTECTION OF ALL TREES AND VEGETATION TO REMAIN.

7. THE CONTRACTOR SHALL MAINTAIN THE EXISTING DRAINAGE SYSTEM AND PROVIDE ADEQUATE DRAINAGE FOR ALL NEW CONSTRUCTION.

8. THE CONTRACTOR SHALL BE RESPONSIBLE FOR THE PROTECTION OF ALL STRUCTURES AND UTILITIES ENCOUNTERED DURING CONSTRUCTION.

9. THE CONTRACTOR SHALL MAINTAIN THE EXISTING GRADE AND EARTHWORK WHEREVER POSSIBLE.

10. THE CONTRACTOR SHALL BE RESPONSIBLE FOR THE PROTECTION OF ALL TREES AND VEGETATION TO REMAIN.

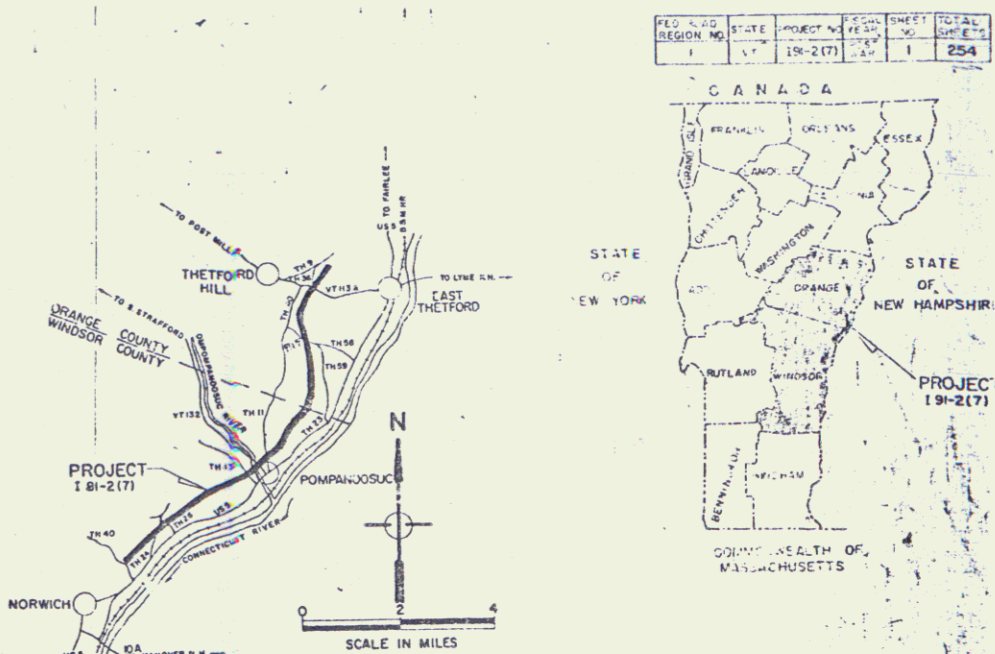

CONSTRUCTION PLANS

CONTRACT NO. 3
DATED - JULY 1, 1969
STARTED - JULY 15, 1969
COMPLETED - JUNE 11, 1971
ACCEPTED - JUNE 1, 1971

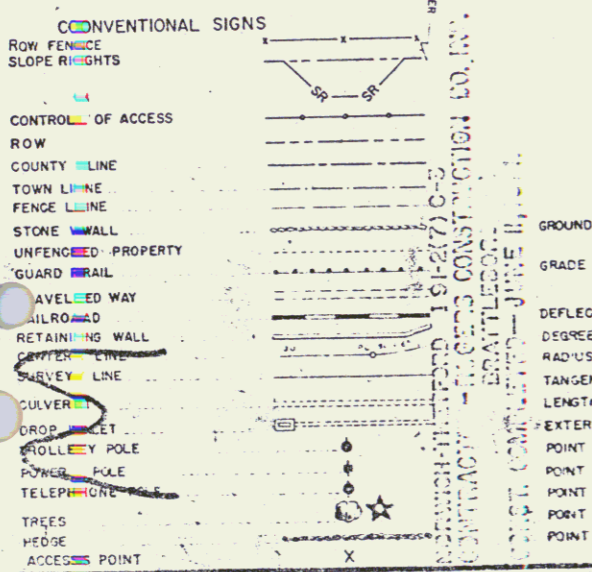
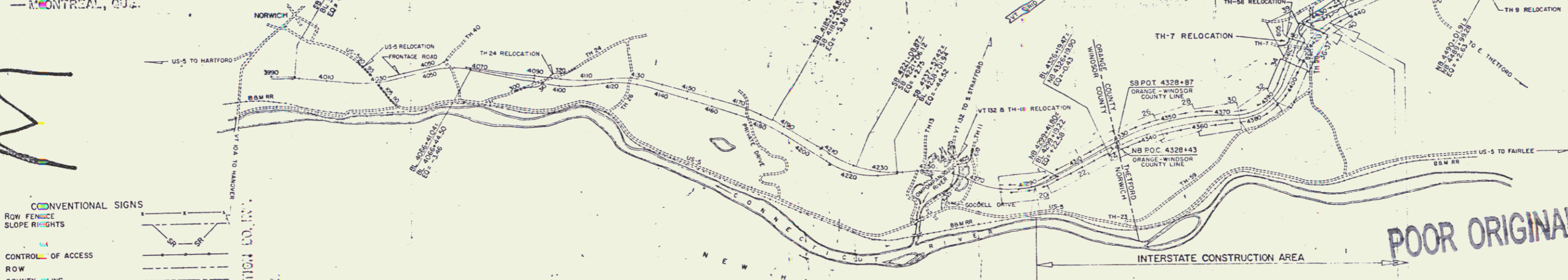

GROUND ELEVATION DATUM MEAN SEA LEVEL
GRADE ELEVATION DATUM MEAN SEA LEVEL
ALL ELEVATIONS ARE US ELEVATIONS

CURVE DATA

DEFLECTION OF ANGLE	D
DEGREE OF CURVE	A
RADIUS OF CURVE	R
TANGENT DISTANCE	T
EXTERNAL DISTANCE	E
LENGTH OF CURVE	L
POINT OF INTERSECTION	PI
POINT OF CURVE	PC
POINT OF TANGENT	PT
POINT ON TANGENT	POT
POINT ON SUB-TANGENT	POST

WEBSTER-MARTIN, INC.
REGISTERED PROFESSIONAL ENGINEER
No. 214
VERMONT

Robert H. Slattery
REGISTERED PROFESSIONAL ENGINEER
No. 214
VERMONT

END CONTRACT NO 2 BEGIN CONTRACT NO 3
SB 4291+50

END CONTRACT NO 3 BEGIN CONTRACT NO 4
SB 4425+00
NB 4429+00

FOR RIGHT-OF-WAY DETAILS - SEE RIGHT-OF-WAY PLAN

APPROVED: [Signature] DATE: 5/27/68
APPROVED: [Signature] DATE: 8/7/65
APPROVED: [Signature] DATE: 8/4/65
APPROVED: [Signature] DATE: 7/9/65
APPROVED: [Signature] DATE: 8/19/65

STAGE I CONSTRUCTION

DEPARTMENT OF TRANSPORTATION
BUREAU OF PUBLIC ROADS

APPROVED: [Signature]
DIVISION ENGINEER

PROJECT NO. 91-2171
SHEET 1 OF 254 SHEETS

POOR ORIGINAL COPY