

JUTE MATTING ITEM 523		
STATION	STATION	POS
T-11 RELOCATION		
607+55.10	607+52.10	10 FT
607+23.10	607+20.10	10 FT
608+02.10	608+00.10	10 FT
609+25	609+00	25 FT

TWO CABLE GUARD RAIL ITEM 541		
STATION	STATION	POS
T-11 RELOCATION		
604+50	604+50	8.8 FT
604+00	604+02	13.8 FT

STONE FILL FOR SLOPE PROTECTION (LIGHT TYPE) ITEM 512		
STATION	STATION	POS
T-11 RELOCATION		
604+00	604+30	10 FT
606+25	606+25	10 FT

MUCK EXCAVATION ITEM 117		
STATION	STATION	POS
T-11 RELOCATION		
604+00	603+30	10 FT

MUCK AND/OR UNSUITABLE MATERIAL SHALL BE EXCAVATED TO THE LIMITS SHOWN ON THE PLANS OR AS DIRECTED BY THE ENGINEER AND THE EXCAVATION SHALL BE PAID FOR AS MUCK EXCAVATION, ITEM 117. BACKFILL MATERIAL SHALL BE PLACED TO THE LIMITS SHOWN ON THE PLANS OR AS DIRECTED BY THE ENGINEER AND SHALL MEET THE REQUIREMENTS OF ITEM 117, EXCEPT THAT EXCAVATED ROCK SHALL NOT BE USED FOR THE FILTER MATERIAL ON SIDE SLOPES.

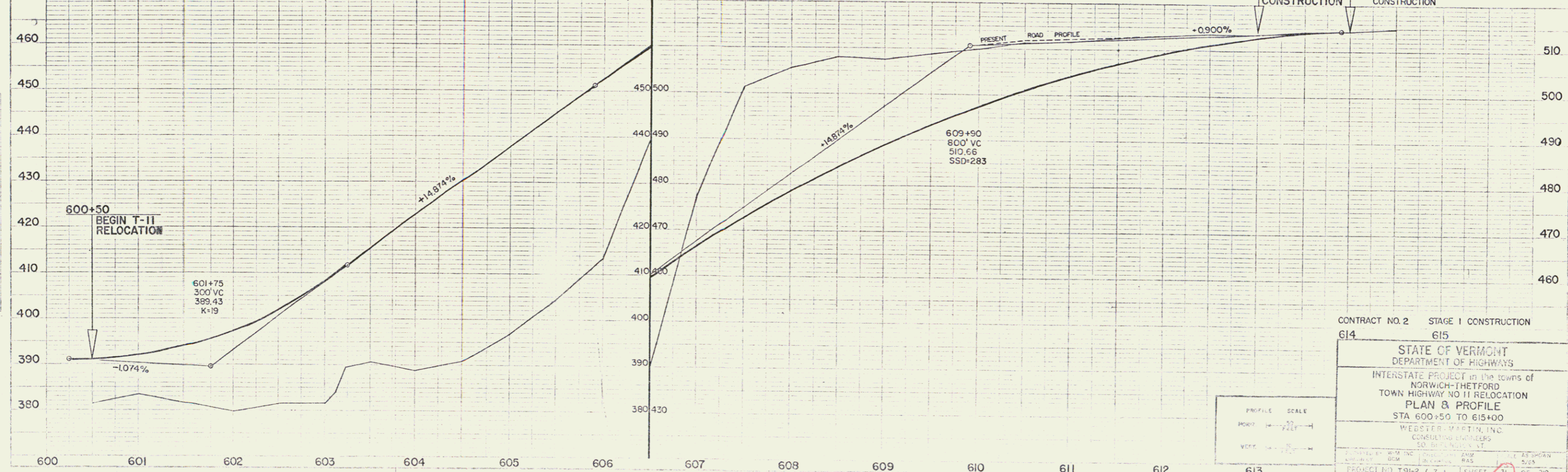
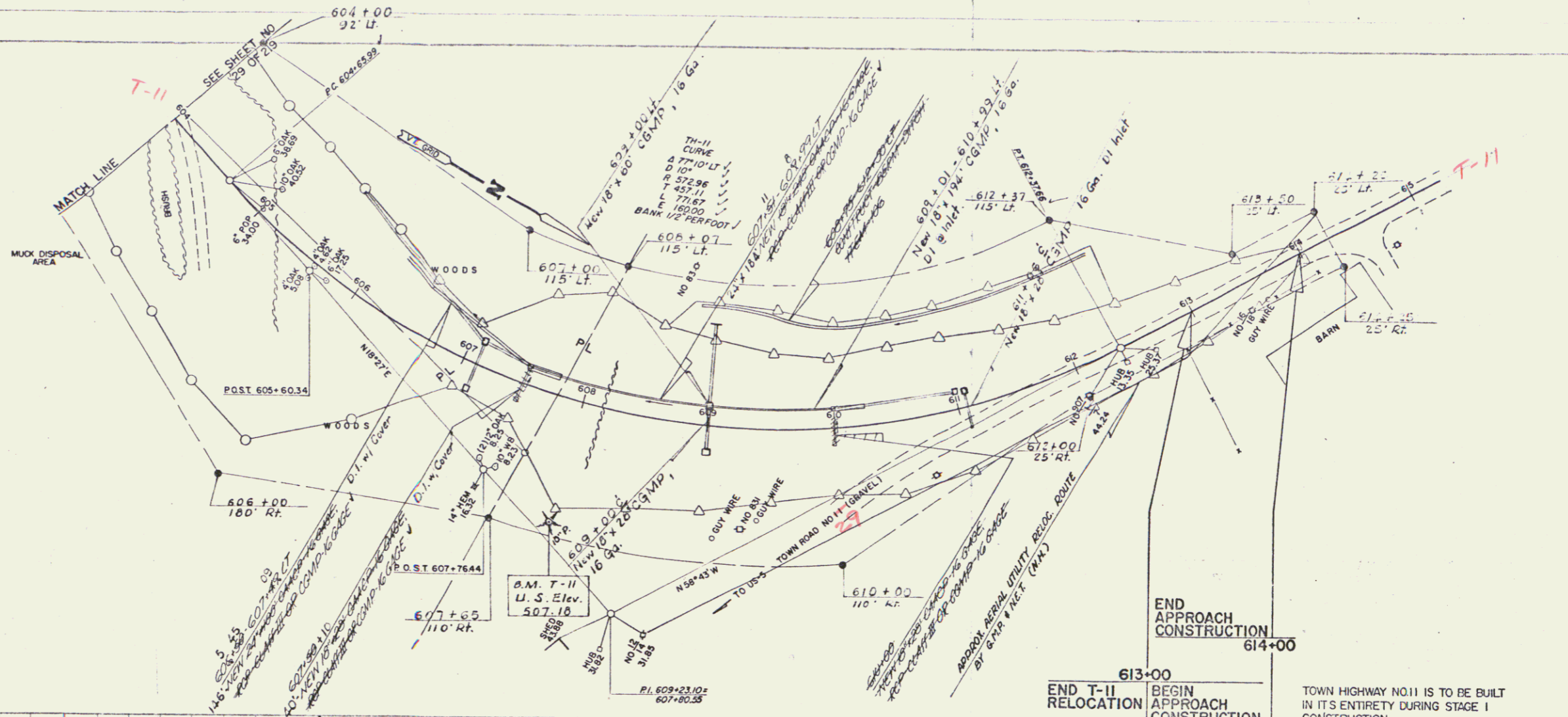

CONTRACT NO. 2 STAGE 1 CONSTRUCTION  
614 615

STATE OF VERMONT  
DEPARTMENT OF HIGHWAYS

INTERSTATE PROJECT in the towns of  
NORWICH-THETFORD  
TOWN HIGHWAY NO 11 RELOCATION  
PLAN & PROFILE  
STA 600+50 TO 615+00

WEBSTER SPRETTIN, INC.  
CONSULTING ENGINEERS  
50 BRIDGE ST.  
BRATTLEBORO, VT.

DESIGNED BY: W.M. INC. DRAWN BY: J.M. INC. CHECKED BY: J.M. INC. APPROVED BY: J.M. INC.  
DATE: 11/25/83

PROJECT NO. 191-2 (7) SHEET 31 OF 319