

THREE CABLE GUARD RAIL WITH LIGHT STEEL POSTS ITEM 538		
STATION	STATION	POS
VT-132 RELOCATION		
339+00	344+00	LT
339+00	344+00	RT

CHANNEL EXCAVATION ITEM 108		
STATION	STATION	POS
VT-132 RELOCATION		
339+00	344+30	RT

STONE FILL FOR SLOPE PROTECTION (HEAVY TYPE) ITEM 511		
STATION	STATION	POS
VT-132 RELOCATION		
339+00	344+30	RT

STONE FILL FOR SLOPE PROTECTION (LIGHT TYPE) ITEM 512		
STATION	STATION	POS
VT-132 RELOCATION		
339+00	343+00	RT

EXCAVATION AND REMOVAL OF ROAD SURFACES AND/OR PAVEMENTS ITEM 119		
STATION	STATION	POS
VT-132 RELOCATION		
339+00	343+00	LT
344+00	347+00	RT
	543+75	

REMOVAL AND DISPOSAL OF PRESENT GUARD RAIL ITEM 549		
STATION	STATION	POS
VT-132 RELOCATION		
339+00	341+30	LT
339+00	341+30	RT
341+15	342+00	RT
	547+60	

PLANK GUARD RAIL ITEM 540		
STATION	POS	
VT-132 RELOCATION		
341+00	LT	
341+00	RT	

EXCAVATION AND REMOVAL OF EXISTING PAVEMENT ITEM 103		
STATION	STATION	POS
VT-132 RELOCATION		
342+30	344+00	

FILLS TO BE MADE OF GRANULAR MATERIAL		
STATION	STATION	POS
VT-132 RELOCATION		
339+00	344+30	

CONSTRUCT APPROACH		
STATION	POS	
VT-132 RELOCATION		
342+25	LT	

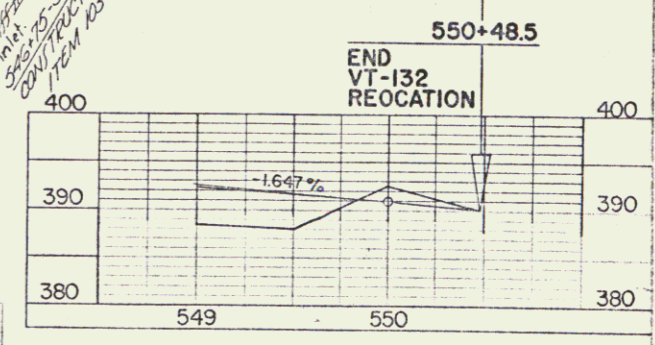
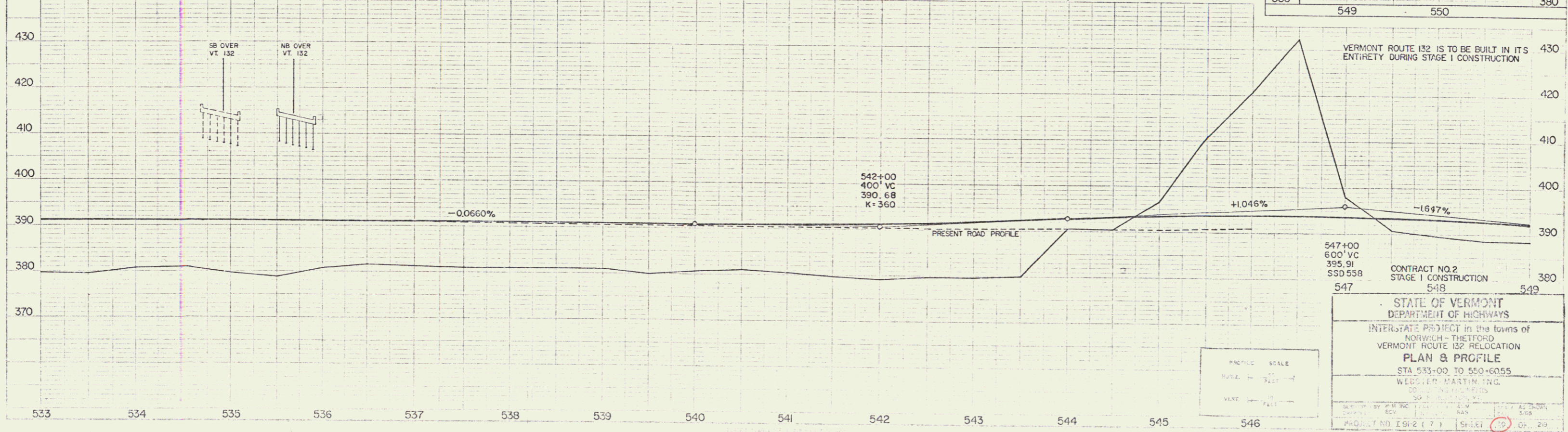

CONTRACT NO. 2
STAGE I CONSTRUCTION

STATE OF VERMONT
DEPARTMENT OF HIGHWAYS

INTERSTATE PROJECT in the towns of
NORWICH - THETFORD
VERMONT ROUTE 132 RELOCATION

PLAN & PROFILE
STA 533+00 TO 550+60.55

WEDGIER MARTIN INC.
100 W. MAIN ST.
NORWICH, VT 05055

DATE: 06/10/99
SCALE: 1" = 10'

PROJECT NO. 1642 (7) SHEET 10 OF 29

Revised 6/10/99