

NB 4291+50  
 SB  
 END CONTRACT NO 2 BEGIN CONTRACT NO 3

B/L CURVE  
 Δ 52°27'20" LT  
 D 2°15'  
 R 2546.48  
 T 1254.56  
 L 2331.36  
 E 292.27  
 BANK 3/4" PER FOOT

SPIRALS  
 BR 2°48'48" LT  
 CR 2°15'  
 LR 150.00

NB CURVE  
 Δ 23°21'07" LT  
 D 1°43'45"  
 R 3313.37  
 T 680.22  
 L 1341.80  
 E 69.90  
 BANK 5/8" PER FOOT

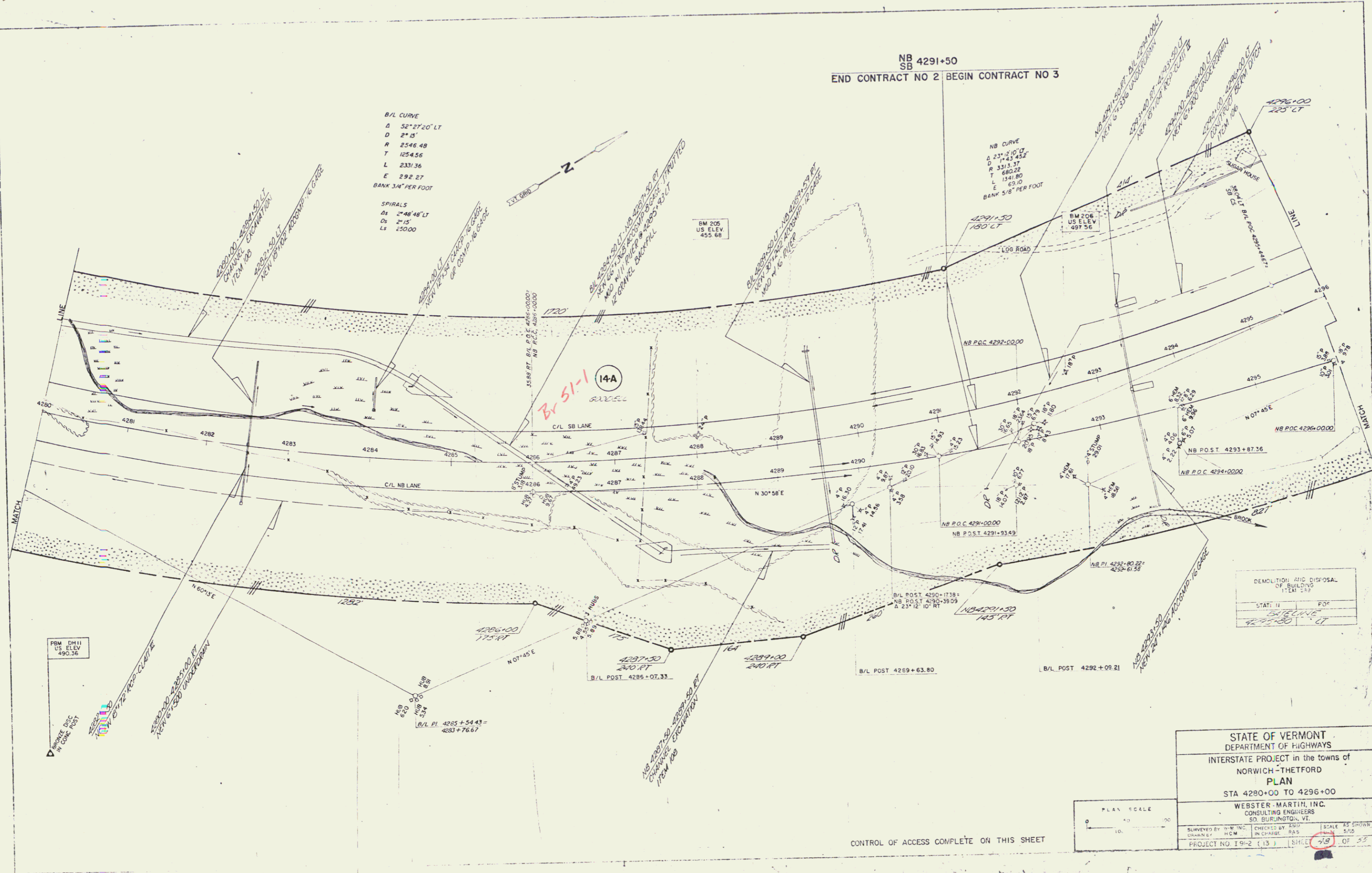

DEMOLITION AND DISPOSAL  
 OF BUILDING  
 ITEM 533  
 STATE II FOR  
 BURLINGTON, VT  
 4291+50

STATE OF VERMONT  
 DEPARTMENT OF HIGHWAYS  
 INTERSTATE PROJECT in the towns of  
 NORWICH - THETFORD  
 PLAN  
 STA 4290+00 TO 4296+00  
 WEBSTER-MARTIN, INC.  
 CONSULTING ENGINEERS  
 50 BURLINGTON, VT.  
 SURVEYED BY: H.C.M. | DRAWN BY: S.W.T. | SCALE AS SHOWN  
 IN CHARGE: R.A.S. | DATE: 5/75  
 PROJECT NO. 19-2 (13) | SHEET 7/8 OF 33

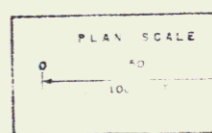

CONTROL OF ACCESS COMPLETE ON THIS SHEET