

**\* BITUMINOUS CONCRETE GUTTER ITEM 554**  
 SB 3694+71.52 - NB 3695+00 Lt  
 3701+50 SB RT - NB Lt  
 3701+50 NB Rt  
 3699+50 - 3702+00 SB Lt  
 3701+50 NB Rt

**\* THREE CABLE GUARD-RAIL w/ STEEL POSTS ITEM 542**  
 NB 3700+04 - 3701+88 Rt  
 S.B. 3701+25 - 3701+91 Lt  
 N.B. 3700+06 - 3702+00 Lt

**PROPERTY LINE FENCE w/ STEEL POSTS, ITEM 583-B**  
 S.B. 3690+00 - 3695+67 Lt  
 Ramp D' 7+00 - 10+00 Lt  
 (The above stationed fence is to be erected prior to the commencement of construction)  
 Ramp E' 17+00 - 17+37 Lt

**\* GRANITE SLOPE EDGING-ITEM 556-A**  
 Ramp E' 17+00 - 17+37 Lt

**DRILLING & BLASTING OF SOLID ROCK SUBGRADE, ITEM 114**  
 SB 3692+16 - 3702+00  
 NB 3695+85 - 3702+00  
 Ramp E' 17+00 - 24+00  
 13+24

**BITUMINOUS CONCRETE CURB ITEM 555**  
 2100+45 - 3701+25 - NB, Rt.

**\* STANDARD STEEL BEAM GUARD RAIL w/ STEEL POSTS ITEM 545-A**  
 SB 3701+99 - RT - 3702+00 -  
 S.B. 3702+00 Rt. - NB 3702+00 Lt.

Rev SB Curve #1  
 $\Delta$  21° 56' 40" Lt  
 $D$  2'  
 $R$  2064.79  
 $T$  555.42  
 $L$  1097.22  
 $E$  52.37  
 Bank 1/4% per ft.

NB CURVE #1  
 $\Delta$  22° 12' 20" Lt  
 $D$  2' 00"  
 $R$  2804.79  
 $T$  562.19  
 $L$  1110.28  
 $E$  54.24  
 Bank 1/4% per ft.

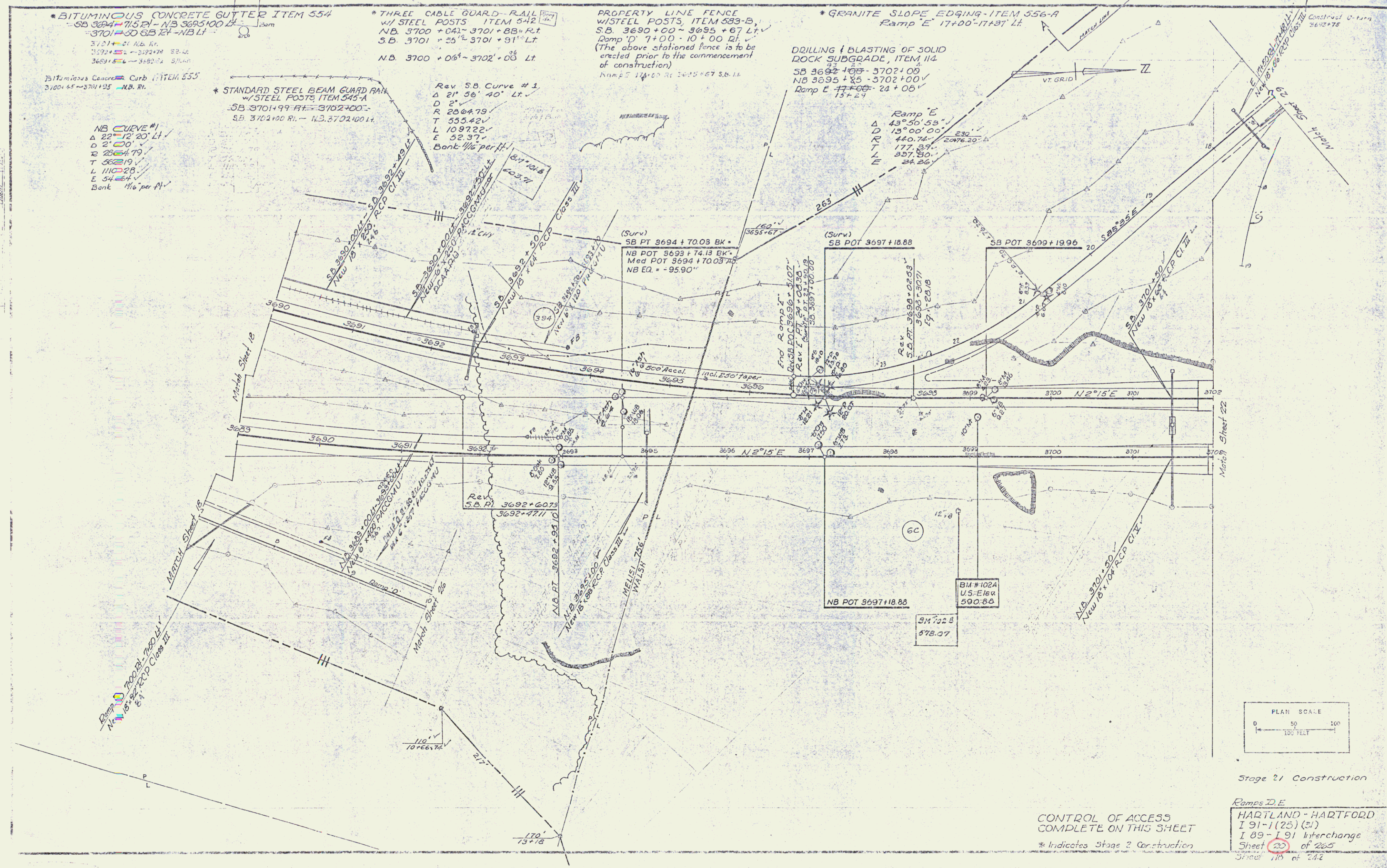

Stage 21 Construction

CONTROL OF ACCESS  
 COMPLETE ON THIS SHEET  
 \* Indicates Stage 2 Construction

Ramps D, E  
 HARTLAND - HARTFORD  
 I 91 - I 25 (21)  
 I 89 - I 91 Interchange  
 Sheet 23 of 265  
 Sheet 115 of 142