

500 - BASE OF GRAVEL, ITEM 500-A MOD
NB 3434400 - 3434475 LT
SB 3434490 - 3434430 LT

4 TAPED CARBON CORRO RAIL WITH STEEL POSTS, ITEM 543-562
NORTHBOUND
24314.00 - 24314.00
SOUTHBOUND
24314.00 - 24314.00

PROPERTY LINE FENCE WITH STEEL POSTS, ITEM 583-D
NORTHBOUND
24314.00 - 24314.00
SOUTHBOUND
24314.00 - 24314.00

PILE MATTING, ITEM 623
24314.00 - 24324.25 MED
24324.25 - 24329.40 MED
24329.40 - 24334.55 MED
24334.55 - 24344.70 MED

STONE FILL FOR SLOPE PROTECTION, ITEM 532
NORTHBOUND 34444.12 - 34474.00 RT
SOUTHBOUND 34444.29 - 34494.06 LT

BITUMINOUS CONCRETE CURB, ITEM 555
NB 3443440 - 34474.00 RT
SB 3443440 - 34474.00 LT

STANDARD STEEL BEAM GROUND RAIL WITH STEEL POSTS
NB 3425475 - 3425429

Existing Concrete Surface Air Settles Eliminated
P.L. 3443445
3443445 - 3443445
3443445 - 3443445

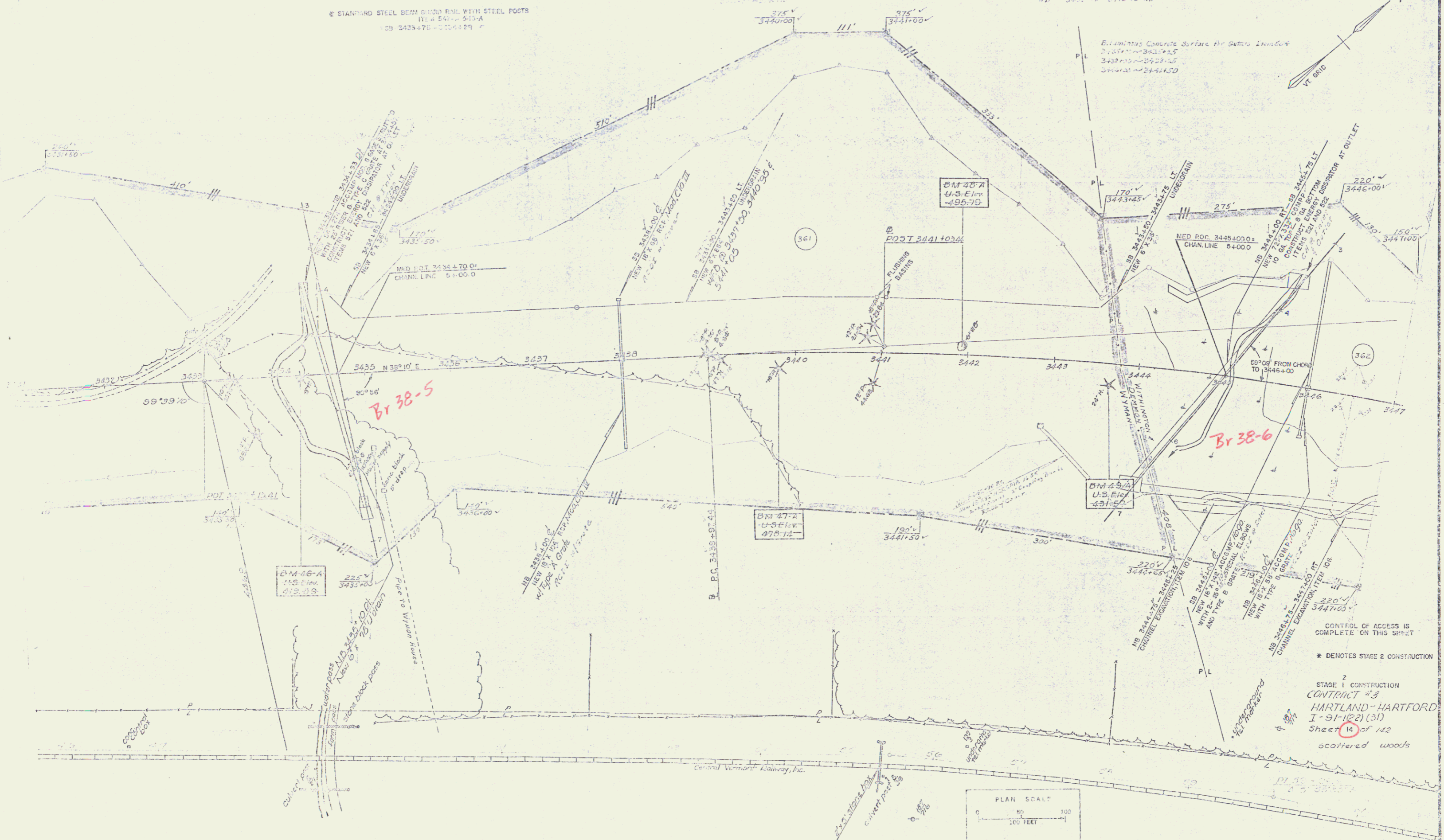

CONTROL OF ACCESS IS COMPLETE ON THIS SHEET
* DENOTES STAGE 2 CONSTRUCTION
STAGE 2 CONSTRUCTION
STAGE 1 CONSTRUCTION
CONTRACT #3
HARTLAND - HARTFORD
I-91-102 (31)
Sheet 14 of 142
scattered woods

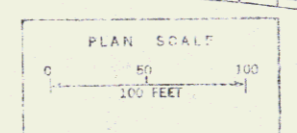

Sheet 00 of 242