

PLAN
 DATE: 10/15/54
 DRAWN BY: J. C. [unclear]
 CHECKED BY: [unclear]
 SCALE: 1" = 40'

PROFILE
 DATE: 10/15/54
 DRAWN BY: J. C. [unclear]
 CHECKED BY: [unclear]
 SCALE: 1" = 40'

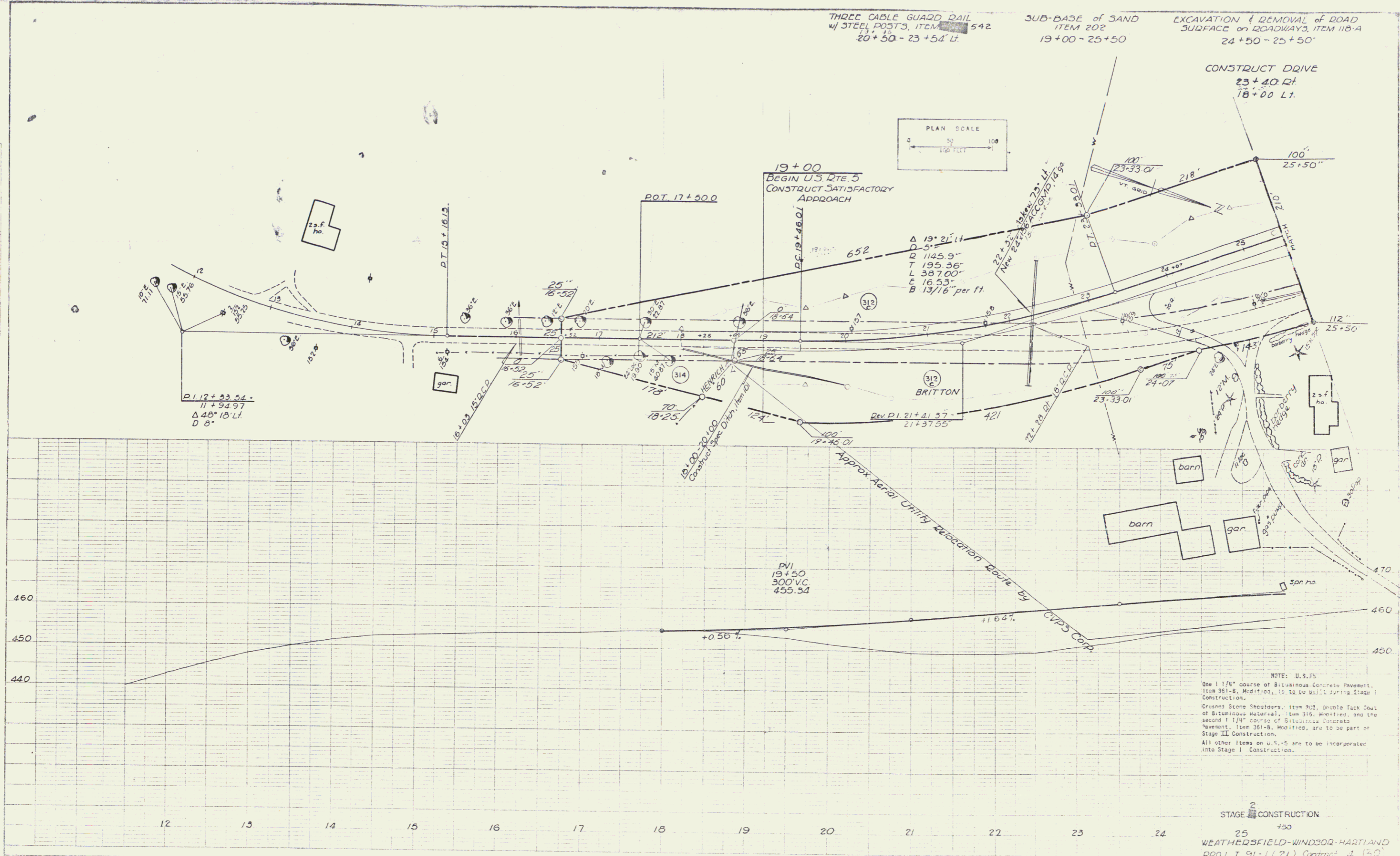

NOTE: U.S.S.
 One 1 1/4" course of Bituminous Concrete Pavement, Item 361-B, Modified, is to be built during Stage I Construction.
 Crushed Stone Shoulders, Item 315, Double Tack Coat of Bituminous Material, Item 315, Modified, and the second 1 1/4" course of Bituminous Concrete Pavement, Item 361-B, Modified, are to be part of Stage II Construction.
 All other items on U.S.S. are to be incorporated into Stage I Construction.

STAGE 2 CONSTRUCTION
 25
 WEATHERSFIELD-WINDSOR-HARTLAND
 PROJ. I 91-1(21) Contract J (S.O.)
 Rte. U.S. 5 @ 3214 + 57.0 = 30 + 00
 Sheet 22 of 24

47