

STATE OF VERMONT
DEPARTMENT OF HIGHWAYS

Proposed Improvement
TOWN OF WEATHERSFIELD
COUNTY OF WINDSOR
INTERSTATE ROUTE 91
BRATTLEBORO-WHITE RIVER JCT. ROAD

BEGINNING AT A POINT 4.071 MILES NORTHERLY OF
THE SPRINGFIELD-WEATHERSFIELD TOWN LINE AND
EXTENDING NORTHERLY 0.952 MILES

LENGTH OF ROADWAY 4,254.57 FEET = 0.805 MILES
LENGTH OF BRIDGES 245.43 FEET = 0.047 MILE (INCL. CONC. BOX)
LENGTH OF CONTRACT 4,500.00 FEET = 0.852 MILES

INTERSTATE STAGE I CONSTRUCTION

ADT 1950 3145
ADT 1964 10,700
D 61 %
T 8 %
V 60 12.2K

INDEX OF SHEETS

1	TITLE PAGE
2	ALIGNMENT SHEET
3-4	TYPICAL CROSS-SECTION OF IMPROVEMENT (INTERSTATE) 2 MIT. CONC. PAVT. (7M 24' 8" MOD.)
5-6	TYPICAL CROSS-SECTION (VT. ROUTE 131 R. TH. 40')
7	QUANTITY SHEET (TOTAL)
8	QUANTITY SHEET (DRAINAGE)
10-15	GEOTECHNICAL SHEETS
16	BLANK
17-24	PLAN AND PROFILE SHEETS
25	A-41 DRILLING AND BLASTING OF SOLID ROCK SUBGRADE
26	B-1 BAKING TABLES
27	B-2 TYPICAL SLOPE GUARD
28	B-3 BLOCK EXCAVATION
29	C-1 C.R.M. DETAILS
30	D-3 GUTTERS
31	D-4 HATCH END CONNECTIONS, ELBOWS
32	D-5 DROP INLETS
33	D-6 DROP INLET TOPS
34	D-7 DROP INLET GRATES
35	D-8 CATCH BASINS
36	D-9 CURB DROP
37	E-1 BARRICADES, SIGNS AND LIGHTS
38	E-2 CONSTRUCT SIGN IDENTIFICATION SIGNS
39	E-3 PROTECTIVE LIMB FENCE
40	E-4 STEEL BEAM GUARD RAIL
41	E-5 TWO CABLE WOUND GUARD RAIL
42	E-6 THREE CABLE WOUND GUARD RAIL WITH STEEL POSTS
43	E-7 PLANT GUARD RAIL - BRID. POSTS
44	J-1 NURSERIES
45	J-2 FIELD OFFICE
46	BR 100 - BR 102 TCB DETAILS
47	BR 100 - BR 215 BRIDGE DETAILS
48	BR 215 - BR 216
49	BR 215 - BR 216
50	BR 215 - BR 216
51	BR 215 - BR 216
52	BR 215 - BR 216
53	BR 215 - BR 216
54	BR 215 - BR 216
55	BR 215 - BR 216
56	BR 215 - BR 216
57	BR 215 - BR 216
58	BR 215 - BR 216
59	BR 215 - BR 216
60	BR 215 - BR 216
61	BR 215 - BR 216
62	BR 215 - BR 216
63	BR 215 - BR 216
64	BR 215 - BR 216
65	BR 215 - BR 216
66	BR 215 - BR 216
67	BR 215 - BR 216
68	BR 215 - BR 216
69	BR 215 - BR 216
70	BR 215 - BR 216
71	BR 215 - BR 216
72	BR 215 - BR 216
73	BR 215 - BR 216
74	BR 215 - BR 216
75	BR 215 - BR 216
76	BR 215 - BR 216
77	BR 215 - BR 216
78	BR 215 - BR 216
79	BR 215 - BR 216
80	BR 215 - BR 216
81	BR 215 - BR 216
82	BR 215 - BR 216
83	BR 215 - BR 216
84	BR 215 - BR 216
85	BR 215 - BR 216
86	BR 215 - BR 216
87	BR 215 - BR 216
88	BR 215 - BR 216
89	BR 215 - BR 216
90	BR 215 - BR 216
91	BR 215 - BR 216
92	BR 215 - BR 216
93	BR 215 - BR 216
94	BR 215 - BR 216
95	BR 215 - BR 216
96	BR 215 - BR 216
97	BR 215 - BR 216
98	BR 215 - BR 216
99	BR 215 - BR 216
100	BR 215 - BR 216
101	BR 215 - BR 216
102	BR 215 - BR 216
103	BR 215 - BR 216
104	BR 215 - BR 216
105	BR 215 - BR 216
106	BR 215 - BR 216
107	BR 215 - BR 216
108	BR 215 - BR 216
109	BR 215 - BR 216
110	BR 215 - BR 216
111	BR 215 - BR 216
112	BR 215 - BR 216
113	BR 215 - BR 216
114	BR 215 - BR 216
115	BR 215 - BR 216
116	BR 215 - BR 216
117	BR 215 - BR 216
118	BR 215 - BR 216
119	BR 215 - BR 216
120	BR 215 - BR 216
121	BR 215 - BR 216
122	BR 215 - BR 216
123	BR 215 - BR 216
124	BR 215 - BR 216
125	BR 215 - BR 216

PROJECT NAME & NUMBER
SPRINGFIELD-WEATHERSFIELD
I 91-1(20) CONT. 3

STAGE I
GRADING &
DRAINAGE

RECORD PLANS
MATERIALS

SUBBASE OF GRAVEL - MILLER CONST. INC. PIT-WINDSOR, VT.
B DAVIS BURKE PIT - PERKINSVILLE, VT.
SUBBASE OF SAND & SAND COVER - MCALLISTER SAND PIT - ASCUTNEY, VT.
SUBBASE OF CRUSHED ROCK - PERINI CRUSHER & QUARRY - SPRINGFIELD, VT.
GRAVEL BACKFILL - MILLER CONST. INC. PIT-WINDSOR, VT.
B MURRAY PIT - ANSDEN, VT.
ASPHALT - HUMBLE OIL CO. - EVERETT, MASS.
BITUMINOUS CONCRETE FMT - GOLD RIVER HOT MIX - NC. WALPOLE, N.H.
CONCRETE CLASS AA & B - CHARLESTOWN READY MIX, INC. - CHARLESTOWN, N.H.
REINFORCING STEEL - BETHLEHEM STEEL CO., INC. - BOSTON, MASS. & ALBANY, N.Y.
STRUCTURAL STEEL - VERMONT STRUCTURAL STEEL CORP. - BURLINGTON, VT.
ASPHALTIC ASBESTOS COATING - A.H. HARRIS & SONS, INC. - HYDE PARK, MASS.

REINFORCED CONCRETE PIPE - HUME PIPE CO. OF NEW ENGLAND - WINDSOR, VT.
METAL PIPE CULVERTS - NEW ENGLAND METAL CULVERT CO. - WHITE RIVER JUNCTION, VT.
PRECAST REIN. CONC. CURB DROP INLET W/C I.G. GRATE & FRAME - HUME PIPE CO. OF NEW ENGLAND, INC. - SWAMPSCOTT, MASS.
CAST IRON GRATES - WORCESTER FOUNDRY CO. - WORCESTER, MASS.
GUARD RAIL & PROPERTY LINE FENCE W/ STEEL POSTS - S.T. GRISWOLD & CO., INC. - WILLISTON, VT.
GRANITE BRIDGE CURB - E.L. SMITH QUARRY, DIV. ROCK OF AGES CORP. - BARRE, VT.
STEEL RAILING - S & B STEEL ERECTORS - ALBANY, N.Y.
PAINT - FLETCHERS MANUFACTURING CO. - MILFORD, N.H. & M & M PAINT MFG. CO. - PAWTUCKET, R.I.
CONTRACTOR - SAYE & MINGOLLA CONSTR. CO., INC. - MILLBURY, MASS.
CHIEF RESIDENT ENGINEER - BERNARD C. FOSTER.
RESIDENT ENGINEER - RICHARD S. NAUPT.
INSPECTOR - RALPH L. MICHAEL.
RECORD PLANS - A. J. SPIDLE.

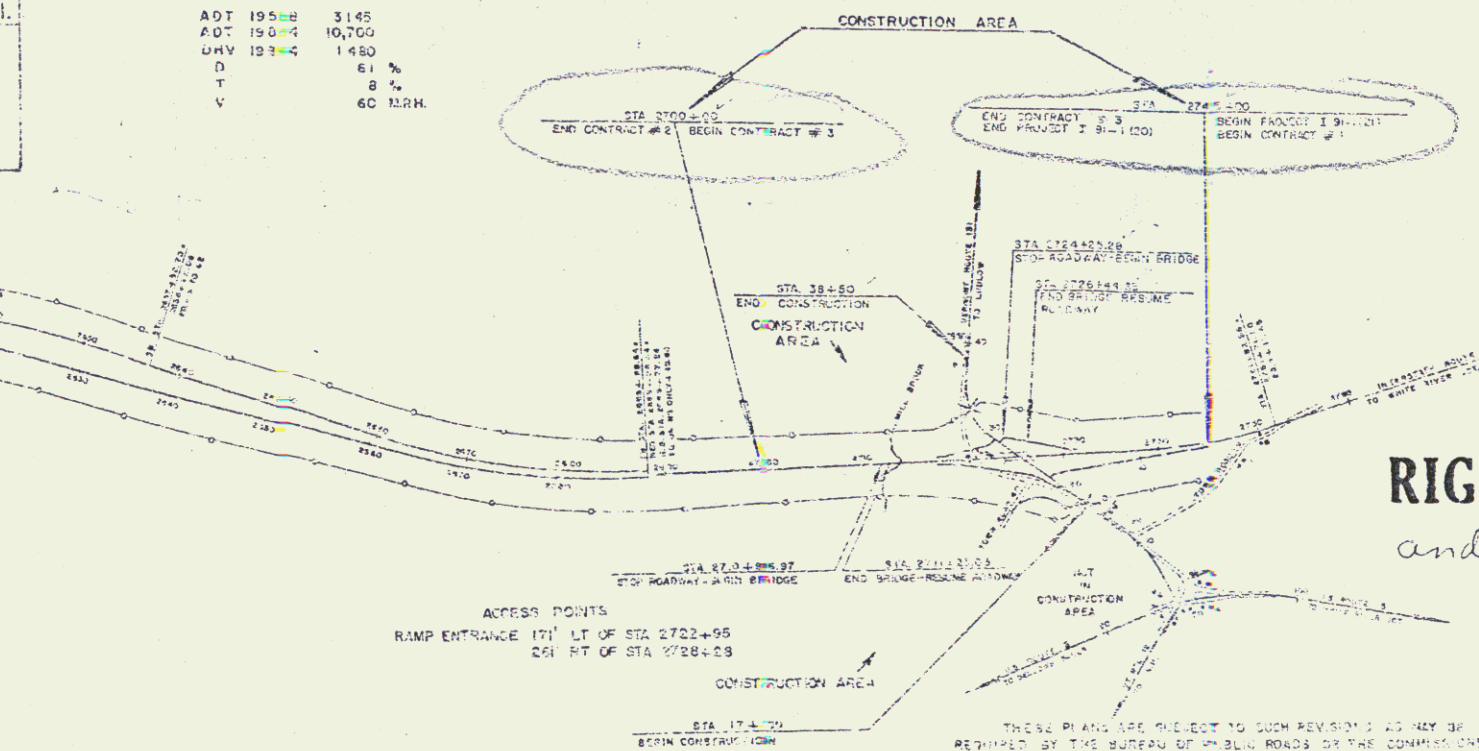
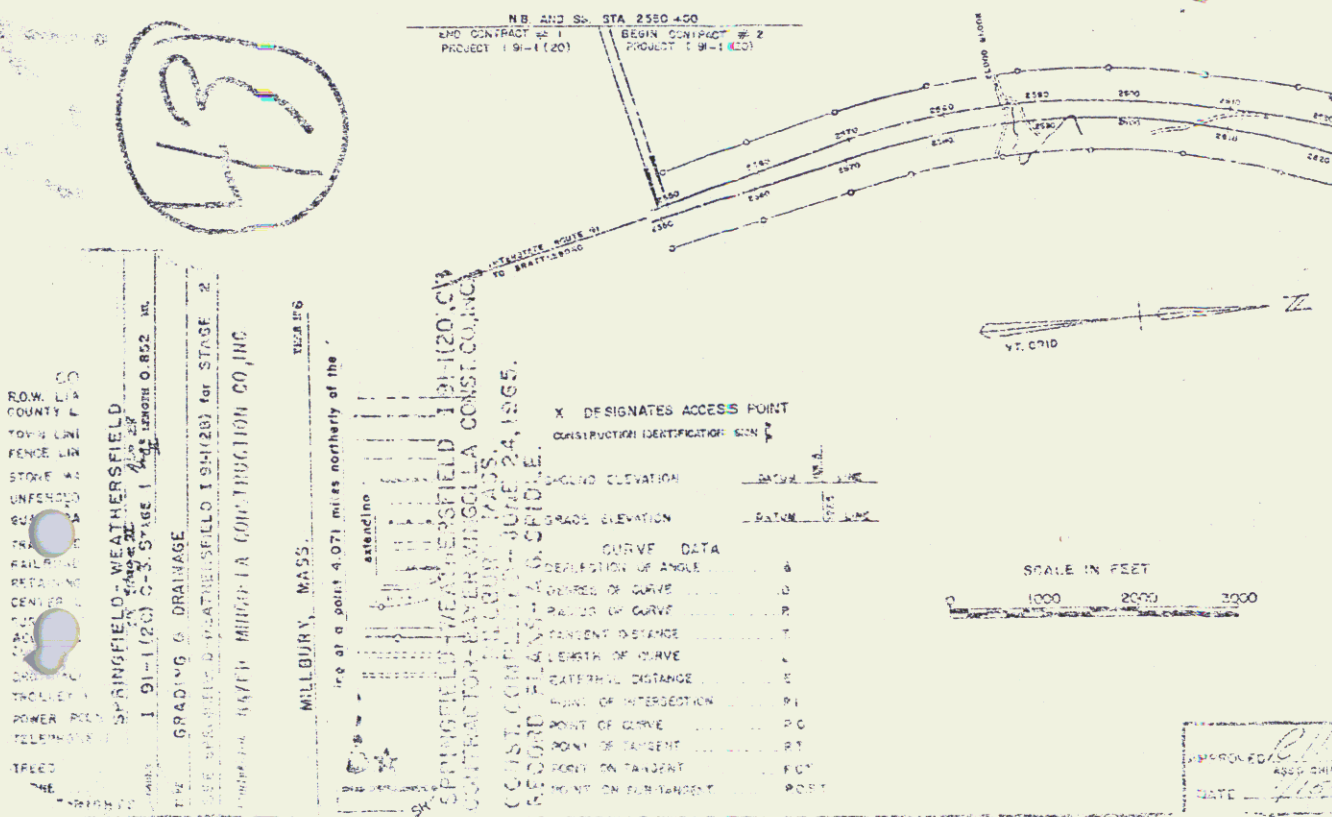

POOR ORIGINAL COPY

RIGHT-OF-WAY
and Construction Plans

THESE PLANS ARE SUBJECT TO SUCH REVISIONS AS MAY BE
REQUIRED BY THE BUREAU OF PUBLIC ROADS OR THE COMMISSIONER OF
HIGHWAYS.
CONSTRUCTION IS TO BE PERFORMED IN ACCORDANCE WITH
THE PLANS AND THE QUANTITIES SPECIFIED THEREON AND SHALL
CONFORM TO THE REQUIREMENTS OF THE STATE HIGHWAY DEPARTMENT
FOR THE ROAD AND BRIDGE. THE CONTRACTOR SHALL BE RESPONSIBLE FOR
OBTAINING ALL NECESSARY PERMITS AND SPECIAL
EXEMPTIONS AS REQUIRED BY THE STATE.

STAGE I CONSTRUCTION
CONTRACT 3

DEPARTMENT OF CONGRESS
BUREAU OF PUBLIC ROADS

Project I - 91-1(20)
Contract 3
Sheet 1 of 124 Sheets

APPROVED: [Signature] DATE: 3/20/64
DESIGNED: [Signature] DATE: 3/20/64
CHECKED: [Signature] DATE: 3/20/64
DRAWN: [Signature] DATE: 3/20/64
SCALE: 1" = 100'