

NOTE: FOR SIDE LINE DETAILS, REFER TO SHEETS OF

1960 Surv
N.B.P.I. 2011 + 31.72
2011 + 44.85

1960 Surv
S.B.P.I. 2011 + 33.69
2011 + 33.70

PARCEL 188E

SB 201+00.75
STOP ROADWAY
BEGIN BRIDGE

PARCEL 188A

2011

2011

2012

2013

2014

2015

2016

2017

2018

2019

2020

2021

2022

2023

2024

CIRCULAR CURVE DATA

N.B.

15° 53' 15" 21" Δ 13° 04' 45" 21"

D 1" 30"

R 3819.72'

L 1059.17'

E 37.00'

Bank 7/16" per foot

File Overlay - to be removed by engineer & surveyor

S.B.

2010 + 31

1870' V.C.

539.70

N.B.

2019 + 62

1800' V.C.

550.28

2011

2012

2013

2014

2015

2016

2017

2018

2019

2020

2021

2022

2023

2024

THREE CABLE GUARD RAIL *
w/ STEEL POSTS

SB 2010 + 50 - 2017 + 10.4
NS 2011 + 00 - 2018 + 50' 21"

DEMOLITION & REMOVAL OF BUILDING
2012 25 41

SITUATING CONCRETE CULVERT
2010 00 N.B. M.A.

PROPERTY LINE FENCE

2011 + 00 - 2012 + 85 N.B. 91' V

2013 + 20 - 2016 + 79 N.B. 81' V

2011 + 30 - 2018 + 50 55' Lt (Note: See Special Provisions)

INSTALL SLEEVE FOR WATER PIPE
Items 103' ACROSS ROADWAY
Sta 2016 + 52.28

DRILLING & BLASTING OF SOLID ROCK
SUBGRADE

S.B.

2016 + 00 - 2019 + 00

N.B.

* Stage 2 Construction

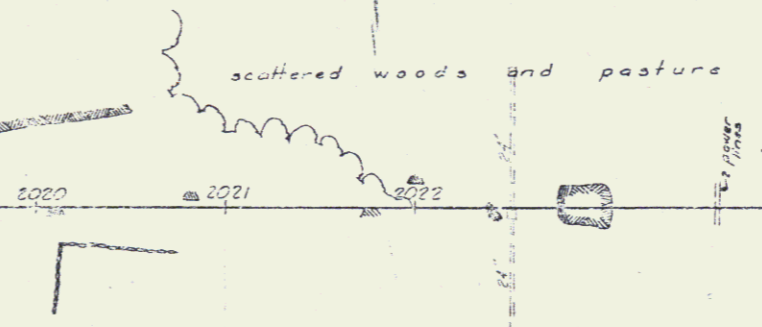
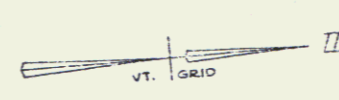

PARCEL 181A
STATIONS 2019+00 NB-2175+93 NB
TAKING 22 422 LA.

Project I 91-1
2018 + 50

WATSON

Town Road 22 is to be built in its entirety during Stage 1 Construction.

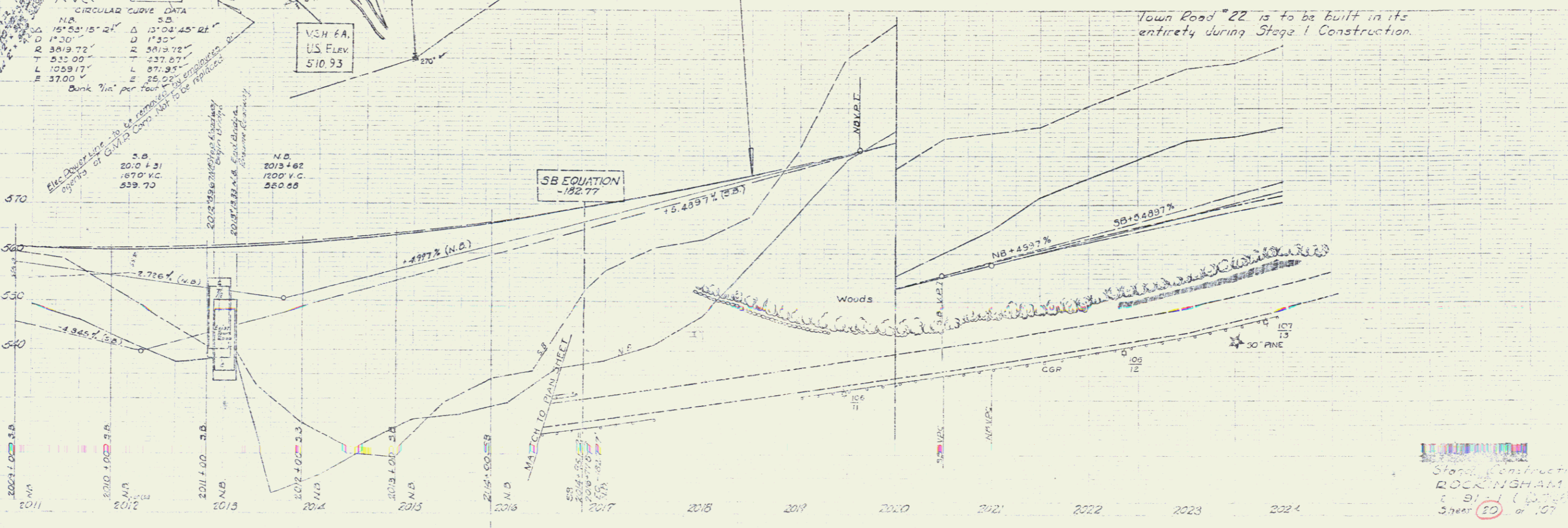

Stage 1 Construction
ROCKINGHAM
Sheet 10 of 107