

\* Paved Median Gutter  
Item No. 361-B  
1404+00 TO 1404+25  
1409+00 TO 1409+25  
1413+50 TO 1414+25  
3+25

\* Three Cable Guard Rail with Steel Posts, Item 543  
1402+00 TO 1402+70 RT  
347' 1404+04 TO 1403+45 LT  
341' 1413+20 TO 1413+70 LT  
274' 1413+26 TO 1413+74 RT  
25

Property Line Fence with Steel Posts  
Item No. 583-B  
1402+00' to 1411+00 LT  
1402+00' to 1403+00 RT  
25

SUB-BASE OF SAND  
1402+00 TO 1403+50 LT

Construct Special Ditch  
Item No. 103-A  
1409+00 to 1410+00 Lt.  
1410+00 to 1413+50 Rt.  
1413+50 to 1414+25

\* STAGE II CONSTRUCTION ITEMS  
GRAVEL BACKFILL, ITEM 222 MOD.  
1402+00 TO 1403+50 LT  
1413+50 to 1414+25

POST	STATE	FED AID PROJECT NO.	FISCAL YEAR	SHEET NO.	TOTAL SHEETS
1	VT	I-91	(23)		

Muck Excavation  
1411+50 - 1417+50

PARCEL: 77 A, B, C, D  
GRANTOR: NEW ENGLAND KURN HATTIN HOMES INC.  
STATIONS: 1398+41 - 1420+14  
TAKING: 13.4 A2 L.A.  
REMAINDER: 468.7 A2

DRAINAGE - STA 1404+00, 1409+00, 1413+50 RT  
1421+50, 1421+75, 1423+00 RT

TITLE TAKEN: COND 9/5/6  
RECORDED: WESTMINSTER-BK 50-PG 82-131 9/7/61

PARCEL: 77 A  
STATIONS: 1398+41 - 1420+14  
TAKING: 13.4 A2 L.A.

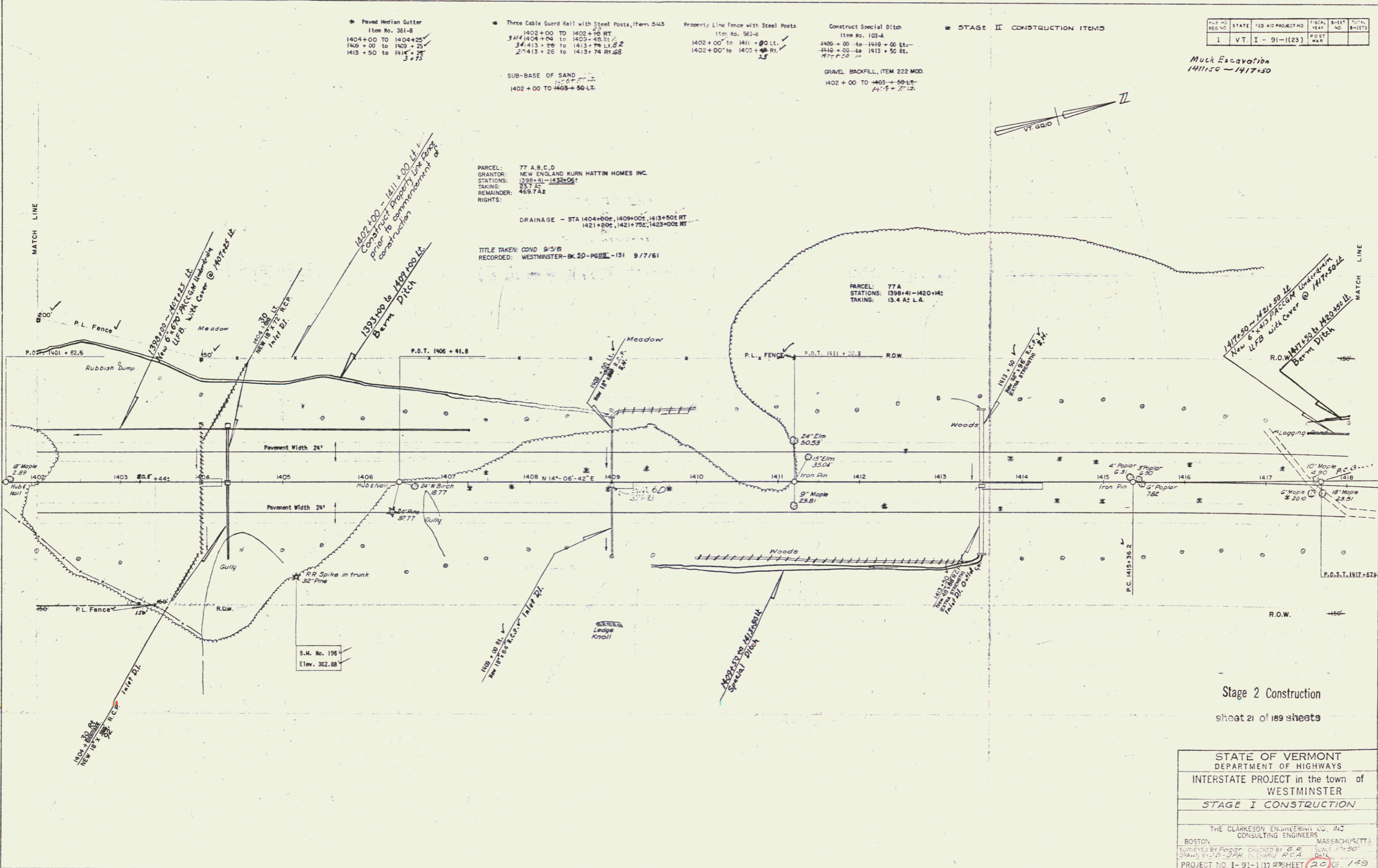

Stage 2 Construction  
sheet 21 of 189 sheets

STATE OF VERMONT  
DEPARTMENT OF HIGHWAYS  
INTERSTATE PROJECT in the town of  
WESTMINSTER  
STAGE I CONSTRUCTION

THE CLARKSON ENGINEERING CO., INC.  
CONSULTING ENGINEERS  
BOSTON MASSACHUSETTS

SURVEYED BY: [Signature] CHECKED BY: [Signature] SCALE: 1"=50'  
DRAWN BY: [Signature] PL. CHARGE: R.C.A. DATE: [Date]

PROJECT NO. I-91-1(17) SHEET 20 OF 149  
CONTRACT NO. 1