

Demolition and Removal of Building
 Item No. 586
 1378 + 15 to 1382 + 00
 1383 + 00 to 1385 + 00
 1385 + 15 to 1388 + 00

Construct U-Turn
 Item No. 190
 REFER TO R'WAY STD. B-17
 1370+00 TO 1371+00 RT.

CONSTRUCT SPECIAL DITCH
 ITEM # 101-A
 1370+00 TO 1371+00 RT.

Paved Median Gutter
 Item No. 361-B
 1374 + 25 TO 1374 + 50
 1374 + 75 TO 1375 + 00
 1382 + 25 TO 1382 + 50
 1385 + 33 TO 1385 + 83
 1385 + 15 TO 1387 + 15

Property Line Fence with Steel Posts
 Item No. 583-B
 1370 + 00 to 1386 + 00 Lt.
 1370 + 00 to 1386 + 00 Rt.
 1385 + 58 to 1387 + 90 Lt.

Three Cable Guard Rail with Steel Posts, Item 543
 1370 + 00 to 1372 + 50 Rt.
 1378 + 25 to 1385 + 86 Rt.

Bituminous Concrete Curb
 Item No. 555
 1379 + 00 to 1382 + 50 Rt.

STAGE II
 CONSTRUCTION ITEMS

PUB. NO.	STATE	FED. AID PROJECT NO.	FISCAL YEAR	SHEET NO.	TOTAL SHEETS
1	VT.	I-91-1117	1981	1	1

Gravel Backfill
 Item No. 222 MOD.
 1380 + 00 to 1386 + 00 Lt.
 1382 + 00 to 1386 + 00 Lt.
 1381 + 60 to 1381 + 60 Lt.

SUB-BASE OF SAND
 Item No. 202
 1380 + 00 to 1386 + 00 Lt.
 1382 + 00 to 1386 + 00 Rt.

Plank Guard Rail with Heavy Posts
 Item No. 58
 1378 + 75 Lt.

Bituminous Grouted Stone Gutter
 Item No. 553
 1380 + 10 RT.
 1380 + 50 RT.
 1385 + 58 to 1387 + 90 Lt.

Planting Trees Shrubs and Vines
 Item 651
 1373 + 00 to 1375 + 50 Lt. (14)
 American Crabapple (Viburnum Trilobum)

S.A. #4 Curve Data
 $\Delta = 10^\circ - 31' Lt.$
 $D = 64'$
 $R = 1432.7'$
 $T = 132.3'$
 $L = 263.8'$
 $E = 6.1'$
 Bank = 3/4' per ft.

PARCEL: 73
 GRANTOR: GEORGE C. & FANNY E. WOODBURN
 STATIONS: 1365+28 - 1379+90 L.
 TAKING: 5.6 AC L.A.
 REMAINDER: NONE
 RIGHTS: NONE
 TITLE TAKEN: WD 5/10/60
 RECORDED: WESTMINSTER-BK. 50-PG. 23 - 5/16/60

PARCEL: 75
 GRANTOR: ERNEST V. & ALICE C. HOLMES
 STATIONS: 1378-97 - 1390+70 L.
 TAKING: 5.8 AC L.A.
 REMAINDER: 2.2 AC
 RIGHTS: NONE
 TITLE TAKEN: COND 5/25/60
 RECORDED: WESTMINSTER-BK. 48-PG. 343-59 - 5/25/60

POOR ORIGINAL COPY

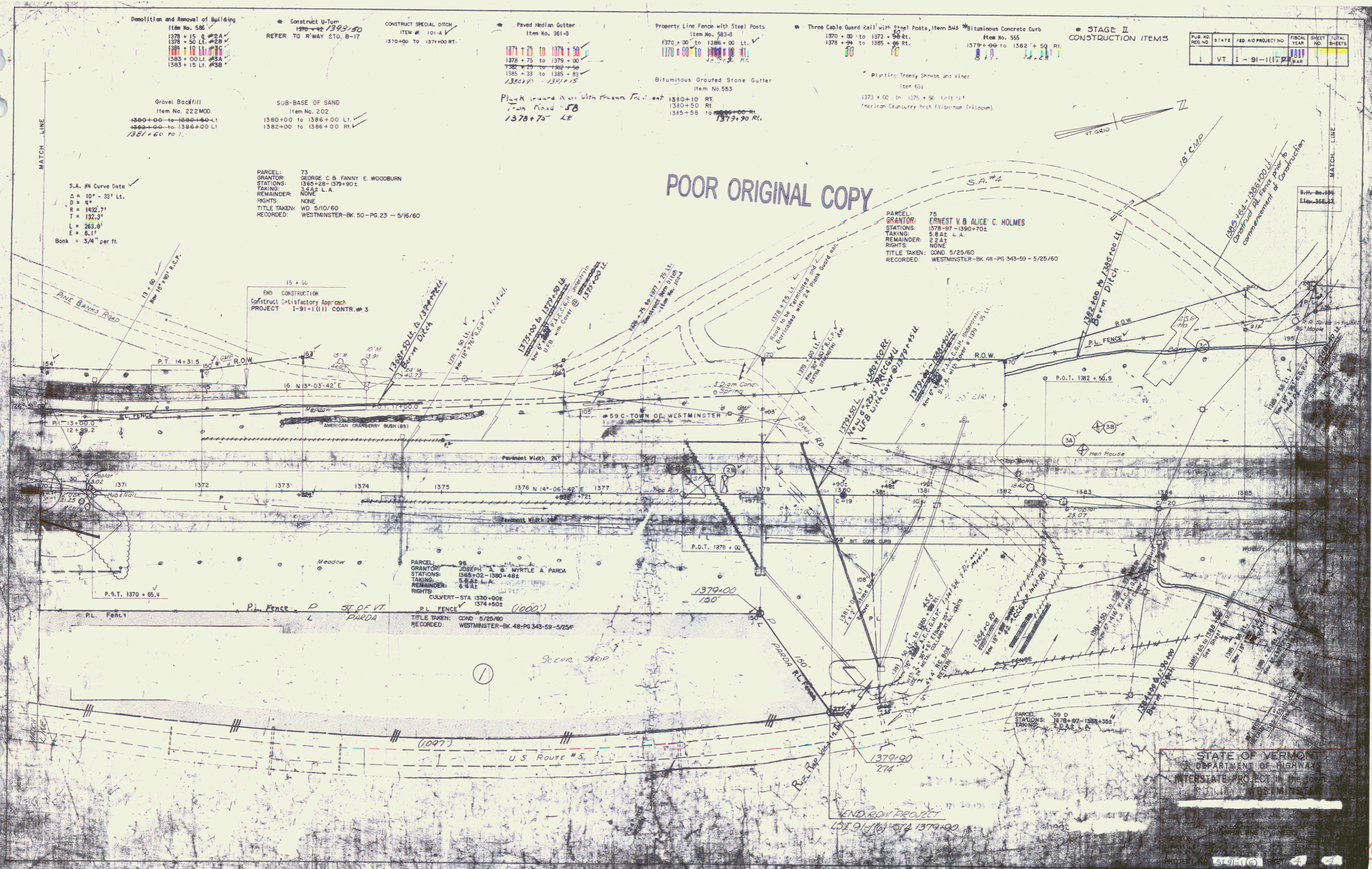

STATE OF VERMONT
 DEPARTMENT OF HIGHWAY
 INTERSTATE PROJECT IN THE TOWN OF WESTMINSTER

END ROW PROJECT
 1019-116 STA 1379+00

4