

Three Cable Guard Rail with steel Posts
 U.S. Route #5 (Reloc.) 3400 TR 25 to 236 + 24 Rt.
 U.S. Route #5 (Reloc.) 225 + 75 to 230 + 71 Lt.
 1210 + 00 to 1210 + 71 Rt.

Property Line Fence with Steel Posts
 Item No. 541 - A
 U.S. Route #5 (Reloc.) 225 + 60 to 225 + 92 Ft.
 1210 + 00 to 1211 + 00 Lt.
 1210 + 00 to 1211 + 00 Rt.

Removal and Transfer of Precast Guard Rail
 Item No. 120
 U.S. Route #5 (Reloc.) 225 + 57 to 227 + 25 Lt.
 U.S. Route #5 (Reloc.) 225 + 17 Lt. to 226 + 57 Rt.

Pavement Section
 Item No. 120
 1210 + 00 to 1210 + 25

Concrete Slab on Grade
 Item No. 120
 U.S. Route #5 (Reloc.) 225 + 50 to 225 + 75 Rt.
 Town Road #25 3 + 00 to 4 + 00 Lt.

Concrete
 Item No. 120
 225 + 40 Rt.

1	2	3	4	5	6	7	8	9	10	11	12	13	14	15	16	17	18	19	20	21	22	23	24	25	26	27	28	29	30	31	32	33	34	35	36	37	38	39	40	41	42	43	44	45	46	47	48	49	50	51	52	53	54	55	56	57	58	59	60	61	62	63	64	65	66	67	68	69	70	71	72	73	74	75	76	77	78	79	80	81	82	83	84	85	86	87	88	89	90	91	92	93	94	95	96	97	98	99	100
---	---	---	---	---	---	---	---	---	----	----	----	----	----	----	----	----	----	----	----	----	----	----	----	----	----	----	----	----	----	----	----	----	----	----	----	----	----	----	----	----	----	----	----	----	----	----	----	----	----	----	----	----	----	----	----	----	----	----	----	----	----	----	----	----	----	----	----	----	----	----	----	----	----	----	----	----	----	----	----	----	----	----	----	----	----	----	----	----	----	----	----	----	----	----	----	----	----	----	-----

DEMOLITION AND REMOVAL OF BUILDING
 ITEM 366
 1212 + 40 LT. 1213 + 40 LT.
 1212 + 68 LT. 1214 + 60 RT.
 1213 + 25 LT. 1214 + 80 LT.
 NOTE: OWNER TO VACATE ON OR BEFORE
 NOV. 1, 1959 (STA. 1211 + 11 - 1216 + 22)

Plank Guard Rail with Preservative Treatment
 Item No. 541 - A
 U.S. Route #5 (Reloc.) 225 + 60 to 225 + 92 Ft.

Excavation & Removal of existing
 cement concrete pavement
 Item No. 120
 222 + 40 to 226 + 00 U.S.#5

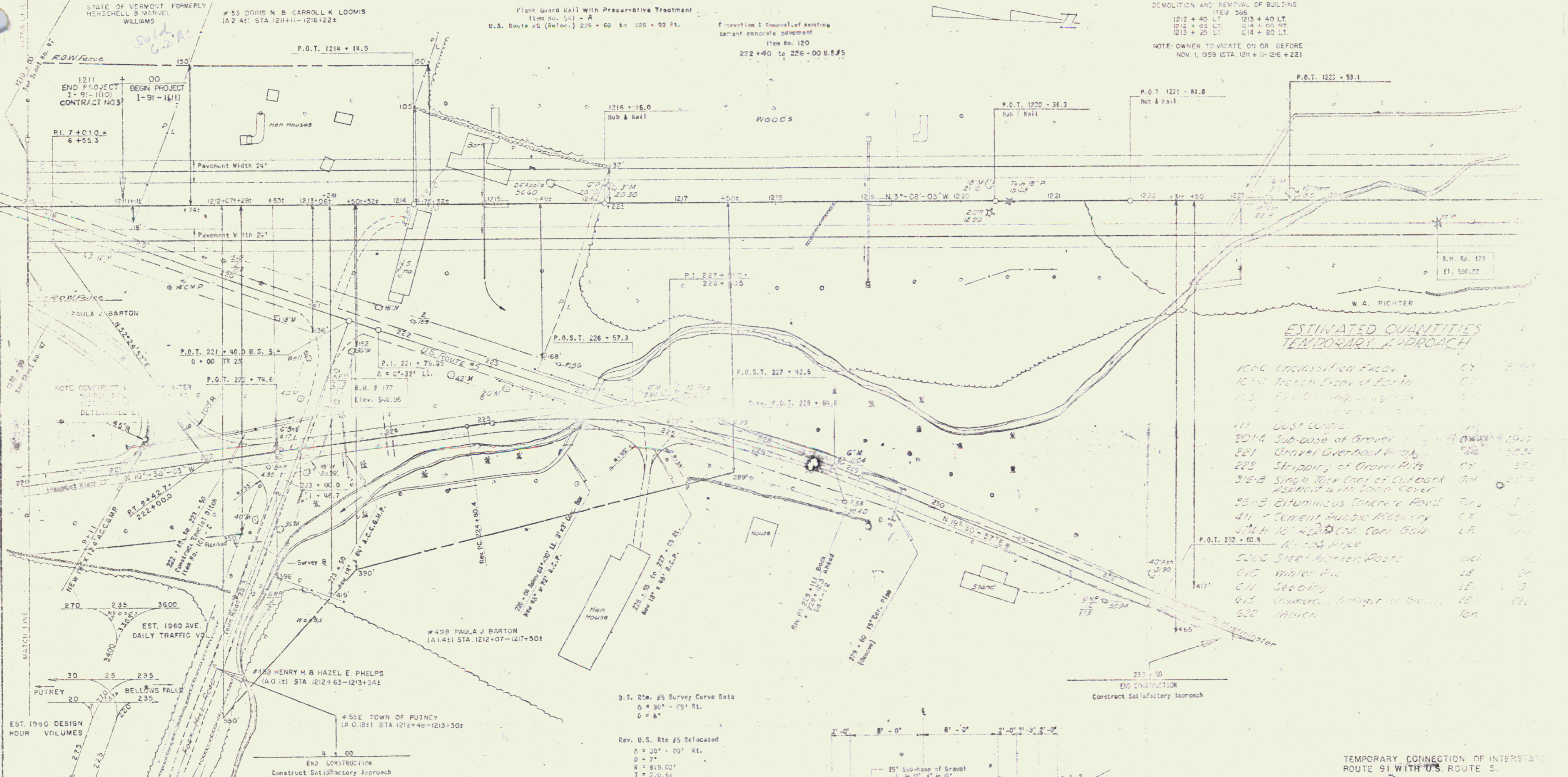

**ESTIMATED QUANTITIES
 TEMPORARY APPROACH**

101-C	Unclassified Excav.	CY	1917
103-B	Trench Excav. of Earth	CY	1917
105	Excavating, in grade	CY	1917
106	Excavating, in trench	CY	1917
111	Dust Control	TON	1917
201-A	Sub-base of Gravel	CY	1917
221	Gravel Overhaul	CY	1917
222	Stripping of Gravel Pits	CY	1917
316-B	Single Rock Coat of Cutback Asphalt with Sand Cover	TON	1917
361-B	Bituminous Concrete Pavement	TON	1917
411	Cement Rubble Masonry	CY	1917
414	18" High C&G. Corr. Galv. Metal Pipe	LF	1917
520	Steel Marker Posts	each	1917
610	Water Pipe	LF	1917
611	Seeding	LB	1917
615	Commercial Fertilizer for Grass	LB	1917
622	Manure	TON	1917

U.S. Rte. #5 Survey Curve Data
 $\Delta = 30^\circ - 09' \text{ Rt.}$
 $D = 7''$
 $R = 819.02'$
 $T = 220.51'$
 $L = 400.71'$
 $E = 29.19'$
 Back = $2'416''$ per foot

Rev. U.S. Rte #5 Relocated
 $\Delta = 30^\circ - 09' \text{ Rt.}$
 $D = 7''$
 $R = 819.02'$
 $T = 220.51'$
 $L = 400.71'$
 $E = 29.19'$
 Back = $2'416''$ per foot

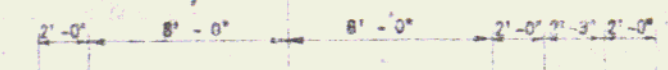

NORMAL SECTION
 TOWN ROAD NO. 25

TEMPORARY CONNECTION OF INTERSTATE
 ROUTE 91 WITH U.S. ROUTE 5.

STATE OF VERMONT
 DEPARTMENT OF HIGHWAYS
 INTERSTATE PROJECT IN THE STATE OF
 VERMONT
 PUTNEY

POOR ORIGINAL COPY