

- Ⓐ ACQUIRED FROM FLOYD D. & EUPHEMIA J. AUSTIN BY  
W.D. DATED 7/13/59 - RECORDED 7/17/59 IN BK.35 PG.359
- Ⓑ ACQUIRED FROM HERSCHELL & MORVEL WILLIAMS BY  
W.D. DATED 4/4/57 - RECORDED 4/18/57 IN BK.34 PG.92-3-4
- Ⓒ ACQUIRED FROM DORIS N. & CARROLL K. LOOMIS SR. BY  
COND. 7/3/59 - RECORDED 7/10/59 IN BK. 35 PG. 272

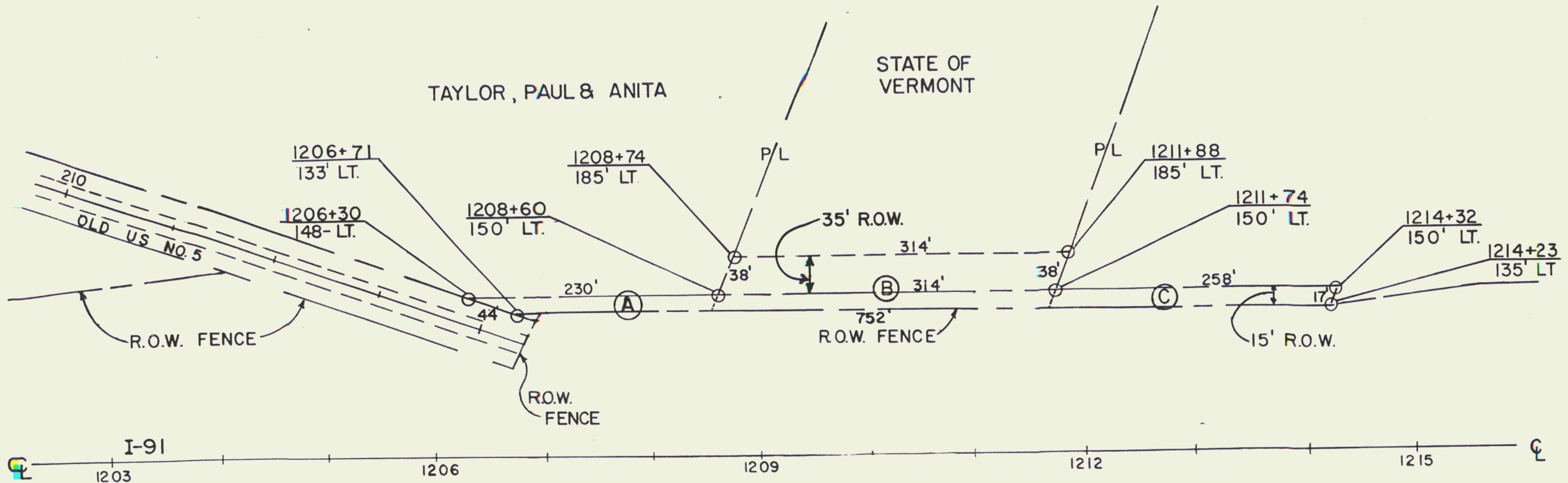

*15' Row + 35' Row conveyed to Donald E. and Linda G. Woodworth  
by QCD dated 5/10/78 Bk 54 Pg 207-210*

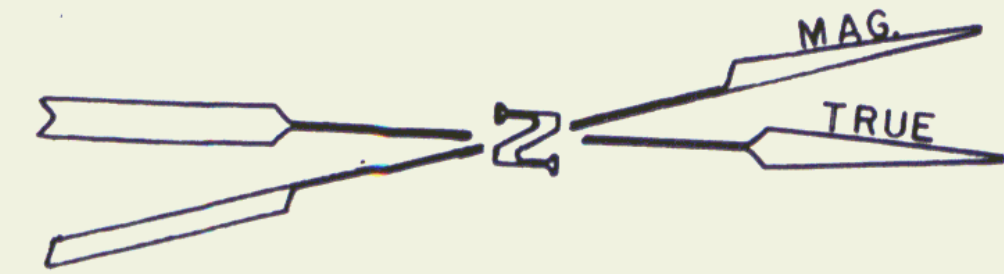
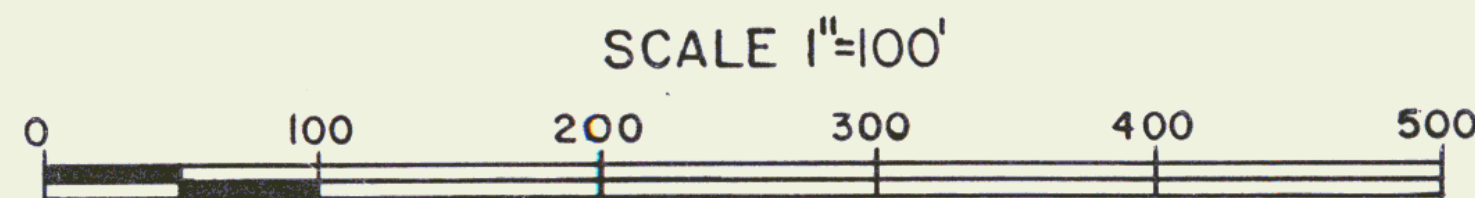

REF: CONT. NO. 3 SHEET 47 & 49 OF 328	
<b>STATE OF VERMONT AGENCY OF TRANSPORTATION</b>	
<b>TOWN OF PUTNEY</b>	
PROJECT	I 91-1 (10) <span style="float: right; border: 1px solid red; border-radius: 50%; padding: 2px;">47B</span>
APPROX. SCALE 1"=100'	DATE 4/27/78 DRAWN BY E. MALNATI JR.