

Paved Median gutter
 1166 + 00 to 1166 + 25
 1171 + 00 to 1171 + 25
 1176 + 00 to 1177 + 50
 1180 + 50 to 1181 + 00

#45B DONALD W. B. MADELINE B. HARLOW
 (43700 SOFT) STA 1166+43-1168+00±
 W.D. 10/28/59
 REC.: PUTNEY BK. 35 - PG. 447 - 10/31/59

Summary Landscape Material
 Contract No. 3

I. Trees	
A. Deciduous	
1. Betula Papyrifera - Paper Birch	3
2. Crataegus Crusgallii - Crataegus Northern	8
II. Vines	
1. Vinca Minor - Periwinkle	1,950
III. General Notes	
A. Size of Planting Material	
1. Evergreen trees should be 2-3 feet in height.	
2. Evergreen shrubs should be 12" in diameter (measurement is average spread of branches), 6-12" in height and 2.5" (1/4") minimum caliper.	
3. Large deciduous trees should be 3/4" to 1 inch in caliper with a minimum height of 6 to 8 feet.	
4. Small deciduous trees should be 1 1/16 inch in caliper, 5 to 6 feet in height with 6 or more branches.	
5. Deciduous shrubs should be 2 to 3 feet in height, with not less than 4 canes, 2 feet and up.	
6. All conifers must have dormant buds and secondary needles.	
B. All plant material to be graded according to American Standards for Nursery Stock.	

Bituminous Grouted Stone Gutter
 1180+50 Rt
 1172+50 Lt
 1176+00 Lt

Property Line Fence With Steel Posts
 Item No. 563 B
 1165 + 00 to 1181 + 00 Lt.
 1165 + 00 to 1181 + 00 Rt.

Three Cable Guard Rail With Steel Posts
 1168 + 00 to 1181 + 32 Lt.
 1169 + 00 to 1172 + 00 Lt.
 65 06

Granite Slope Edging
 1165+00 to 1169+43 Lt.
 (Weighing Station)

STATE OF VERMONT
 DEPARTMENT OF HIGHWAYS
 INTERSTATE PROJECT in the town of
 PUTNEY
 1 VT 91-1(10) POST WAR 44 328

CURVE DATA
 Δ = 56° - 35' - 30" Lt.
 D = 270
 R = 2664.9
 T = 1362.8
 L = 2829.6
 E = 388.5
 Bank = 11/16" per foot

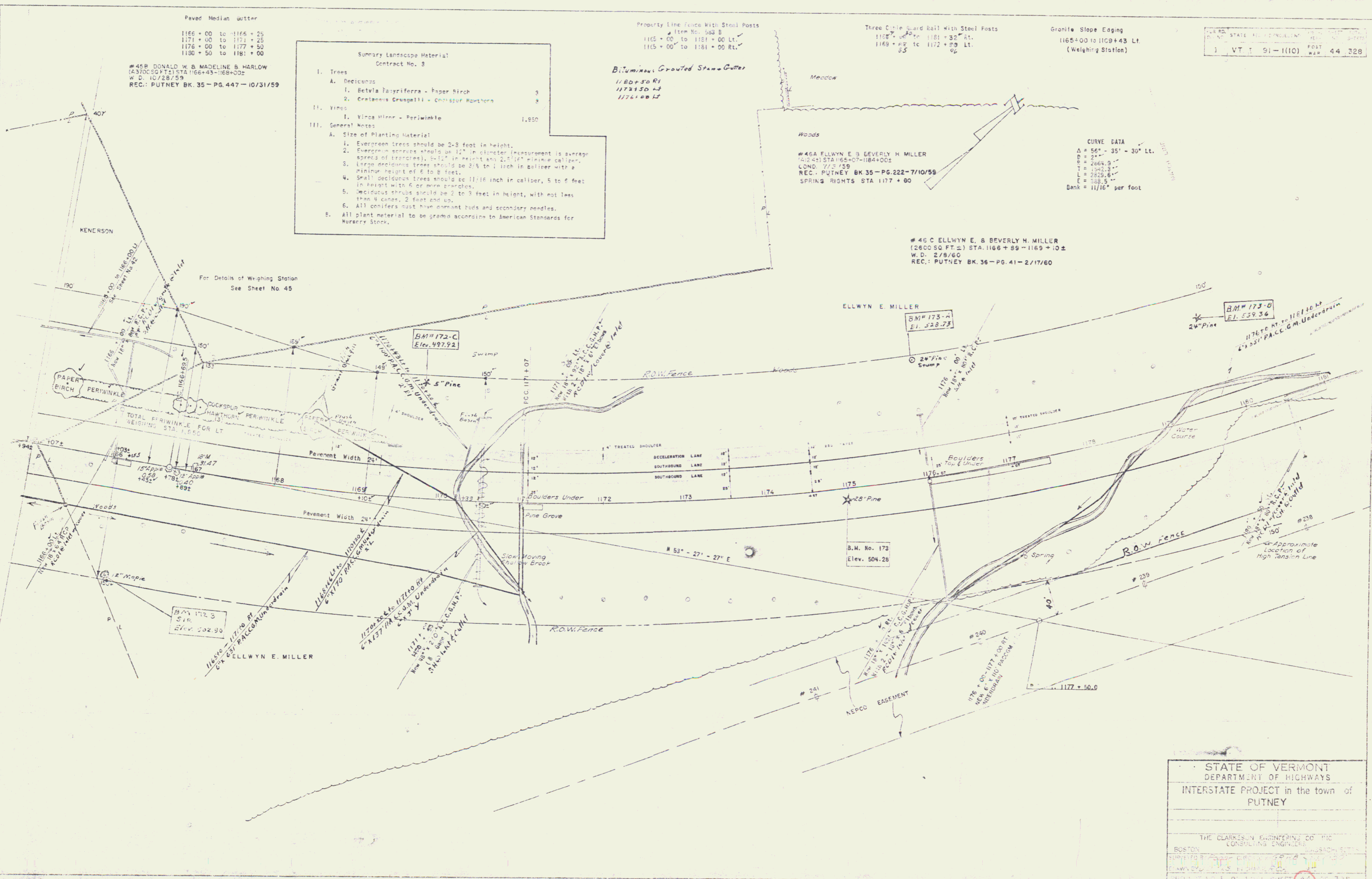

#46C ELLWYN E. B. BEVERLY H. MILLER
 (2600 SQ. FT. ±) STA. 1166+89 - 1169+10±
 W.D. 2/9/60
 REC.: PUTNEY BK. 36 - PG. 41 - 2/17/60

B.M. # 173-A
 Elev. 528.73

B.M. # 173-0
 Elev. 539.36

B.M. No. 173
 Elev. 504.28

B.M. # 172-B
 Elev. 502.90

#46A ELLWYN E. B. BEVERLY H. MILLER
 (2600 SQ. FT. ±) STA. 1166+89 - 1169+10±
 W.D. 2/9/60
 REC.: PUTNEY BK. 36 - PG. 41 - 2/17/60

#47A ELLWYN E. B. BEVERLY H. MILLER
 (2600 SQ. FT. ±) STA. 1170+00 - 1173+00±
 W.D. 2/9/60
 REC.: PUTNEY BK. 36 - PG. 41 - 2/17/60

B.M. # 172-C
 Elev. 497.92

STATE OF VERMONT
 DEPARTMENT OF HIGHWAYS
 INTERSTATE PROJECT in the town of
 PUTNEY

THE CLARKSON ENGINEERING CO. INC.
 CONSULTING ENGINEERS
 BOSTON MASSACHUSETTS

DESIGNED BY: [Signature]
 DRAWN BY: [Signature]
 CHECKED BY: [Signature]
 APPROVED BY: [Signature]

1176 + 00 - 1177 + 00 RT.
 1176 + 00 - 1177 + 00 LT.
 1177 + 50.0

CONTRACT NO. 3