

Drilling & Blasting of Solid Rock Subgrade
 Item No. 114
 1153+00 to 1157+50

Paved Median Gutter
 1149+00 to 1151+65
 1154+00 to 1155+15
 1157+50 to 1159+25

Property Line Fence With Steel Posts
 Item No. 103
 1149+00' to 1160+00' Lt.
 1149+00' to 1160+00' Rt.
 59+66

Construct Special Ditch
 Item No. 103A
 1153+00 to 1153+00 Rt.
 1157+25 to 1159+00 Lt.
 1152+30 to 1159+00 Lt.
 1149+00 Lt.
 1153+00 to 1154+50 Lt.

Construct Special Ditch
 Item No. 103B
 1153+40 to 1158+00 Rt.
 1158+00 to 1160+00 Lt.
 1159+00 to 1159+25 Lt.
 1152+30 to 1158+50 Rt.

STATE PROJECT NO. 1
 VT 1 91-1(10)
 CONTRACT NO. 2

#45A DONALD W B MADELINE B. HARLOW
 (A143) STA 1152+66-1159+00
 W D 10/28/59
 REC: PUTNEY BK. 35 - PG. 447 - 10/31/59

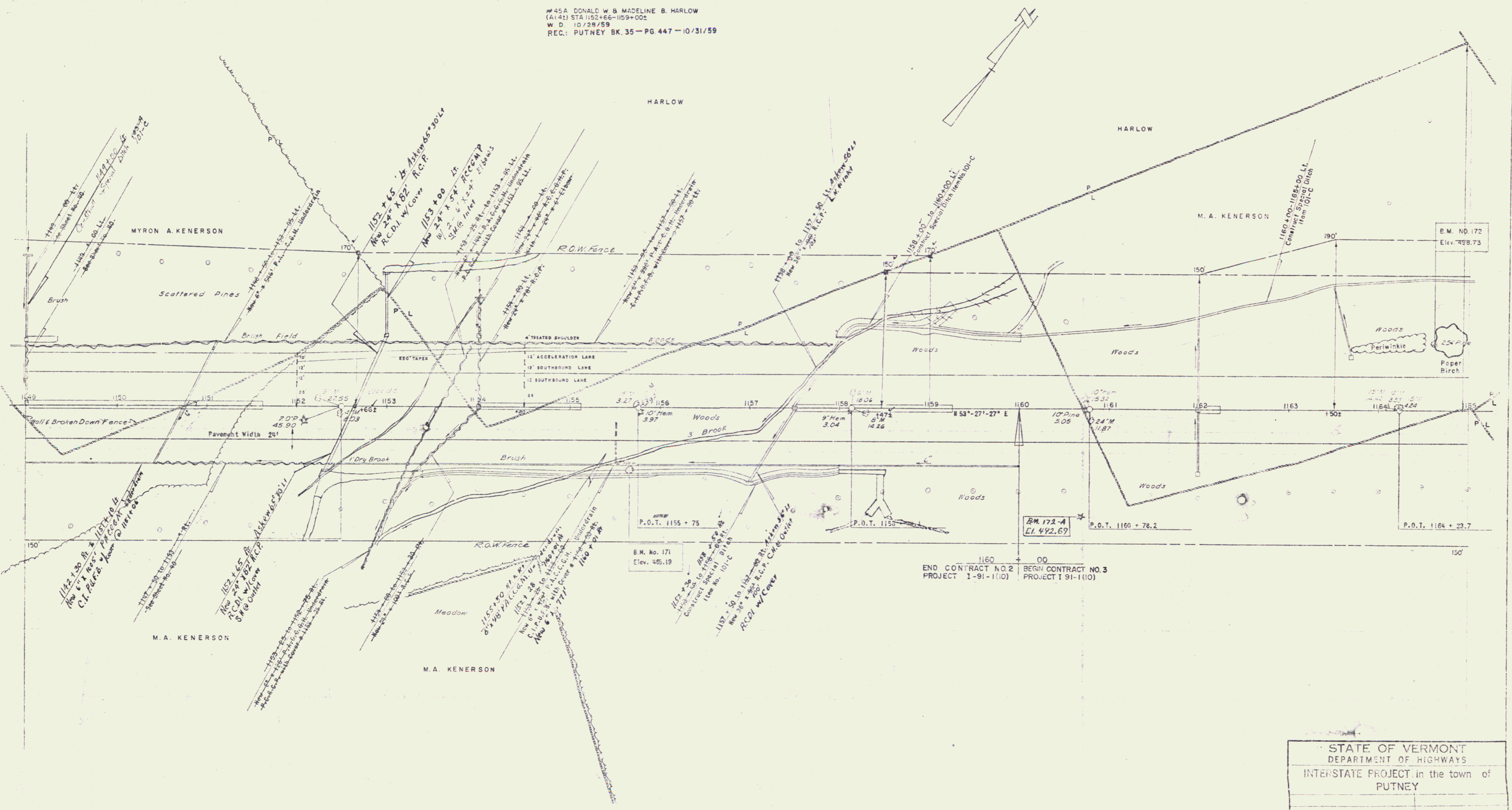

STATE OF VERMONT
 DEPARTMENT OF HIGHWAYS
 INTERSTATE PROJECT in the town of
 PUTNEY

THE CLARKESON ENGINEERING CO. INC.
 CONSULTING ENGINEERS
 BOSTON MASSACHUSETTS

PROJECT NO. 1-91-1(10) SHEET 42 OF 44
 CONTRACT NO. 2