

FISCAL YEAR	SHEET NO.	TOTAL SHEETS
1991	38	328

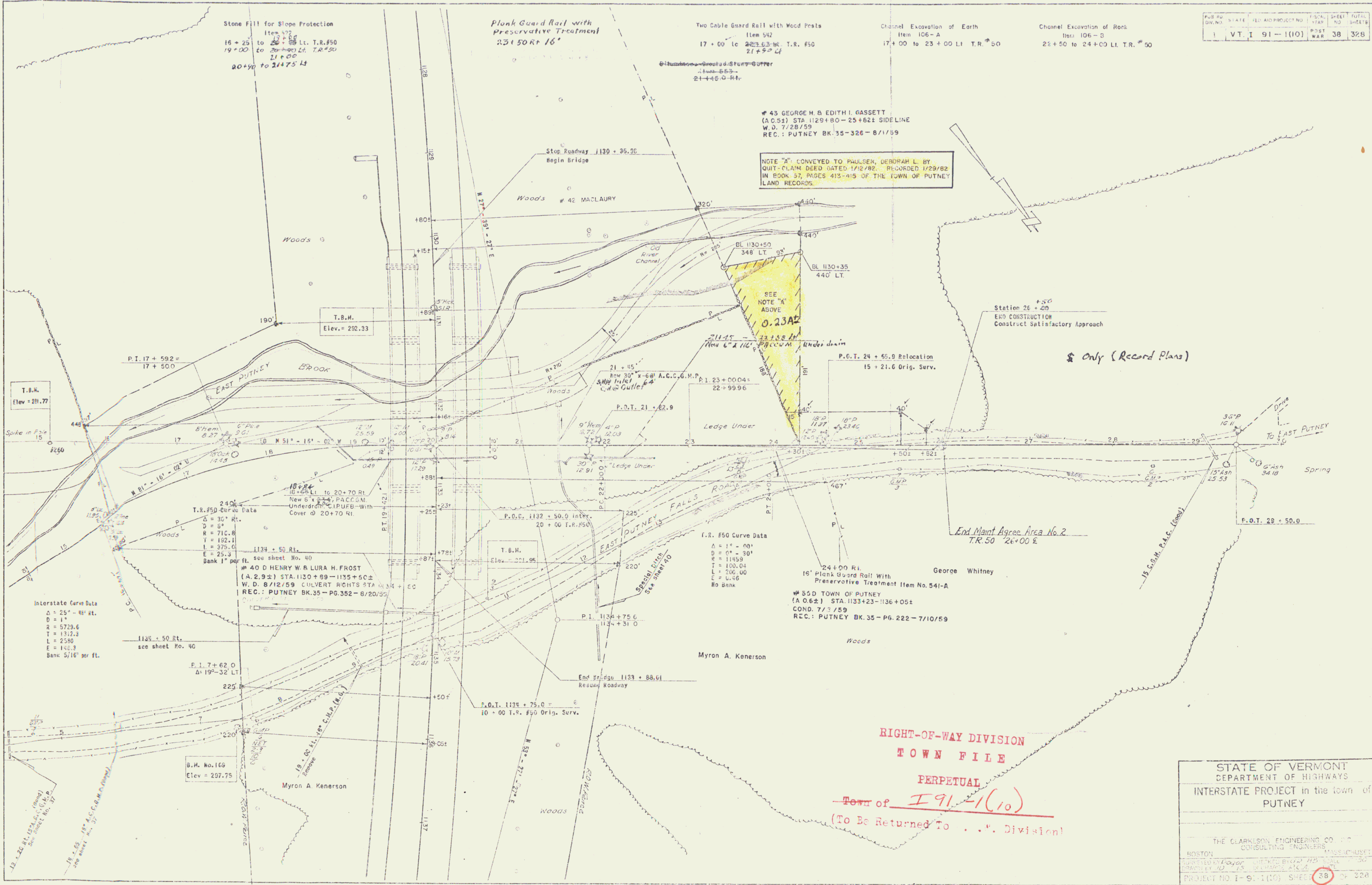

43 GEORGE H. & EDITH I. GASSETT
 (A.C.S.) STA. 1129+80 - 25+82± SIDELINE
 W.D. 7/28/59
 REC.: PUTNEY BK. 35-326-8/1/59

NOTE "A" CONVEYED TO PAULSEN, DEBORAH L. BY
 QUIT-CLAIM DEED DATED 1/12/82. RECORDED 1/29/82
 IN BOOK 57, PAGES 413-415 OF THE TOWN OF PUTNEY
 LAND RECORDS.

Station 26 + 50
 ERD CONSTRUCTION
 Construct Satisfactory Approach

\$ Only (Record Plans)

End Maint Agree Area No. 2
 T.R. 50 26+00 E

George Whitney
 24+00 Rt.
 16' Plank Guard Rail With
 Preservative Treatment Item No. 541-A

50 D TOWN OF PUTNEY
 (A. 0.6±) STA. 1133+23 - 1136+05±
 COND. 7/3/59
 REC.: PUTNEY BK. 35 - PG. 222 - 7/10/59

Myron A. Kenerson

RIGHT-OF-WAY DIVISION
 TOWN FILE
 PERPETUAL
 Town of I 91-1(10)
 (To Be Returned To . . . Division)

STATE OF VERMONT
 DEPARTMENT OF HIGHWAYS
 INTERSTATE PROJECT in the town of
 PUTNEY

THE CLARKSON ENGINEERING CO., INC.
 CONSULTING ENGINEERS
 BOSTON MASSACHUSETTS

DESIGNED BY: [Name] CHECKED BY: [Name] DATE: [Date]
 DRAWN BY: [Name] IN CHARGE: [Name] DATE: [Date]

PROJECT NO. I-91-1(10) SHEET 38 OF 328
 CONTRACT NO. 2.

T.B.M.
 Elev = 281.77

T.B.M.
 Elev. = 292.33

T.B.M.
 Elev. = 321.95

B.M. No. 169
 Elev = 297.75

Interstate Curve Data
 $\Delta = 25^\circ - 02' 21''$
 $D = 1'$
 $R = 5729.6$
 $T = 1312.3$
 $L = 2580$
 $E = 140.3$
 Bank 5/16' per ft.

T.R. #50 Curve Data
 $\Delta = 30^\circ$ Rt.
 $D = 8'$
 $R = 710.8$
 $T = 192.1$
 $L = 375.6$
 $E = 25.3$
 Bank 1' per ft. see sheet No. 40

T.R. #50 Curve Data
 $\Delta = 1^\circ - 00'$
 $D = 0' - 30''$
 $R = 11459$
 $T = 100.04$
 $L = 200.00$
 $E = 0.46$
 No Bank